



Victoria Government Gazette

No. S 252 Wednesday 30 May 2018
By Authority of Victorian Government Printer

SAFE DRINKING WATER REGULATIONS 2015

Specification of Areas to be Water Sampling Localities

I, Suzie Sarkis, delegate of the Secretary to the Department of Health and Human Services, under regulation 6 of the Safe Drinking Water Regulations 2015, vary the specifications published in Government Gazettes S 6 on 16 January 2007, which specified areas supplied with drinking water by Westernport Water to be water sampling localities for the purpose of the Safe Drinking Water Regulations 2005, as follows:

- in respect of the specifications published in Government Gazette S 6:
 - for the water sampling localities named Cape Woolamai, Rhyll, San Remo and Ventnor, substitute the following water sampling locality named San Remo–Phillip Island, with boundaries as described by this notice;
 - for the water sampling localities named Corinella and Grantville, substitute the following water sampling locality named Water Line, with boundaries as described by this notice.

These variations will take effect from the date this notice is published in the Victoria Government Gazette.

SUZIE SARKIS
Manager Water

SPECIAL

WATER SAMPLING LOCALITY NAME: SAN REMO–PHILLIP ISLAND

The co-ordinates listed in the table below and referenced on the following diagram are based on the Geocentric Datum of Australia 1994, Map Grid of Australia, Zone 55.

Co-ordinate	Easting	Northing
1	342419.3838	5741971.7232
2	342743.7180	5741200.6058
3	344737.9985	5740022.3349
4	349046.8613	5740086.3008
5	349001.5068	5741568.6308
6	349595.3107	5741568.7338
7	362366.3851	5736261.5617
8	362000.1729	5733403.0393

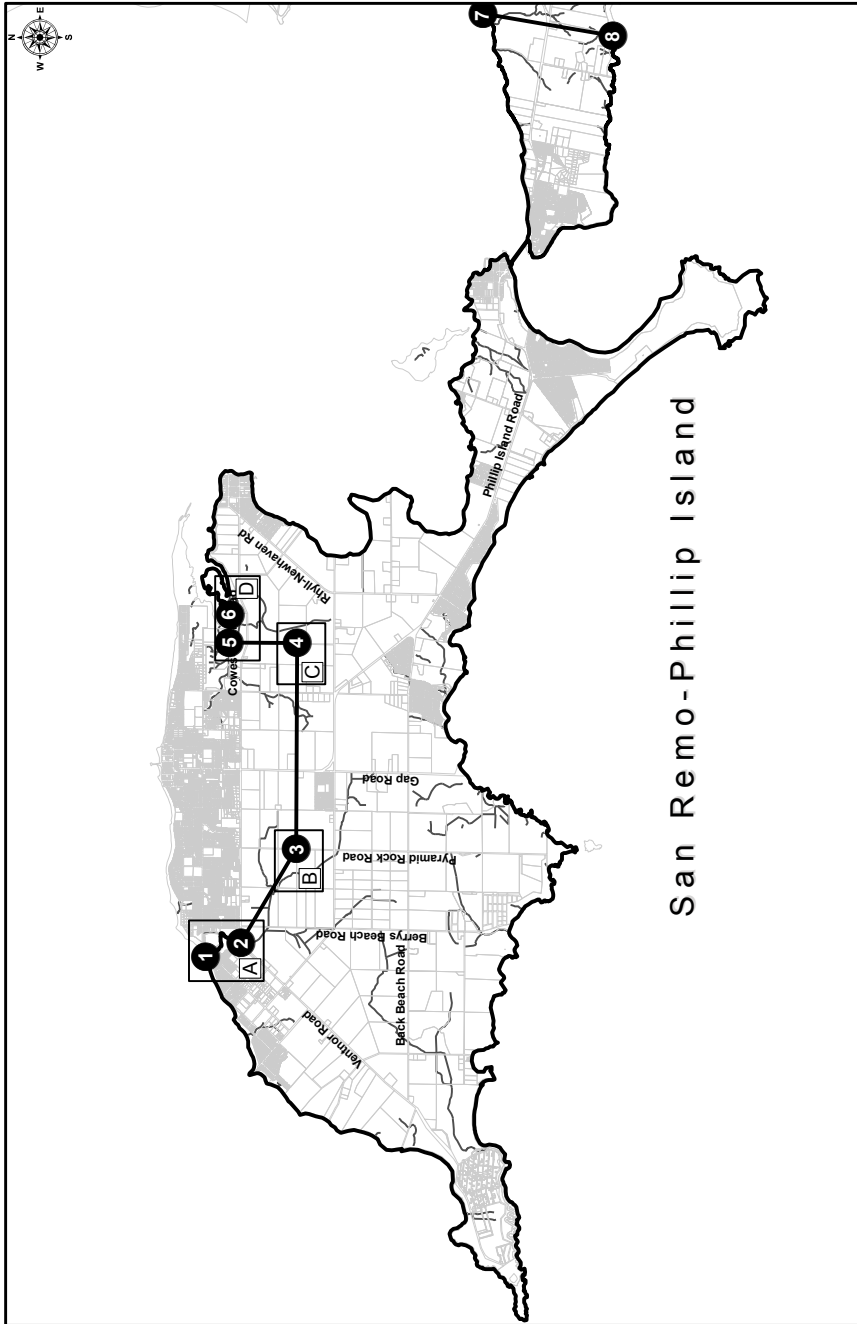

Sampling Locality San Remo-Phillip Island

Coordinate System: GDA 94 MGA 55

- Coordinate Points
- Rivers
- Water Line
- Land Parcels

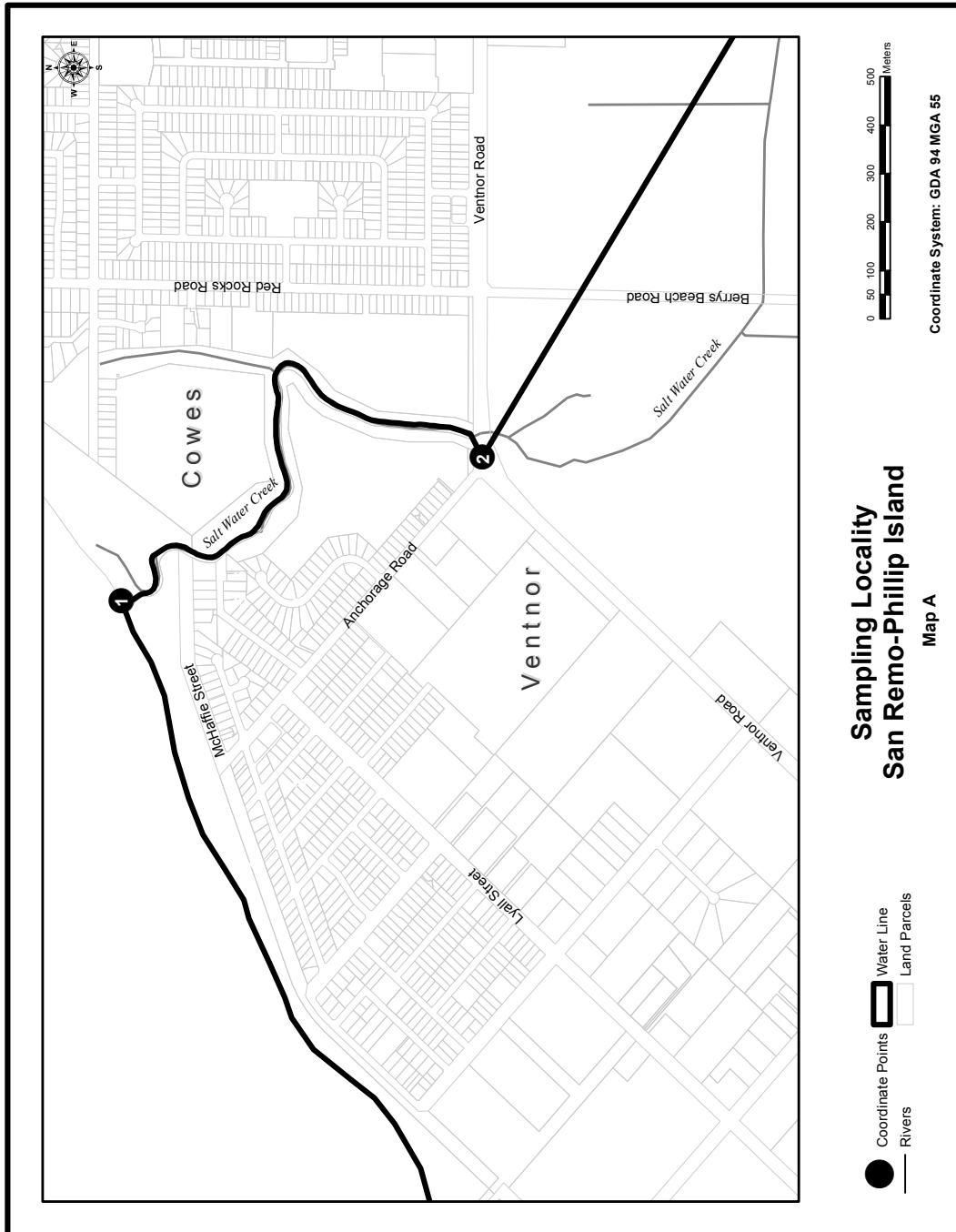

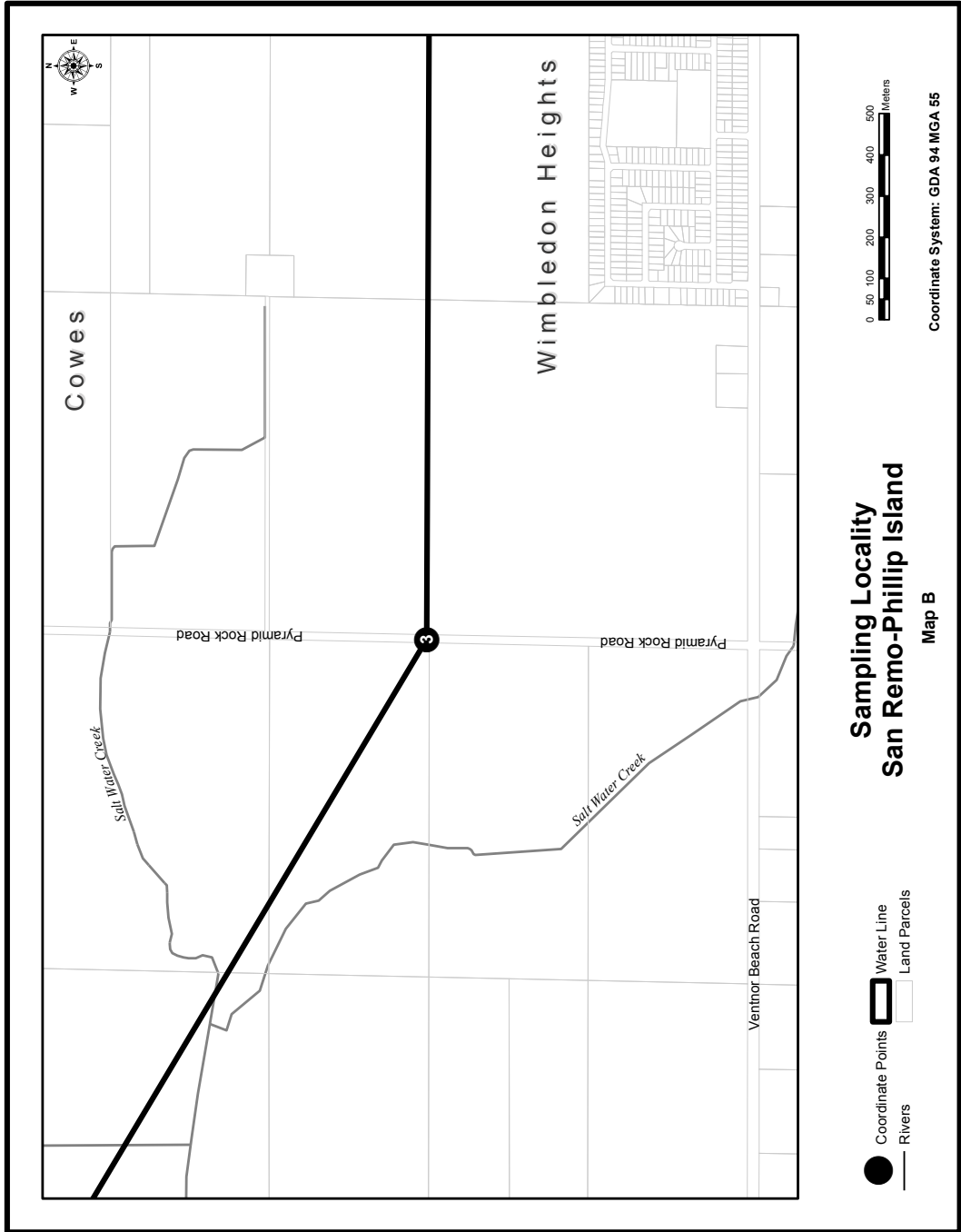

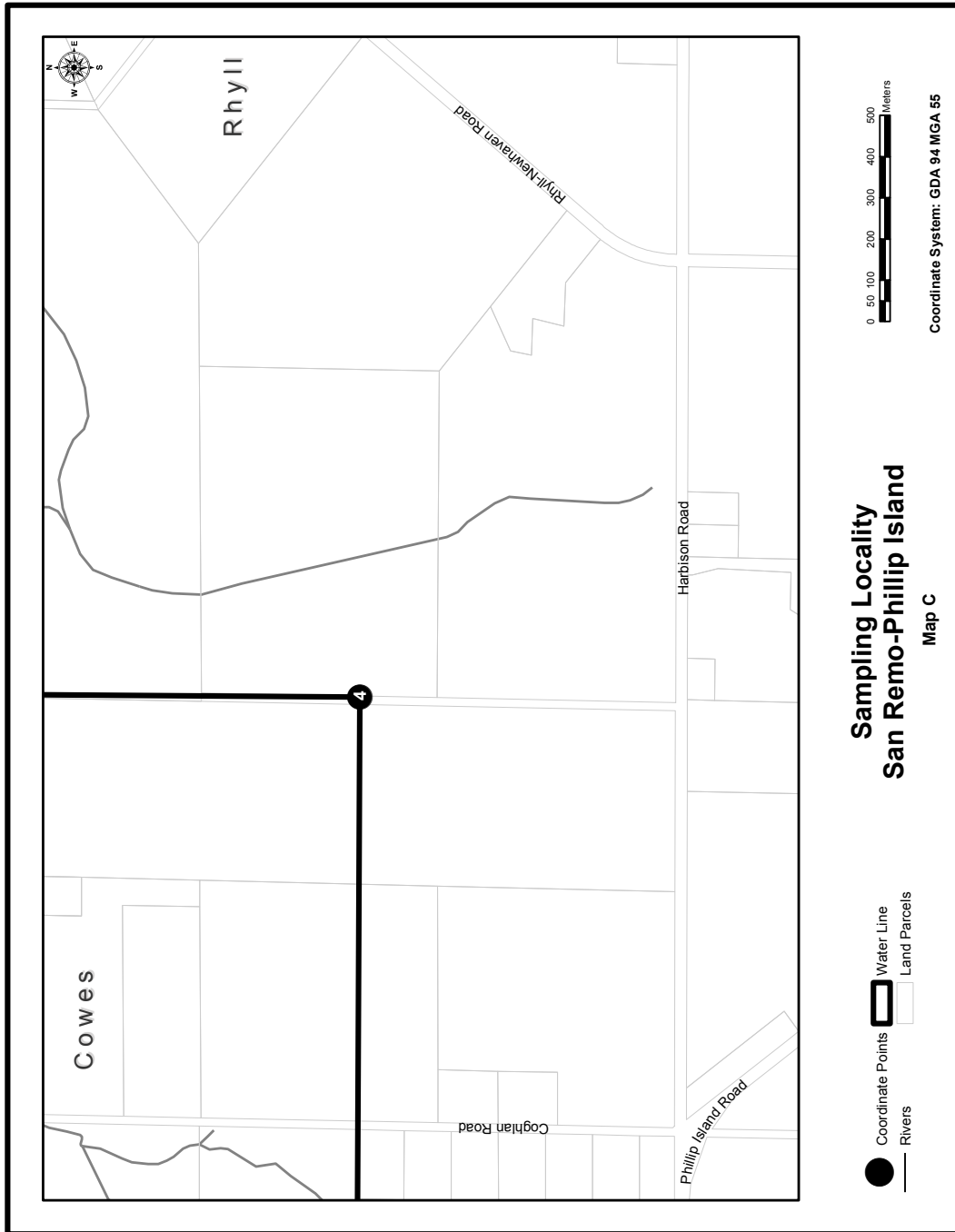

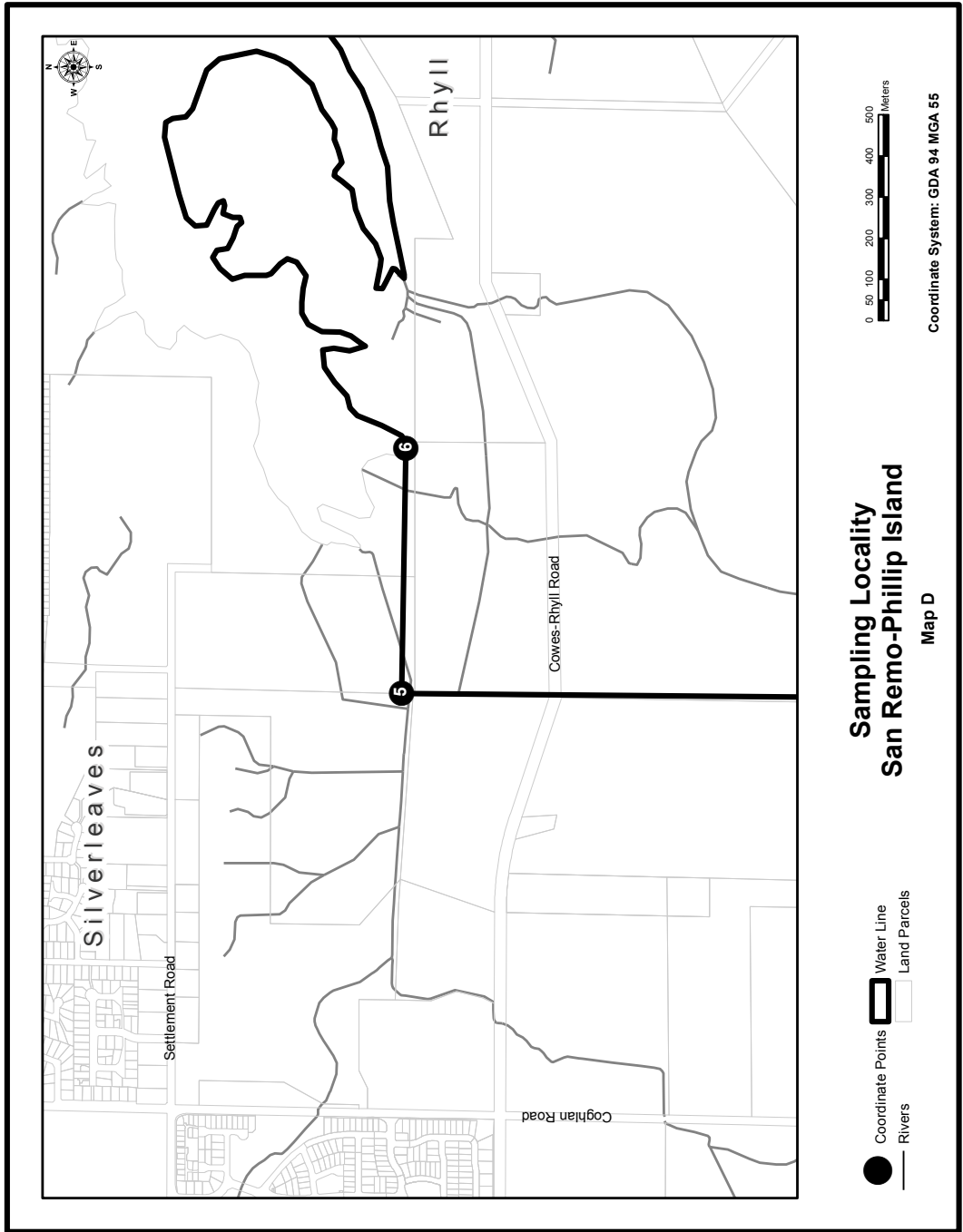

WATER SAMPLING LOCALITY NAME: WATER LINE

The co-ordinates listed in the table below and referenced on the following diagram are based on the Geocentric Datum of Australia 1994, Map Grid of Australia, Zone 55.

Co-ordinate	Easting	Northing
1	373228.2616	5752120.0514
2	376743.3354	5751849.3927
3	376746.4265	5744360.0873
4	369050.7245	5745279.7770
5	368672.9150	5742631.6763
6	367484.7156	5742805.2761
7	367395.7137	5742266.4762
8	362976.1085	5742900.9674

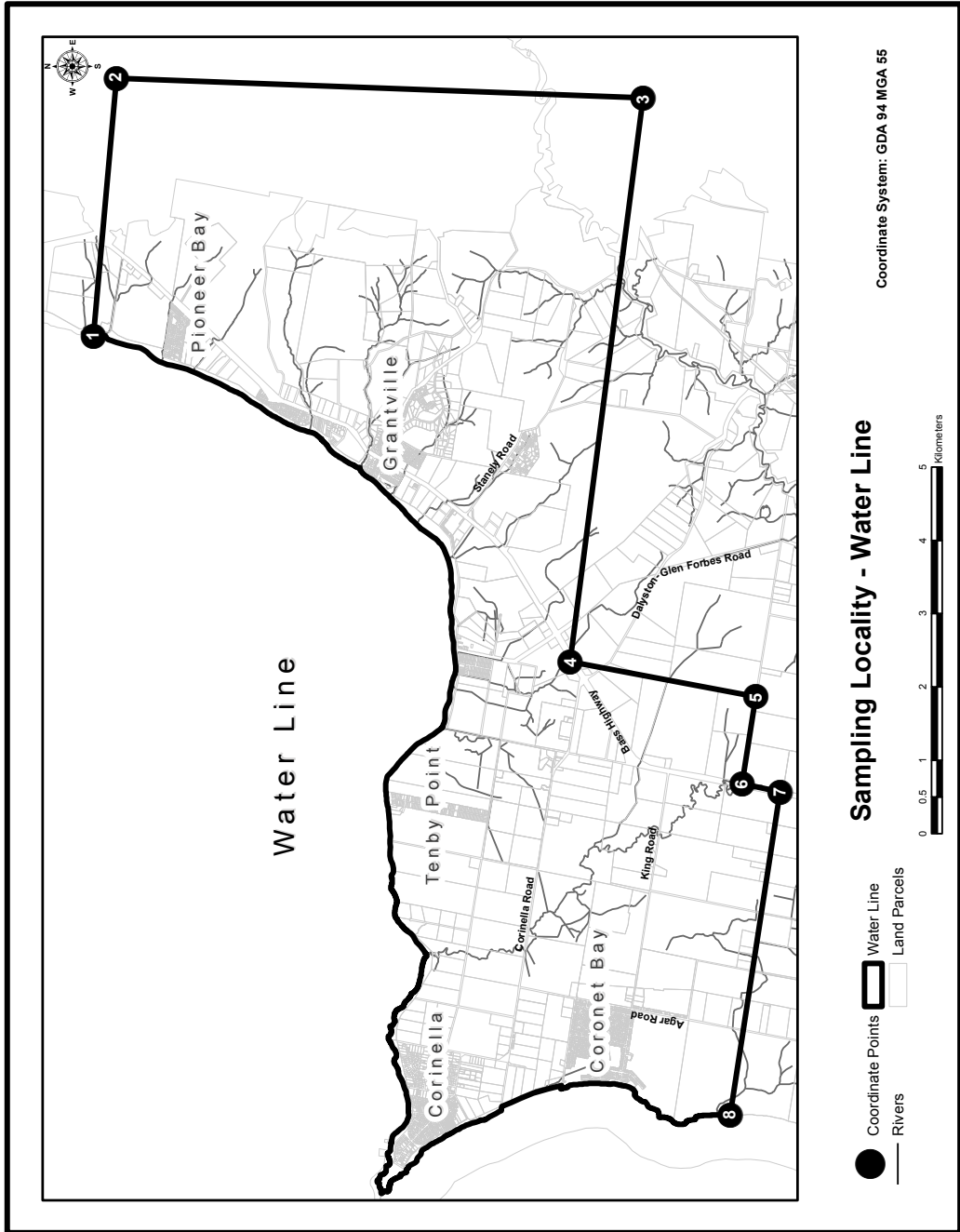

Sampling Locality - Water Line

Coordinate System: GDA 94 MGA 55

- Coordinate Points
- Rivers
- ▭ Water Line
- ▭ Land Parcels



This page was left blank intentionally

This page was left blank intentionally

bluestar * **PRINT**

The *Victoria Government Gazette* is published by Blue Star Print with the authority of the Government Printer for the State of Victoria

© State of Victoria 2018

This publication is copyright. No part may be reproduced by any process except in accordance with the provisions of the Copyright Act.

Address all enquiries to the Government Printer for the State of Victoria

Level 2, 1 Macarthur Street
Melbourne 3002
Victoria Australia

How To Order



**Retail &
Mail Sales**

Victoria Government Gazette

Ground Floor, Building 8,
658 Church Street,
Richmond 3121
DX 106 Melbourne



Telephone

(03) 8523 4601



Fax

(03) 9600 0478

email

gazette@bluestargroup.com.au

Price Code A