



Victoria Government Gazette

No. S 485 Thursday 24 September 2020
By Authority of Victorian Government Printer

Road Management Act 2004

ROAD DECLARATIONS AND DISCONTINUANCE

ROAD DECLARATIONS

Head, Transport for Victoria, pursuant to sections 11 and 14 of the **Road Management Act 2004**, upon publication of this notice declares or revokes the roads described in Schedule A and on the plans attached.

ROAD DISCONTINUANCE

Head, Transport for Victoria, pursuant to section 12 of the **Road Management Act 2004**, upon publication of this notice discontinues the parts of the roads described in Schedule B and on the plan attached.

The effects of these Road Declarations and Road Discontinuance on road names are described in Table 1.

SCHEDULE A

FREEWAY

- a) Those parts of Western Freeway identified by hatching on the plan numbered GP23933 are declared or revoked as described in the legend in the said plan.

ARTERIAL ROAD

- b) Those parts of Greaves Road identified by hatching on the plans numbered GP24098D and GP24098E are declared as described in the legend in the said plans.
- c) Those parts of Melton Highway identified by hatching on the plan numbered GP23904 are revoked as described in the legend in the said plan.

NON-ARTERIAL STATE ROAD

- d) Those parts of Halletts Way identified by hatching on the plan numbered GP23933A are declared as described in the legend in the said plan.

MUNICIPAL ROAD

- e) Those parts of Robertsons Road, Sydenham Road and Victoria Road identified by hatching on the plan numbered GP23904A are declared as described in the legend in the said plan.

SCHEDULE B

ROAD

- a) Those parts of road identified by hatching on the plan numbered GP23904 are discontinued as described in the legend in the said plan.

SPECIAL

TABLE 1

EFFECTS ON ROAD NAMES

1. Names in Column 2 are existing Vicmap Address names, which are unaffected by this notice.
2. **Names in Column 1 are for Department of Transport administrative purposes only and are independent of names in Column 2.**
3. Names in Column 2 may not apply to the whole length of the road and are for general information only.

FREEWAY

GP Number	Department of Transport Administrative Road Name Column 1	Vicmap Address Road Name (for property addressing purposes) Column 2
GP23933	Western Freeway	Not Applicable

ARTERIAL ROAD

GP Number	Department of Transport Administrative Road Name Column 1	Vicmap Address Road Name (for property addressing purposes) Column 2
GP24098D GP24098E	Greaves Road	Greaves Road
GP23904	Melton Highway	Not detailed – Road boundary adjustments only

NON-ARTERIAL STATE ROAD

GP Number	Department of Transport Administrative Road Name Column 1	Vicmap Address Road Name (for property addressing purposes) Column 2
GP23933A	Halletts Way	Halletts Way

MUNICIPAL ROAD

GP Number	Department of Transport Administrative Road Name Column 1	Vicmap Address Road Name (for property addressing purposes) Column 2
GP23904A	Not applicable	Not detailed – Road boundary adjustments only

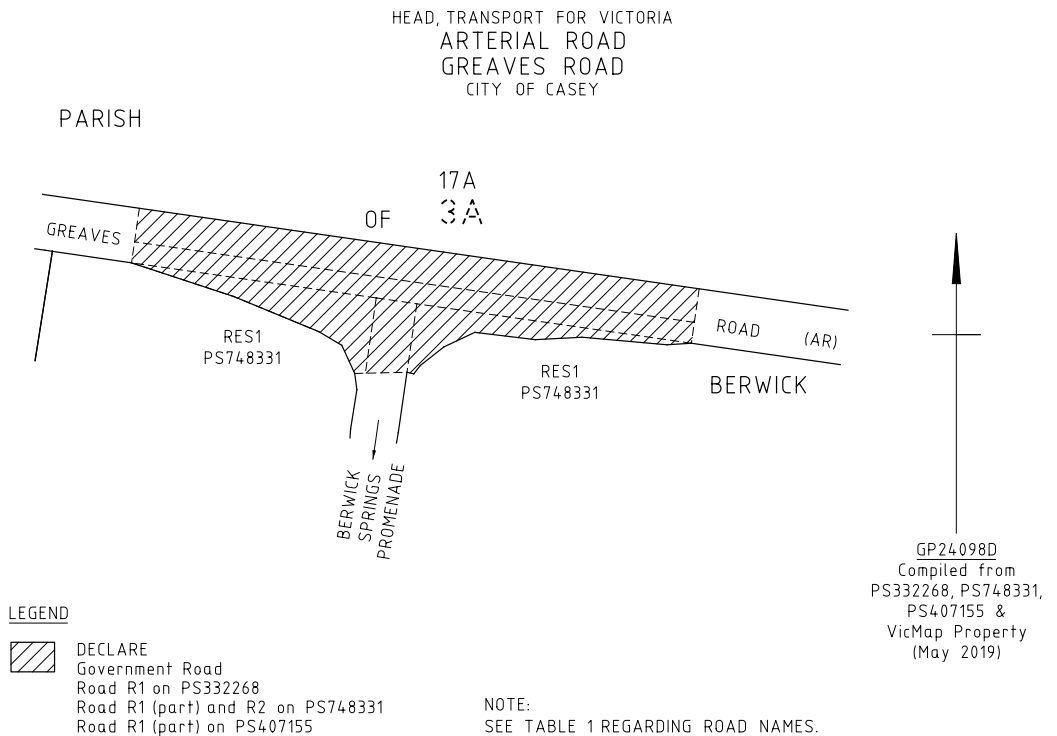
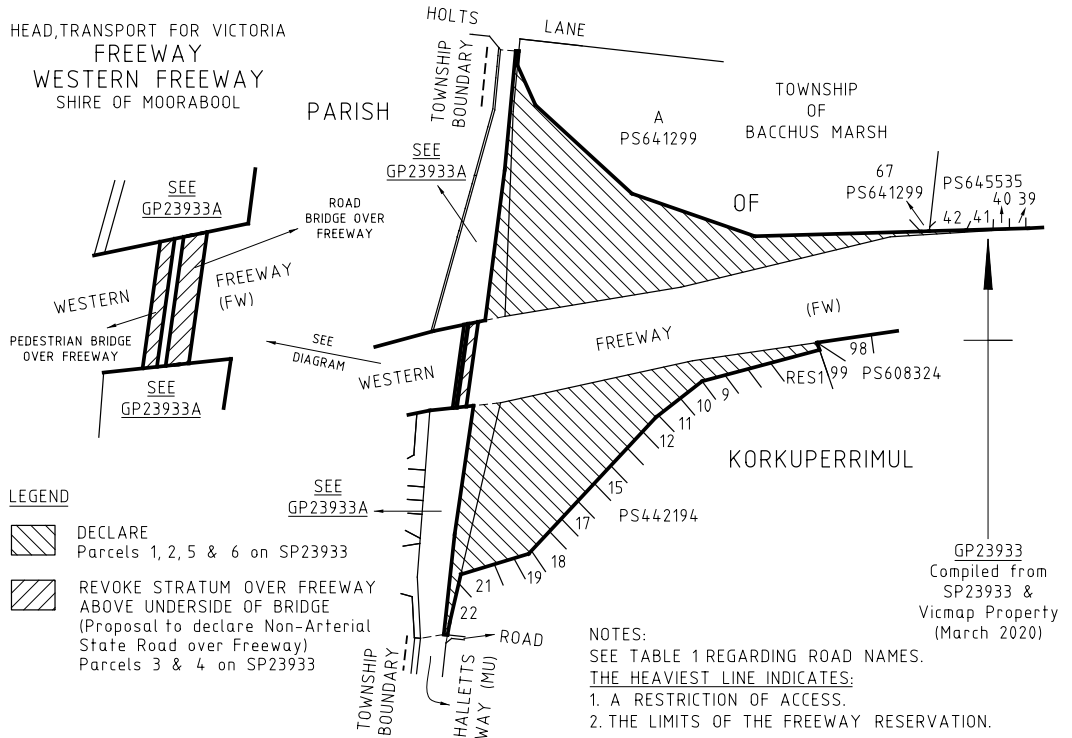

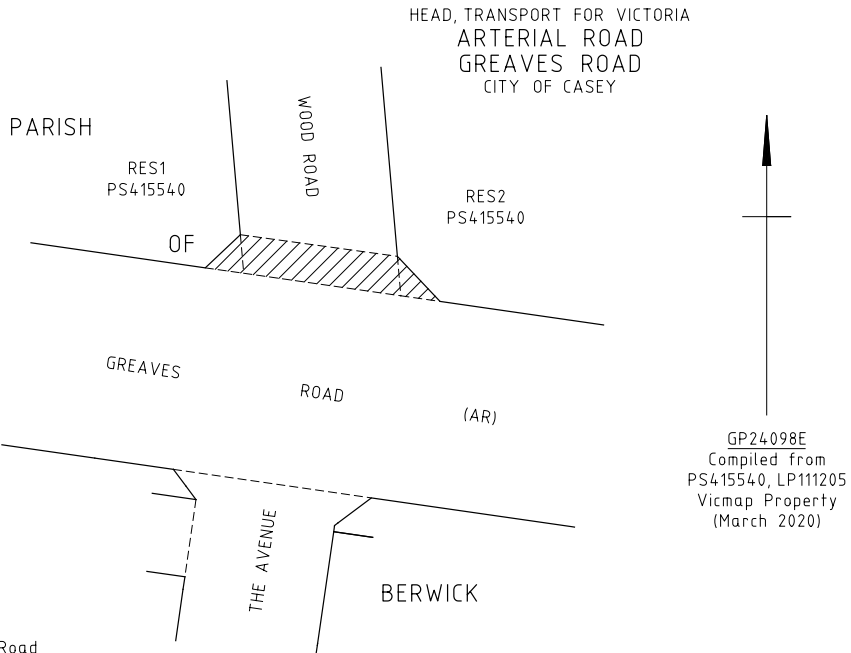

LEGEND



-  DECLARE Government Road
Road R1 on PS415540
Road R1 on LP111205

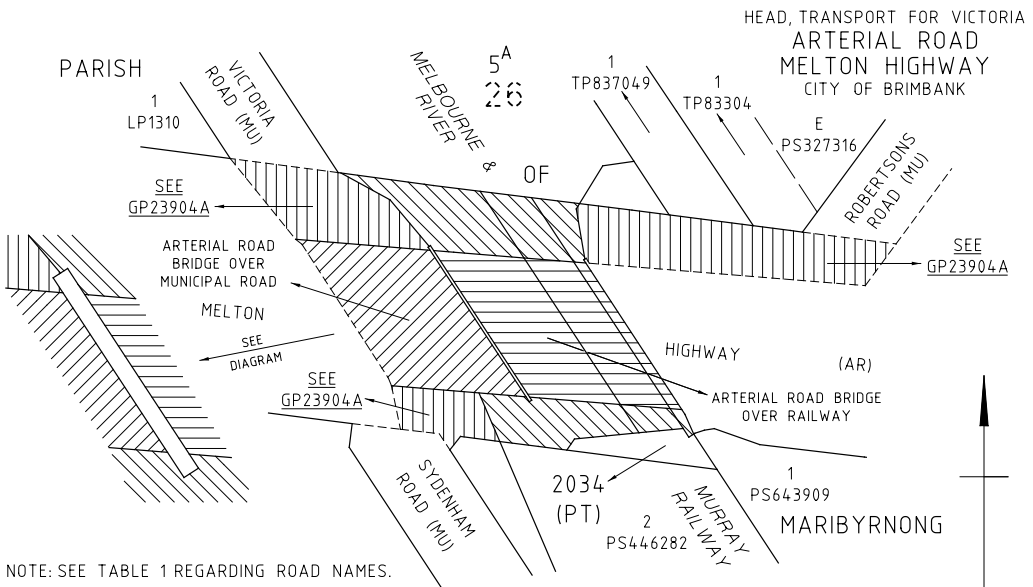

NOTE:
SEE TABLE 1 REGARDING ROAD NAMES.



NOTE: SEE TABLE 1 REGARDING ROAD NAMES.

LEGEND

-  REVOKE (Proposal to declare Municipal Road) Parcels 1, 4, & 8 on SP23904
-  REVOKE STRATUM UNDER ARTERIAL ROAD (Proposal to declare Municipal Road) Parcel 5 on SP23904



-  REVOKE AND DISCONTINUE Parcels 2, 9, 10, 13, 15 & 17 on SP23904
-  REVOKE AND DISCONTINUE STRATUM UNDER ARTERIAL ROAD Parcels 7, 14 & 16 on SP23904

GP23904
Compiled from
SP23904

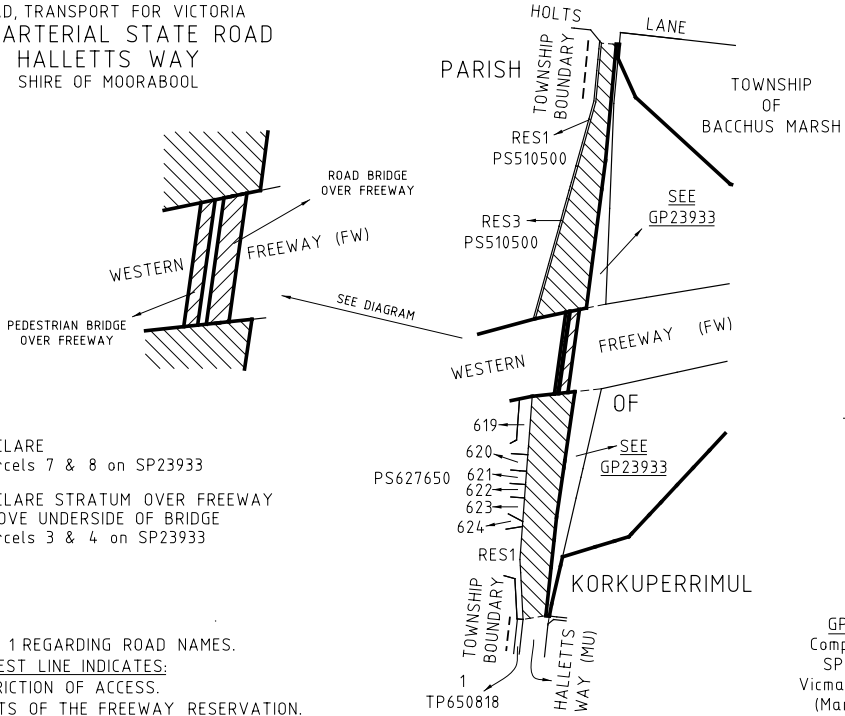
HEAD, TRANSPORT FOR VICTORIA
NON-ARTERIAL STATE ROAD
HALLETTS WAY
SHIRE OF MOORABOOL



LEGEND

-  DECLARE
Parcels 7 & 8 on SP23933
-  DECLARE STRATUM OVER FREEWAY
ABOVE UNDERSIDE OF BRIDGE
Parcels 3 & 4 on SP23933

NOTES:



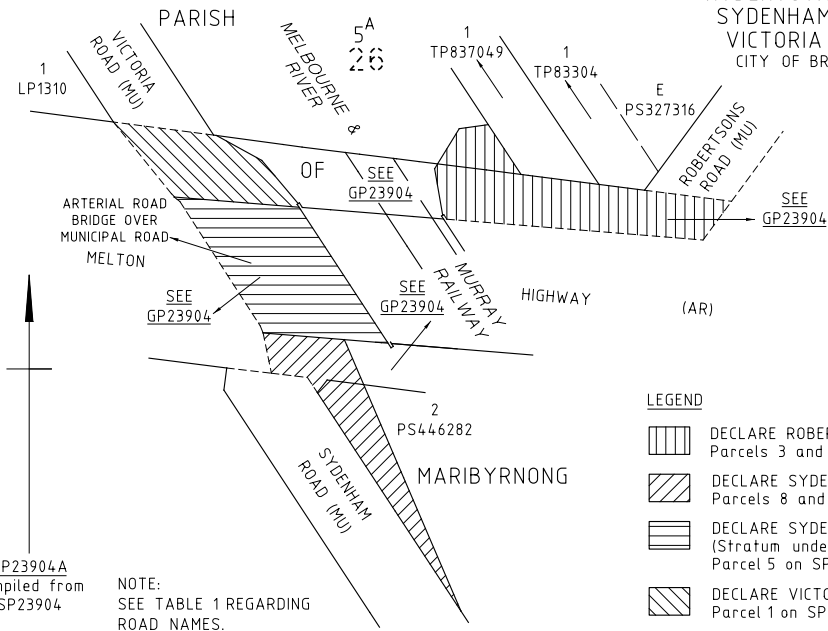

- SEE TABLE 1 REGARDING ROAD NAMES.
- THE HEAVIEST LINE INDICATES:
- 1. A RESTRICTION OF ACCESS.
- 2. THE LIMITS OF THE FREEWAY RESERVATION.

GP23933A
Compiled from
SP23933 &
Vicmap Property
(March 2020)

HEAD, TRANSPORT FOR VICTORIA
MUNICIPAL ROAD
ROBERTSONS ROAD
SYDENHAM ROAD
VICTORIA ROAD
CITY OF BRIMBANK



LEGEND

-  DECLARE ROBERTSONS ROAD
Parcels 3 and 4 on SP23904
-  DECLARE SYDENHAM ROAD
Parcels 8 and 11 on SP23904
-  DECLARE SYDENHAM ROAD
(Stratum under Arterial Road)
Parcel 5 on SP23904
-  DECLARE VICTORIA ROAD
Parcel 1 on SP23904

GP23904A
Compiled from
SP23904
NOTE:
SEE TABLE 1 REGARDING
ROAD NAMES.

Dated 23 September 2020

ROBERT MURPHY
Executive Director – Transport Assets
Department of Transport

This page was left blank intentionally

This page was left blank intentionally

ive

The *Victoria Government Gazette* is published by IVE Group Limited with the authority of the Government Printer for the State of Victoria

© State of Victoria 2020

This publication is copyright. No part may be reproduced by any process except in accordance with the provisions of the Copyright Act.

Address all enquiries to the Government Printer for the State of Victoria
Level 2, 1 Macarthur Street
Melbourne 3002
Victoria Australia

How To Order



**Retail &
Mail Sales**

Victoria Government Gazette

Ground Floor, Building 8,
658 Church Street,
Richmond 3121

DX 106 Melbourne



Telephone

(03) 8523 4601



Fax

(03) 9600 0478

email

gazette@ivegroup.com.au

Price Code A