



Victoria Government Gazette

No. S 581 Thursday 12 November 2020
By Authority of Victorian Government Printer

Road Management Act 2004

ROAD DECLARATIONS

Head, Transport for Victoria, pursuant to sections 11 and 14 of the **Road Management Act 2004**, upon publication of this notice declares the roads described in the Schedule and on the plans attached.

The effects of these Road Declarations on road names are described in Table 1.

SCHEDULE

ARTERIAL ROAD

- a) That part of Burke Road identified by hatching on the plan numbered GP23534B is declared as described in the legend in the said plan.
- b) Those parts of Centre Road identified by hatching on the plan numbered GP23674A are declared as described in the legend in the said plan.

MUNICIPAL ROAD

- c) That part of Glenarm Road identified by hatching on the plan numbered GP23531C is declared as described in the legend in the said plan.
- d) That part of Katandra Road identified by hatching on the plan numbered GP23683C is declared as described in the legend in the said plan.

SPECIAL

TABLE 1**EFFECTS ON ROAD NAMES**

1. Names in Column 2 are existing Vicmap Address names, which are unaffected by this notice.
2. **Names in Column 1 are for Department of Transport administrative purposes only and are independent of names in Column 2.**
3. Names in Column 2 may not apply to the whole length of the road and are for general information only.

ARTERIAL ROADS

GP Number	Department of Transport Administrative Road Name Column 1	Vicmap Address Road Name (for property addressing purposes) Column 2
GP23534B	Burke Road	Not detailed – Road boundary adjustments only
GP23674A	Centre Road	Not detailed – Road boundary adjustments only

MUNICIPAL ROADS

GP Number	Department of Transport Administrative Road Name Column 1	Vicmap Address Road Name (for property addressing purposes) Column 2
GP23531C	Not applicable	Glenarm Road
GP23683C	Not applicable	Not detailed – Road boundary adjustments only

HEAD, TRANSPORT FOR VICTORIA
 ARTERIAL ROAD
 BURKE ROAD
 CITY OF STONNINGTON

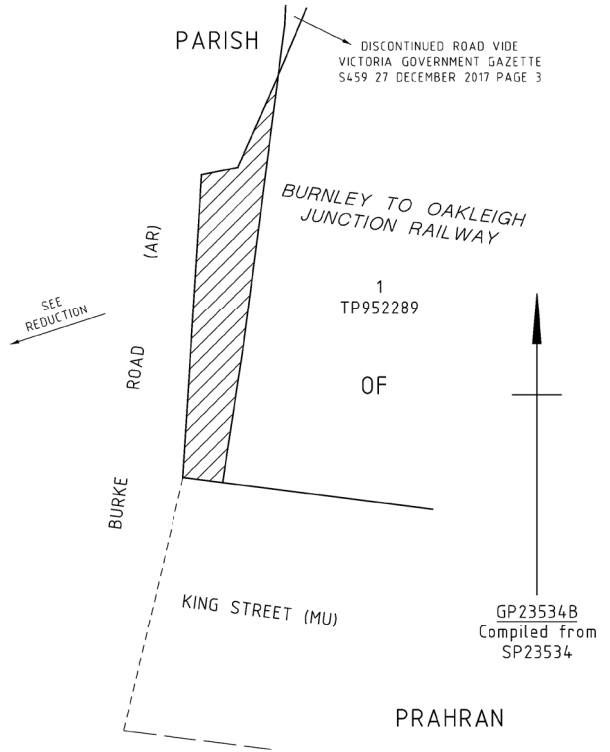
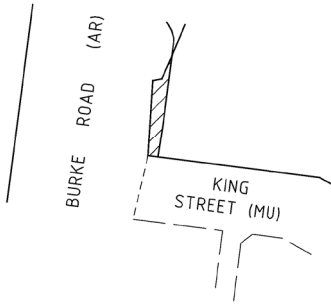

LEGEND

DECLARE
 Parcel 93 on SP23534

NOTE:
 SEE TABLE 1 REGARDING ROAD NAMES.

GP23534B
 Compiled from
 SP23534

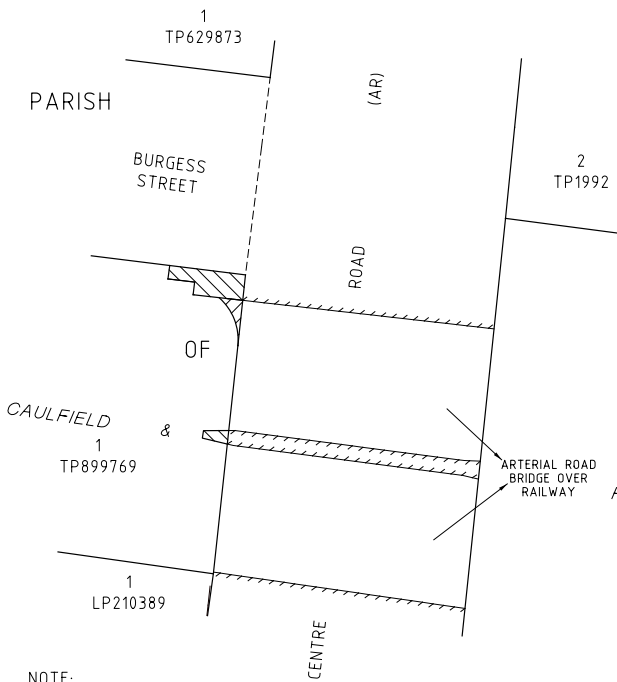

HEAD, TRANSPORT FOR VICTORIA
 ARTERIAL ROAD
 CENTRE ROAD
 CITY OF GLEN EIRA

LEGEND

DECLARE
 Parcels 47 & 52 on SP23674

DECLARE STRATUM OVER RAILWAY
 Parcel 46 on SP23674

NOTE:
 SEE TABLE 1 REGARDING ROAD NAMES.

GP23674A
 Compiled from
 SP23674

HEAD, TRANSPORT FOR VICTORIA
MUNICIPAL ROAD
GLENARM ROAD
CITY OF STONNINGTON

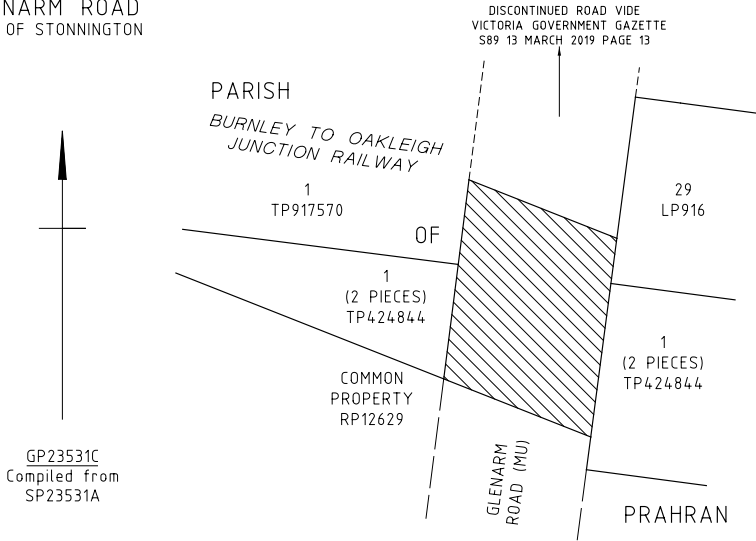

LEGEND

 DECLARE
Parcel 32 on SP23531A

NOTE:
SEE TABLE 1 REGARDING ROAD NAMES.

PARISH

HEAD, TRANSPORT FOR VICTORIA
MUNICIPAL ROAD
KATANDRA ROAD
CITY OF GLEN EIRA

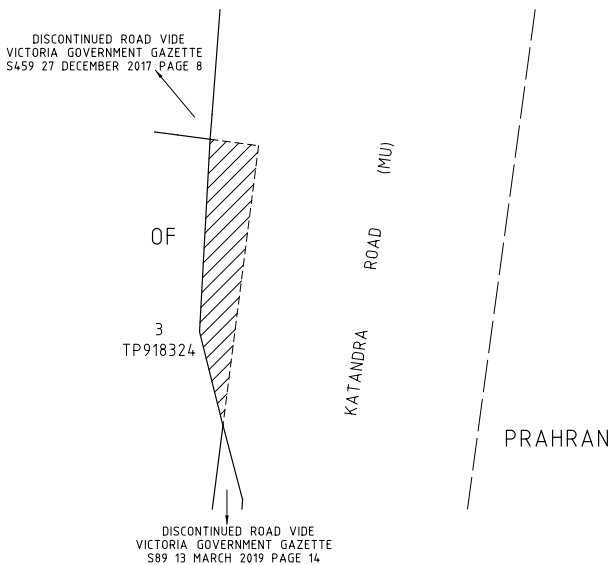

LEGEND

 DECLARE
Parcel 16 on SP23683A

NOTE:
SEE TABLE 1 REGARDING ROAD NAMES.

GP23683C
Compiled from
SP23683A &
Vicmap Property
(July 2020)

Dated 9 November 2020

ROBERT MURPHY
Executive Director – Transport Assets
Department of Transport

This page was left blank intentionally

This page was left blank intentionally

This page was left blank intentionally

ive

The *Victoria Government Gazette* is published by IVE Group Limited with the authority of the Government Printer for the State of Victoria

© State of Victoria 2020

This publication is copyright. No part may be reproduced by any process except in accordance with the provisions of the Copyright Act.

Address all enquiries to the Government Printer for the State of Victoria
Level 2, 1 Macarthur Street
Melbourne 3002
Victoria Australia

How To Order



**Retail &
Mail Sales**

Victoria Government Gazette

Ground Floor, Building 8,
658 Church Street,
Richmond 3121

DX 106 Melbourne



Telephone

(03) 8523 4601

email

gazette@ivegroup.com.au

Price Code A