



Victoria Government Gazette

No. S 464 Friday 27 August 2021
By Authority of Victorian Government Printer

Road Management Act 2004

ROAD DECLARATIONS AND DISCONTINUANCE

ROAD DECLARATIONS

Head, Transport for Victoria, pursuant to sections 11 and 14 of the **Road Management Act 2004**, upon publication of this notice revokes or declares the roads described in Schedule A and on the plans attached.

ROAD DISCONTINUANCE

Head, Transport for Victoria, pursuant to section 12 of the **Road Management Act 2004**, upon publication of this notice discontinues the part of the road described in Schedule B and on the plan attached.

The effects of these Road Declarations and Road Discontinuance on road names are described in Table 1.

SCHEDULE A

ARTERIAL ROAD

- a) Those parts of Phillip Island Road identified by hatching on the plans numbered GP23600 and GP23870 are declared as described in the legend in the said plans.
- b) Those parts of Hoddle Highway identified by hatching on the plan numbered GP23872 are declared as described in the legend in the said plan.
- c) That part of Swan Street identified by hatching on the plan numbered GP23872 is declared as described in the legend in the said plan.
- d) Those parts of Klauer Road identified by hatching on the plan numbered GP24389 are declared or revoked as described in the legend in the said plan.

SCHEDULE B

ROAD

- a) That part of Road identified by hatching on the plan numbered GP24389 is discontinued as described in the legend in the said plan.

TABLE 1

EFFECTS ON ROAD NAMES

1. Names in Column 2 are existing Vicmap Address names, which are unaffected by this notice.
2. **Names in Column 1 are for Department of Transport administrative purposes only and are independent of names in Column 2.**
3. Names in Column 2 may not apply to the whole length of the road and are for general information only.

ARTERIAL ROAD

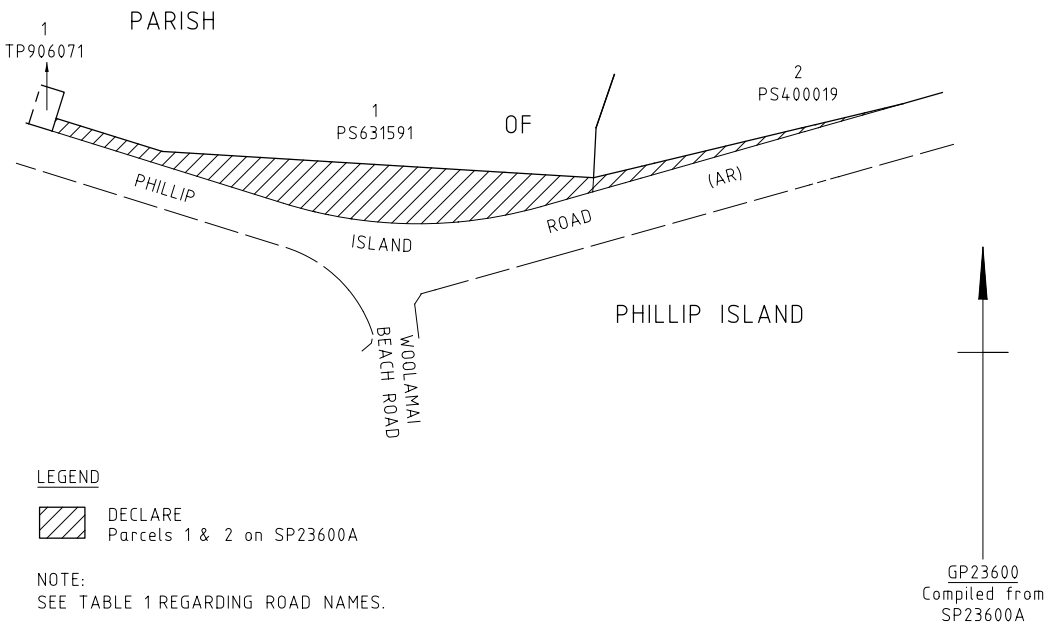

| GP Number | Department of Transport Administrative Road Name Column 1 | Vicmap Address Road Name (for property addressing purposes) Column 2 |
|--------------------|--|--|
| GP23600 GP23870 | Phillip Island Road | Not detailed – Road boundary adjustments only |
| GP23872 | Hoddle Highway | Not detailed – Road boundary adjustments only |
| GP23872 | Swan Street | Not detailed – Road boundary adjustments only. |
| GP24389 | Klauer Road | Not detailed – Road boundary adjustments only. |

HEAD, TRANSPORT FOR VICTORIA
ARTERIAL ROAD
PHILLIP ISLAND ROAD
BASS COAST SHIRE

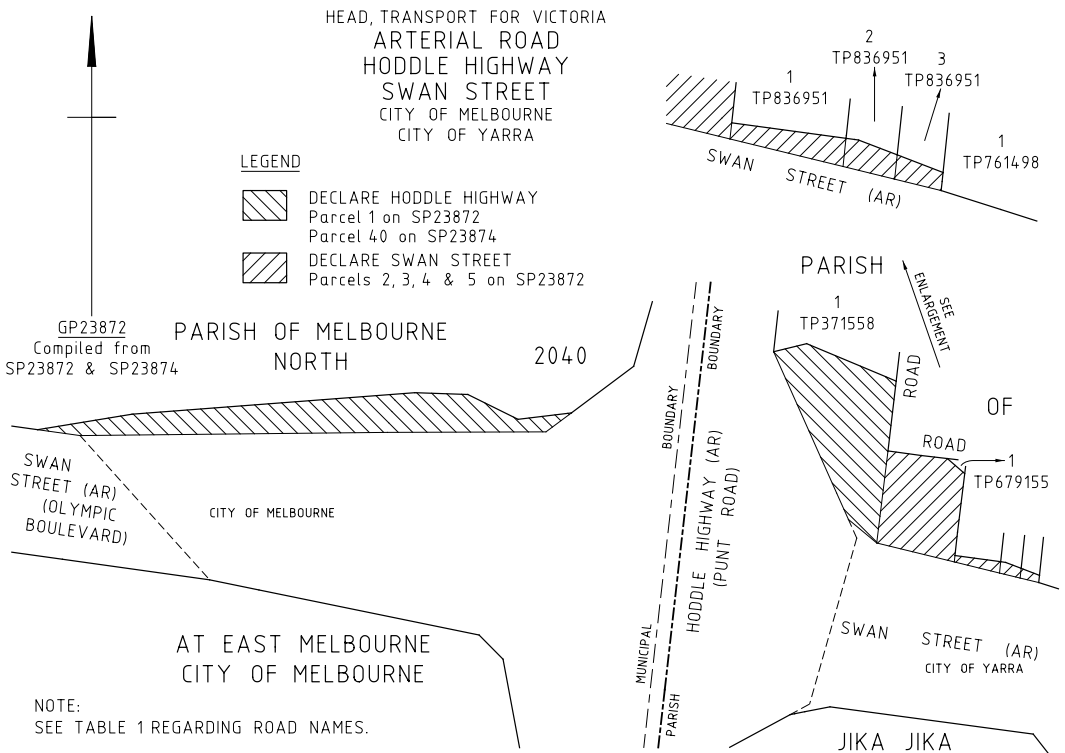
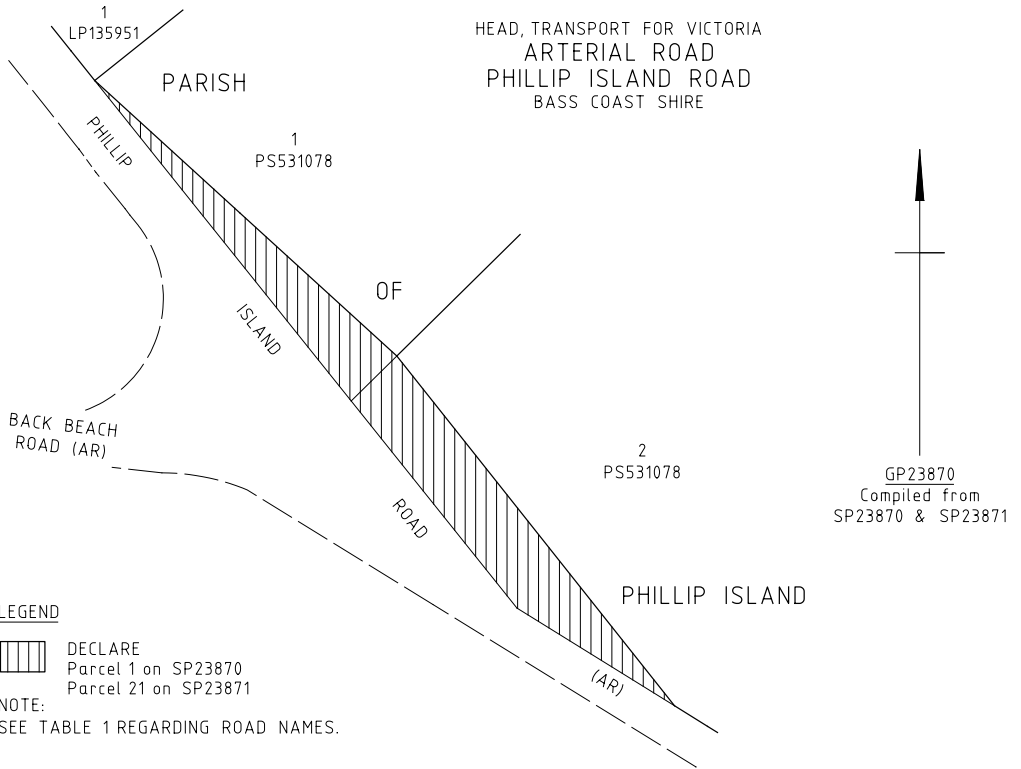



LEGEND

-  DECLARE
Parcels 1 & 2 on SP24389
-  REVOKE & DISCONTINUE
Parcels 3 & 4 on SP24389

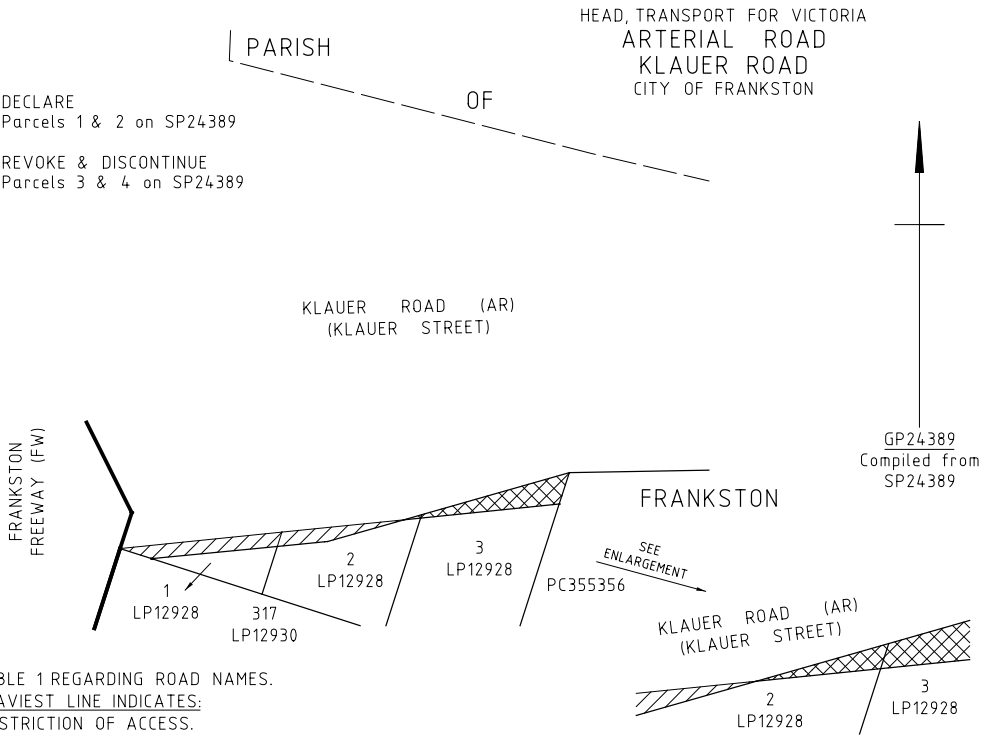

NOTES:
 SEE TABLE 1 REGARDING ROAD NAMES.
 THE HEAVIEST LINE INDICATES:
 1. A RESTRICTION OF ACCESS.
 2. THE LIMITS OF THE FREEWAY RESERVATION.

Dated 25 August 2021

ROBERT MURPHY
 Executive Director – Transport Assets
 Department of Transport

This page was left blank intentionally

This page was left blank intentionally

This page was left blank intentionally

ive

The *Victoria Government Gazette* is published by IVE Group Limited with the authority of the Government Printer for the State of Victoria

© State of Victoria 2021

This publication is copyright. No part may be reproduced by any process except in accordance with the provisions of the Copyright Act.

Address all enquiries to the Government Printer for the State of Victoria
Level 2, 1 Macarthur Street
Melbourne 3002
Victoria Australia

How To Order



**Retail &
Mail Sales**

Victoria Government Gazette

Ground Floor, Building 8,
658 Church Street,
Richmond 3121

DX 106 Melbourne



Telephone

(03) 8523 4601

email

gazette@ivegroup.com.au

Price Code A