



Victoria Government Gazette

By Authority of Victorian Government Printer

No. G 19 Thursday 12 May 2022

www.gazette.vic.gov.au

GENERAL

TABLE OF PROVISIONS

Private Advertisements		Ralph James Smith	2424
Dissolution of Partnership		Rennick & Gaynor	2424
Draught Busters	2419	Roberts Beckwith Partners	2424
		Rydge Evans Lawyers	2424
Estates of Deceased Persons		Somerswood Lawyers	2425
Brendan Holland & Michael Cahir	2419	Suzanne Lyttleton Lawyers	2425
David Davis & Associates	2419	Tragear & Harris Lawyers	2425
Dimos Lawyers	2419		
Eden Lawyers	2420	Government and Outer Budget Sector	
Featherbys Lawyers	2420	Agencies Notices	2426
GE Law Services	2420	Orders in Council	2443
Grainger Legal	2420	Education and Training Reform;	
Hall & Wilcox Lawyers	2420	Transport Accident	
Hassall's Litigation Services	2420	Obtainables	2466
Hicks Oakley Chessell Williams	2421		
Hunt, McCullough, Kollias & Co.	2421		
Hutchinson Legal	2421		
I. Glenister & Associates	2421		
KCL Law	2422		
Keith R. Cameron Solicitors	2422		
Kingston Lawyers Pty Ltd	2422		
Kirby & Co.	2422		
McDonald, Slater & Lay	2423		
Martin J. Hull Lawyer	2423		
Maurice Blackburn Lawyers	2423		
Mills Oakley	2423		
Neesham White Gentle	2424		
O'Halloran Davis	2424		

Advertisers Please Note

As from 12 May 2022

The last Special Gazette was No. 234 dated 11 May 2022.

The last Periodical Gazette was No. 1 dated 9 June 2021.

How To Submit Copy

- See our webpage www.gazette.vic.gov.au
 - or contact our office on 8523 4601
between 8.30 am and 5.30 pm Monday to Friday
-

PRIVATE ADVERTISEMENTS**DISSOLUTION OF PARTNERSHIP**

Pursuant to section 41 of the **Partnership Act 1958**, take notice that the partnership between Ecomad Pty Ltd and Ecocraft Pty Ltd, trading as Draught Busters, ABN 60 675 364 460, will be dissolved by agreement with effect from 30 June 2022.

Re: Estate of MARGARET JEAN GOGEL, late of Arcare Carnegie, 47 Rosanna Road, Carnegie, Victoria, deceased.

Creditors, next-of-kin or others having claims in respect of the estate of the deceased, who died on 5 February 2022, are required by the trustee, Carolyn Jean O'Malley, to send particulars of their claims to the trustee, care of the undermentioned legal practitioners, by a date not later than two months from the date of publication of this advertisement, after which date the trustee may convey or distribute the assets, having regard only to the claims of which she then has notice.

BRENDAN HOLLAND & MICHAEL CAHIR,
legal practitioners,
130 Balcombe Road, Mentone 3194.

Re: Estate of JAMES GEORGE MAHOMET, late of TLC Forest Lodge, 23 Forest Drive, Frankston North, Victoria, deceased.

Creditors, next-of-kin or others having claims in respect of the estate of the deceased, who died on 8 February 2022, are required by the trustee, Gwenda Carol Bendall, to send particulars of their claims to the trustee, care of the undermentioned legal practitioners, by a date not later than two months from the date of publication of this advertisement, after which date the trustee may convey or distribute the assets, having regard only to the claims of which she then has notice.

BRENDAN HOLLAND & MICHAEL CAHIR,
legal practitioners,
130 Balcombe Road, Mentone 3194.

WILLIAM FRANCIS COAD, late of Room 22, 206 Holdsworth Road, North Bendigo, Victoria, retired, deceased.

Creditors, next-of-kin and others having claims in respect of the estate of the deceased, who died on 7 November 2021, are required by the executor,

Equity Trustees Wealth Services Limited, ACN 006 132 332, of Level 1, 575 Bourke Street, Melbourne, Victoria, to send particulars to it by 12 July 2022, after which date it may convey or distribute the assets, having regard only to the claims of which it then has notice.

DAVID DAVIS & ASSOCIATES,
Suite 2, 733 High Street, Thornbury,
Victoria 3071.

ZENA OLIVE COAD, late of Room 51, 206 Holdsworth Road, North Bendigo, Victoria, retired, deceased.

Creditors, next-of-kin and others having claims in respect of the estate of the deceased, who died on 20 December 2021, are required by the executor, Equity Trustees Wealth Services Limited, ACN 006 132 332, of Level 1, 575 Bourke Street, Melbourne, Victoria, to send particulars to it by 12 July 2022, after which date it may convey or distribute the assets, having regard only to the claims of which it then has notice.

DAVID DAVIS & ASSOCIATES,
Suite 2, 733 High Street, Thornbury,
Victoria 3071.

Re: GEORGE ASPRIS, late of 55, 12th Street, Kato Polemidia, Limasol 4159, Cyprus, retired.

Creditors, next-of-kin and others having claims in respect of the estate of the deceased, who died on 31 May 2021, are required by the administrator, Kerri Alyce Lambrianidis, to send particulars to the administrator, care of the undermentioned solicitors, by 14 July 2022, after which date the administrator may convey or distribute the assets of the estate, having regard only to the claims of which the administrator has notice.

DIMOS LAWYERS,
GPO Box 1489, Melbourne, Victoria 3001.

Re: GEORGE COMINOS, late of Unit 2, 130a Doncaster Road, Balwyn North, Victoria, other.

Creditors, next-of-kin and others having claims in respect of the estate of the deceased, who died on 6 November 2021, are required by the administrator, Nicholas Venizelakos,

to send particulars to the administrator, care of the undermentioned solicitors, by 14 July 2022, after which date the administrator may convey or distribute the assets of the estate, having regard only to the claims of which the administrator has notice.

DIMOS LAWYERS,
GPO Box 1489, Melbourne, Victoria 3001.

**NOTICE OF CLAIMANTS UNDER
TRUSTEE ACT 1958**

HELEN MAUDE CAROLANE, late of 11 Leighton Court, Wodonga, Victoria 3690, widow, deceased.

Creditors, next-of-kin and others having claims in respect of the estate of the abovenamed deceased, who died on 27 February 2021, are required by the trustees, Christopher John Robert Carolane and Robert Alexander Pratt, care of 20, 11 Volt Lane, Albury, New South Wales 2640, to send particulars of their claims to them, care of the undermentioned solicitors, by 12 July 2022, after which date the trustees may distribute the estate, having regard only to the claims of which they then have notice. Probate was granted in Victoria on 25 May 2021.

EDEN LAWYERS,
20, 11 Volt Lane, Albury, New South Wales 2640.
PO Box 1384 Albury, New South Wales 2640.
SP:20/0052.
Contact: Susan Pattison.

Re: PETER FRANCIS VAN DER LINDEN, deceased.

Creditors, next-of-kin and others having claims in respect of the estate of the deceased, who died on 22 September 2020, are required by the trustee, Therese Elizabeth Morris, care of Featherbys Lawyers of 14 Ninth Avenue, Rosebud, Victoria, to send particulars to the trustee by 15 July 2022, after which date the trustee may convey or distribute the assets, having regard only to the claims of which the trustee has notice.

FEATHERBYS LAWYERS, solicitors,
14 Ninth Avenue, Rosebud 3939.

Estate MARGARET ELAINE McMULLAN, late of BlueCross Scotchmans Creek, 450 Waverley Road, Mount Waverley, Victoria, secretary, deceased.

Creditors, next-of-kin and others having claims in respect of the abovenamed deceased, who died on 18 April 2021, are required by the executor, Michael Andrew McMullan, to send particulars of such claims to him, in care of the undermentioned solicitors, within two months from the date of publication of this notice, after which date they will distribute the assets, having regard only to the claims of which they then have notice.

GE LAW SERVICES,
110 Kingsway, Glen Waverley, Victoria 3150.

GARY CARMICHAEL, late of Westminster House, 62 Dudley Street, Annerley, Queensland, retired, deceased.

Creditors, next-of-kin and others having claim in respect of the estate of the deceased, who died on 10 November 2021, are required by the executor, Caroline Eliza Grainger, to send particulars to her by 11 July 2022, after which date she may convey or distribute the assets, having regard only to the claims of which she has notice.

GRAINGER LEGAL,
1/40 Forest Street, Castlemaine, Victoria 3450.

Re: PETER RAYMOND EUGENE
TURVEY, deceased.

Creditors, next-of-kin and others having claims in respect of the estate of the deceased, who died on 27 October 2021, are required by the personal representative, Pascale Marie Madeleine Turvey, to send particulars to the personal representative, care of its below lawyers, by 5 July 2022, after which date the personal representative may convey or distribute the assets, having regard only to the claims of which it has notice.

HALL & WILCOX LAWYERS,
Level 11, Rialto South Tower,
525 Collins Street, Melbourne 3000.

Re: CLAIRE ELIZABETH GUMM, late of 12 Maxflo Court, Highett, Victoria 3190.

Creditors, next-of-kin and others having claims in respect of the estate of the deceased, who died on 17 July 2021, are required to send particulars of their claims to the executor,

care of PO Box 32, Highett, Victoria 3190, by 9 July 2022, after which date the executor may convey or distribute the assets, having regard only to the claims of which they may then have notice.

HASSALL'S LITIGATION SERVICES,
308 Highett Road, Highett, Victoria 3190.

Re: Estate of GEOFFREY FREDERICK KNEEBONE.

Creditors, next-of-kin and others having claims against the estate of GEOFFREY FREDERICK KNEEBONE, late of Bupa Coburg, 24 Sutherland Street, Coburg, Victoria, retired engineer, deceased, who died on 20 January 2022, are requested to send particulars of their claims to the executors, care of the undermentioned lawyers, by 13 July 2022, after which date the executors will distribute the assets, having regard only to the claims of which the executors then have notice.

HICKS OAKLEY CHESSELL WILLIAMS,
PO Box 2165, Mount Waverley, Victoria 3149.

Re: JILLIAN MARY YOUNG, late of 2, 69 Curlew Drive, Capel Sound, Victoria, home duties, deceased.

Creditors, next-of-kin and others having claims in respect of the estate of the deceased, who died on 5 November 2021, are required by the trustee, Erica Horsfield, to send particulars to the undermentioned solicitors by 9 July 2022, after which date the trustee may convey or distribute the assets, having regard only to the claims of which the trustee has notice.

Erica Horsfield, trading as
HUNT, McCULLOUGH, KOLLIAS & CO.,
solicitors,
207 Main Street, Mornington, Victoria 3931.

SHIRLEY IDA BELL, late of 10 Ferris Avenue, Box Hill North, Victoria 3129, dressmaker, deceased.

Creditors, next-of-kin and others having claims in respect of the estate of the deceased, who died on 10 November 2021, are required by the personal representative, Kay Lorraine Dixon, to send particulars of such claim to her, care of the undersigned, by 11 July 2022, after which

date the personal representative may convey or distribute the assets, having regard only to the claims of which she then has notice.

HUTCHINSON LEGAL,
38 New Street, Ringwood, Victoria 3134.

ALFRED JOHN BRADLEY, late of 1 Nigel Court, Ringwood, Victoria 3134, retired, deceased.

Creditors, next-of-kin and others having claims in respect of the estate of the deceased, who died on 21 May 2021, are required by the personal representative, Grant John Hutchinson, to send particulars of such claim to him, care of the undersigned, by 8 July 2022, after which date the personal representative may convey or distribute the assets, having regard only to the claims of which he then has notice.

HUTCHINSON LEGAL,
38 New Street, Ringwood, Victoria 3134.

VALDA MABEL INNES, also known as Valda Mabel Wagland, late of Calvary Millward, 31 Blackburn Road, Doncaster East, Victoria 3109, retail assistant, deceased.

Creditors, next-of-kin and others having claims in respect of the estate of the deceased, who died on 10 December 2021, are required by the personal representative, Glen William Innes, to send particulars of such claim to him, care of the undersigned, by 11 July 2022, after which date the personal representative may convey or distribute the assets, having regard only to the claims of which he then has notice.

HUTCHINSON LEGAL,
38 New Street, Ringwood, Victoria 3134.

NOTICE OF CLAIMANTS UNDER TRUSTEE ACT 1958

GIUSEPPE LAURETTA, late of 1 Liverpool Street, Coburg, Victoria, deceased.

Creditors, next-of-kin and others having claims in respect of the estate of the deceased, who died on 3 March 2021, are required by the executor, Francesco Lauretta, to send particulars of their claims to the executor, care of the undermentioned solicitors, within 60 days from the publication hereof, after which date the executor may convey or distribute the assets,

having regard only to the claims of which the executor and his undermentioned solicitors then have notice.

I. GLENISTER & ASSOCIATES, solicitors,
421 Bell Street, Pascoe Vale, Victoria 3044.

**NOTICE OF CLAIMANTS UNDER
TRUSTEE ACT 1958**

PETER ANDREW TRIFFETT, late of TLC Sunlight Residential Aged Care, 43 Laurel Street, Whittlesea, Victoria, deceased.

Creditors, next-of-kin and others having claims in respect of the estate of the deceased, who died on 26 September 2021, are required by the administrator, Carolyn Maree Conway, to send particulars of their claims to the administrator, care of the undermentioned solicitors, within 60 days from the publication hereof, after which date the administrator may convey or distribute the assets, having regard only to the claims of which the administrator and her undermentioned solicitors then have notice.

I. GLENISTER & ASSOCIATES, solicitors,
421 Bell Street, Pascoe Vale, Victoria 3044.

WILLY CORBIER, also known as Wierd Corbier, late of 43 James Cooke Drive, Cranbourne, Victoria, retired, deceased.

Creditors, next-of-kin and others having claims in respect of the estate of the deceased, who died on 26 November 2021, are required by the administrator, William Roger Corbier, to send particulars of such claims to the administrator, care of the undermentioned solicitors, within 60 days from the publication hereof, after which date the administrator will distribute the assets, having regard only to the claims of which the administrator has notice.

KCL LAW,
Level 4, 555 Lonsdale Street, Melbourne 3000.

JUDITH ELLEN GARWOOD, late of Unit 3, 1A Govan Street, Footscray, Victoria 3011, retired, deceased.

Creditors, next-of-kin and all others having claims in respect of the estate of the deceased, who died on 17 March 2022, are required by the executor, Monique Nicole Garwood, to send particulars of such claims to the executor,

care of the undermentioned solicitors, within 60 days from the publication hereof, after which date the executor will distribute the assets, having regard only to the claims of which the executor has notice.

KCL LAW,
Level 4, 555 Lonsdale Street, Melbourne 3000.

Re: JOHN MICHAEL BENNETT, deceased,
of 19 Raymond Road, Seaford, industrial chemist.

Creditors, next-of-kin and others having claims in respect of the estate of the deceased, who died on 7 November 2021, are required to send particulars of their claims to the executor, Rachelle Mary Silverstein, care of 273 Hampton Street, Hampton, Victoria 3188, by 13 July 2022, after which date the executor may convey or distribute the assets, having regard only to the claims of which she may then have notice.

KEITH R. CAMERON SOLICITORS,
273 Hampton Street, Hampton, Victoria 3188.

Re: LYNETTE MARJORY ROGERS, late of 24 Tudawali Crescent, Wheelers Hill, Victoria, retired, deceased.

Creditors, next-of-kin and others having claims in the respect of the estate of LYNETTE MARJORY ROGERS, deceased, who died on 1 February 2022, are required by the trustee, Kathryn Jane Broadbent, to send particulars of their claim to the undermentioned firm by a date not later than two months from the date of publication hereof, after which date the trustee will convey or distribute assets, having regard only to the claims of which she then has notice.

KINGSTON LAWYERS PTY LTD,
barristers and solicitors,
8 Station Road, Cheltenham, Victoria 3192.

GRAEME COLLEN CRAYFORD, late of Unit 19, 8 Munro Street, McMahon's Point, in the State of New South Wales, company director, deceased.

Creditors, next-of-kin and others having claims in respect of the estate of the abovenamed deceased, who died at McMahon's Point, New South Wales, between 1 February 2022 and 3 February 2022, are required by Anthony James

Roberts, the executor and trustee of the estate of the said named deceased, to send particulars of their claims to him, care of the undermentioned solicitor, by 1 August 2022, after which date he may convey or distribute the assets of the estate, having regard only to the claims of which he then has notice.

KIRBY & CO.,
Level 4, 488 Bourke Street, Melbourne 3000.
Ph: 03 9670 9691.

THI HONG LOAN NGUYEN, late of 88 Evans Street, Brunswick in the State of Victoria, manager, deceased.

Creditors, next-of-kin and others having claims in respect of the estate of the abovenamed deceased, who died at Fitzroy, Victoria, on 7 December 2021, are required by Thi Hong Gam Le, the executor and trustee of the estate of the said named deceased, to send particulars of their claims to her, care of the undermentioned solicitor, by 1 August 2022, after which date she may convey or distribute the assets of the estate, having regard only to the claims of which she has notice.

KIRBY & CO.,
Level 4, 488 Bourke Street, Melbourne 3000.
Ph: 03 9670 9691.

JOAN ELIZABETH MAHER, of Cheltenham Manor, 10–12 Bendigo Street, Cheltenham, Victoria 3192, retired, deceased.

Creditors, next-of-kin and others having claims in respect of the estate of the deceased, who died on 12 October 2021, are required by the executors, Elizabeth Mary Bull and Ian Charles Slater, care of the undermentioned solicitors, to send particulars of their claims to them, within 60 days from the date of this notice, after which date the executors may convey or distribute the assets, having regard only to the claims of which they then have notice.

McDONALD, SLATER & LAY, solicitors,
136 Balcombe Road, Mentone 3194.

REBECCA MAY MILNE, late of 25 Seventh Street, Parkdale, Victoria 3195, retired, deceased.

Creditors, next-of-kin and others having claims in respect of the estate of the deceased, who died on 11 August 2021, are required by

the executors, Peter Edmund Thompson and Ian Charles Slater, care of the undermentioned solicitors, to send particulars of their claims to them within 60 days from the date of this notice, after which date the executors may convey or distribute the assets, having regard only to the claims of which they then have notice.

McDONALD, SLATER & LAY, solicitors,
136 Balcombe Road, Mentone 3194.

GEOFFREY TREYVAUD, late of 40 Hill Street, Clifton Springs 3222, unemployed, deceased.

Creditors, next-of-kin and others having claims in respect of the estate of the deceased, who died on 9 March 2022, are required by the executor, David Leigh Treyvaud, to send particulars to him, care of the undermentioned solicitors, by the date not later than 60 days from the date of publication hereof, after which date the executor may convey or distribute the assets, having regard only of the claims of which he then has notice.

MARTIN J. HULL LAWYER,
49 Blake Street, Nathalia, Victoria 3638.

Re: IAN PAUL ROGERS, late of 369 Springfield Road, Nunawading, Victoria.

Creditors, next-of-kin and others having claims in respect of the estate of the deceased, who died on 30 December 2021, are required by the executor, Christanne Smith, to send particulars of such claims to her at the undermentioned address by 6 July 2022, after which date the executor may convey or distribute the assets, having regard only to the claims of which she then has notice.

Christanne Smith, care of
MAURICE BLACKBURN LAWYERS,
Level 21, 380 La Trobe Street, Melbourne 3000.
Tel: 03 9605 2700. Ref: ZTAPP/5683458.

RAYMOND FREDRICK CAPLE, late of 13 Herbert Place, Kurunjang, Victoria, deceased.

Creditors, next-of-kin and others having claims in respect of the estate of the deceased, who died on 11 January 2022, are required by the executor of his estate, Kimberley Raylene Donovan, care of Mills Oakley, Level 6, 530 Collins Street, Melbourne, Victoria, to send particulars to her, within 60 days from the date

of publication of this notice, after which date the executor may convey or distribute the assets, having regard only to the claims of which the executor then has notice.

MILLS OAKLEY,
Level 6, 530 Collins Street, Melbourne 3000.
tpalmer@millsoakley.com.au

DAWN HILDA HARRIS, late of 8 Moores Road, Monbulk, Victoria 3793, clerk, deceased.

Creditors, next-of-kin and others having claims in respect of the estate of the deceased, who died on 5 September 2021, are required by the personal representative, David Gerard Laurence Misso, to send particulars of their claim to him, care of the undermentioned solicitors, by a date not later than two months from the date of publication hereof, after which date he will convey or distribute the assets, having regard only to the claims of which he then has notice.

NEESHAM WHITE GENTLE,
55 Main Street, Monbulk, Victoria 3793.

PENELOPE ANN JACKSON, deceased, formerly of 25 Fowler Street, Moe, but late of Unit 33, 5 Ollerton Avenue, Newborough, Victoria.

Creditors, next-of-kin and others having a claim in respect of the estate of the deceased, who died on 19 December 2021, are required to send written particulars of their claim to the executor, care of PO Box 104, Moe, Victoria 3825, within 60 days from the date of publication of this notice, after which date the executor may convey or distribute the assets, having regard only to the claims of which they may then have notice of.

O'HALLORAN DAVIS, solicitors,
12–14 Kirk Street, Moe 3825.

PASQUALE TIGANI, late of Mecwacare, Elstoft House, 12–14 Beulah Street, Hamlyn Heights, Victoria, deceased.

Creditors, next-of-kin and others having claims in respect of the estate of the abovenamed deceased, who died on 23 February 2021, are required by the trustee, Biagio Giuseppe Tigani, to send particulars of their claims to the trustee, in the care of the undermentioned legal practitioner, within 60 days from the date

of publication of this notice, after which date the trustee may convey or distribute the assets, having regard only to the claims of which he then has notice.

RALPH JAMES SMITH, solicitor,
6 The Centreway, Lara, Victoria 3212.

Re: AUDREY INNES WILLIAMSON, late of 54 Queens Parade, Ashwood, Victoria 3147, nurse, deceased.

Creditors, next-of-kin and others having claims in respect of the estate of the abovenamed deceased, who died on 6 February 2022, are required by the executors, David Gilbert Williamson and Susan Louise Delaney, to send particulars of their claims to them, care of the undermentioned solicitors, by 12 July 2022, after which date they may convey or distribute the assets, having regard only to the claims of which they then have notice.

RENNICK & GAYNOR, solicitors,
431 Riversdale Road, Hawthorn East,
Victoria 3123.
Ref: AE: 222827. Tel: 03 9861 7720.

Re: CAMPBELL THOMAS MARSH, deceased.

Creditors, next-of-kin and others having claims in respect of the estate of the deceased, who died on 30 December 2021, are required by the trustees, Rowan William Marsh and Glenda Shirley Marsh, to send particulars of such claims to them, in care of the below mentioned lawyers, by 7 July 2022, after which date the trustees may convey or distribute the assets, having regard only to the claims of which they then have notice.

ROBERTS BECKWITH PARTNERS,
16 Blamey Place, Mornington, Victoria 3931.

HUAN SINH NGAN, late of 37 Chirnside Street, Kingsville, Victoria 3012, business owner, deceased.

Creditors, next-of-kin and others having claims in respect of the estate of the abovenamed deceased, who died on 30 January 2022, are required by the executor, Anh Minh Nguyen, to send particulars of their claims to the undermentioned solicitors within 60 days from the date of publication hereof, after which date

the said executor may convey or distribute the estate, having regard only to the claims of which she then has notice.

RYDGE EVANS LAWYERS,
Level 4, 44 Pitt Street, Sydney,
New South Wales 2000.
Contact: May Tai.

executor, Julie Ann Esparon, to send particulars to her, care of the undermentioned solicitors, by 11 July 2022, after which date the executor may convey and distribute the assets, having regard only to the claims of which she then has notice.

TRAGEAR & HARRIS LAWYERS,
1/23 Melrose Street, Sandringham 3191.

Re: Estate of ROMUALDAS GREIMAS.

Creditors, next-of-kin and others having claims in respect of the estate of ROMUALDAS GREIMAS, late of 49 Morang Road, Hawthorn, Victoria, who died on 4 March 2022, are required by the personal representative of the deceased, Andrew Domasevicius-Zilinskas, the executor of the estate, to send particulars to him at the below address by 31 August 2022, after which date he will distribute the assets of the deceased, having regard only to the claims of which he then shall have notice.

SOMERSWOOD LAWYERS,
56 Somers Street, Burwood, Victoria 3125.
Ref: 1302/Greimas.

Re: RITA VOROK, late of Emerald Hill Residence, 203 Napier Street, South Melbourne, home duties, deceased.

Creditors, next-of-kin and others having claims in respect of the estate of the deceased, who died on 24 February 2021, are required by the administrators, Elizabeth Bassios and Christopher Bassios, to send particulars to them, care of the undermentioned lawyers, by a date not later than two months from the date of publication hereof, after which date the administrators will convey or distribute the assets, having regard only to the claims of which they then have notice.

SUZANNE LYTTLETON LAWYERS,
PO Box 2181, St Kilda West, Victoria 3182.
Telephone: 9646 4477.

Re: LEONIE ROSE KEARNS, also known as Gwendolene Leonie Rose Kearns, late of Abberfield Aged Care Facility Sandringham, 378 Bluff Road, Sandringham, Victoria 3191, retired, deceased.

Creditors, next-of-kin and others having claims in respect of the estate of the deceased, who died 6 March 2022, are required by the

GOVERNMENT AND OUTER BUDGET
SECTOR AGENCIES NOTICES



City of
KINGSTON

ROAD DISCONTINUANCE

At its meeting of 26 April 2022 Council, acting under section 206 and Schedule 10, Clause 3 of the **Local Government Act 1989**, has resolved to discontinue the road cross-hatched and sell by private treaty.

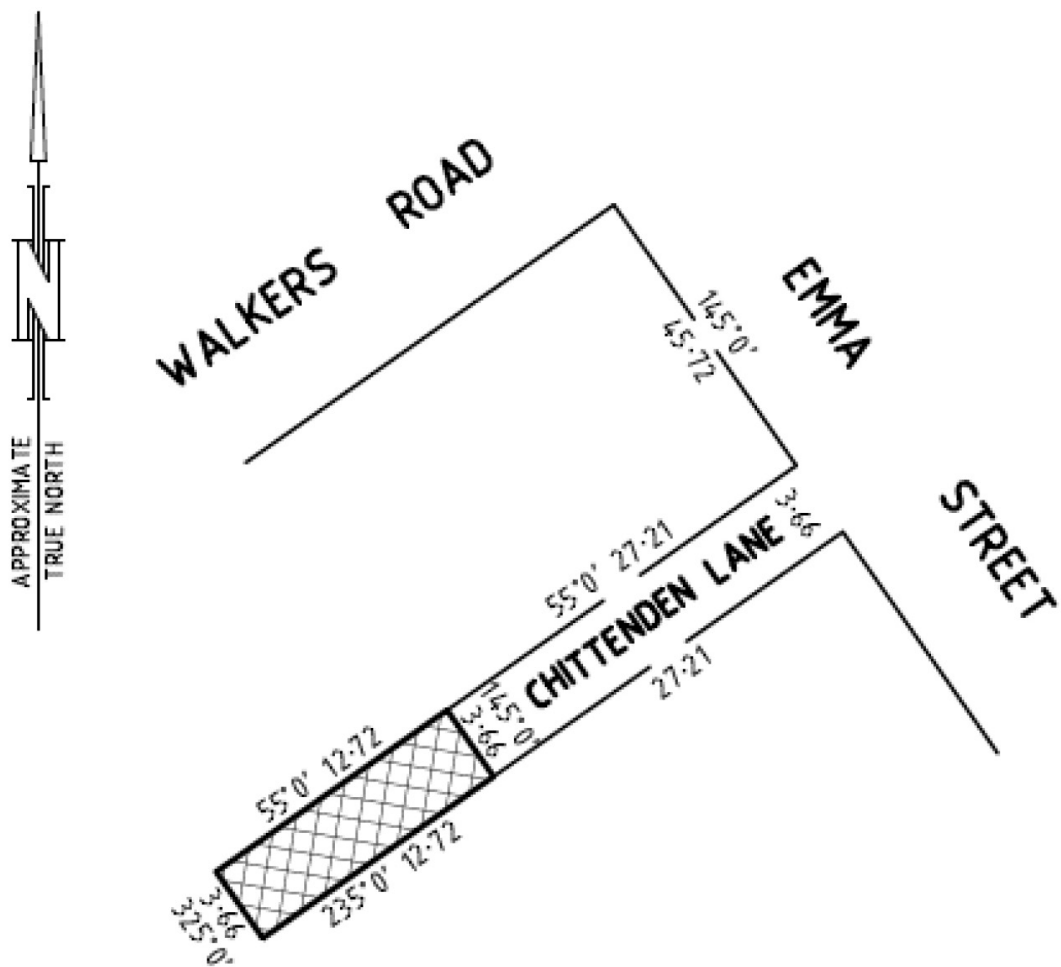

PETER BEAN
Chief Executive Officer
Kingston City Council



ROAD DISCONTINUANCE

Pursuant to section 206(1), 207b and Clause 3 of Schedule 10 of **Local Government Act 1989**, the Macedon Ranges Shire Council at its meeting held on 1 May 2020 declared the section shown as hatched on the plan below and known as R1 PS 128687, is not reasonably required as a road for public use and resolved to discontinue the road and sell the land to an adjoining owner. The land will be consolidated with the abutting land.

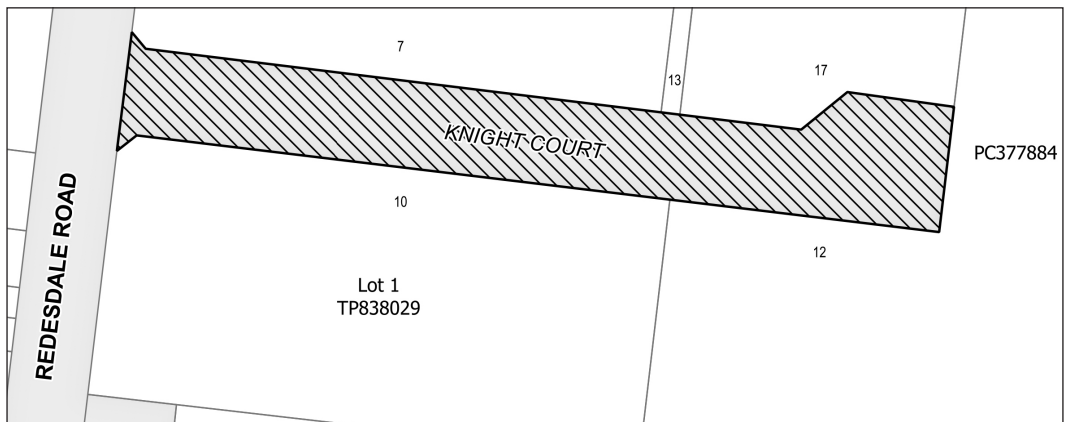

Cardinia

PROPOSED ROAD MANAGEMENT PLAN

Seeking Community Input

In accordance with section 54(4) of the **Road Management Act 2004** and the Road Management (General) Regulations 2016, Cardinia Shire Council gives notice of its intention to conduct a review of its Road Management Plan.

Cardinia Shire Council ('Council') is proposing to:

- revoke the Road Management Plan which it made on 10 December 2018; and
- make a new Road Management Plan ('the proposed RMP').

The purpose of the proposed RMP is to detail Council's road management functions, set standards for the performance of these functions, base the standards on policy and operational objectives within the resources available and ensure the provision of a safe and efficient road network for use by road users and the community as a whole.

If made, the proposed RMP will:

- set out a schedule of maintenance standards for road pavements and surfaces, pathways, bridges, traffic signs and road-related drainage infrastructure;
- outline a workflow process and schedule for inspections, work planning, repairs, maintenance and monitoring of these assets; and
- refer to Council's register of public roads.

The proposed Road Management Plan can be inspected or obtained at Council's Customer Service Centre at 20 Siding Avenue, Officer, or accessed on Council's website at www.cardinia.vic.gov.au/haveyoursay

Any person can make a submission on the proposed RMP. Submissions must be lodged within 28 days of the publication of this notice.

Please address to: Coordinator Optimisation, Operational Planning and Support, Cardinia Shire Council, PO Box 7, Pakenham, Victoria 3810.

NOTE: The classification of specific roads will not be considered as part of this process. Submissions should be limited to issues relating to the RMP and standards/processes detailed within.

A person who has made a submission and requested that they be heard in support of their submission is entitled to appear in person or by a person acting on their behalf, the day, time and place of which will be advised.

For further information contact Coordinator Optimisation, Operational Planning and Support on 1300 787 624.

CAROL JEFFS
Chief Executive Officer

Planning and Environment Act 1987

BOROONDARA PLANNING SCHEME

Notice of the Preparation of an Amendment Amendment C367boro

The Boroondara City Council has prepared Amendment C367boro to the Boroondara Planning Scheme.

The land affected by the Amendment is 57 and 60 Berkeley Street, Hawthorn.

The Amendment proposes to apply the Heritage Overlay to 57 Berkeley Street, Hawthorn (HO938) and 60 Berkeley Street, Hawthorn (HO939) on a permanent basis.

You may inspect the Amendment, any documents that support the Amendment and the explanatory report about the Amendment, free of charge, at: the Boroondara City Council website at www.boroondara.vic.gov.au/C367boro; during office hours, at the office of Boroondara City Council, 8 Inglesby Road, Camberwell; or at the Department of Environment, Land, Water and Planning website, www.delwp.vic.gov.au/public-inspection

Any person who may be affected by the Amendment may make a submission to the planning authority about the Amendment. Submissions must be made in writing giving the submitter's name and contact address, clearly stating the grounds on which the Amendment is supported or opposed and indicating what changes (if any) the submitter wishes to make.

Name and contact details of submitters are required for Council to consider submissions and to notify such persons of the opportunity to attend Council meetings and any public hearing held to consider submissions. The closing date for submissions is 14 June 2022. A submission must be sent to the Boroondara City Council, via the online form at www.boroondara.vic.gov.au/C367boro or by mail to Private Bag 1, Camberwell, Victoria 3124.

The planning authority must make a copy of every submission available at its office and/or on its website for any person to inspect, free of charge, for two months after the Amendment comes into operation or lapses.

PHILLIP STORER
Chief Executive Officer
Boroondara City Council

Creditors, next-of-kin and others having claims against the estate of any of the undermentioned deceased persons are required to send particulars of their claims to State Trustees Limited, ABN 68 064 593 148, of 1 McNab Avenue, Footscray, Victoria 3011, the personal representative, on or before 14 July 2022, after which date State Trustees Limited may convey or distribute the assets, having regard only to the claims of which State Trustees Limited then has notice.

ALLEN, Edward John, also known as Edward Allen, late of Unit 23, 10 Guildford Lane, Melbourne, Victoria 3000, deceased, who died on 11 January 2022.

JONES, Margaret Elizabeth, late of 18 Watt Street, Murgon, Queensland 4605, deceased, who died on 28 May 1989.

KELSEN, Douglas Johan, late of Unit 4, 44 Dunlop Avenue, Ascot Vale, Victoria 3032, deceased, who died on 29 July 2021.

MUNIVAI, Annette, also known as Annette Carmel Munivai, late of Unit 1, 18 Toolern Street, Melton South, Victoria 3338, deceased, who died on 9 December 2021.

ROGERS, Doreen Mary, late of 53 Franleigh Drive, Narre Warren, Victoria 3805, home duties, deceased, who died on 28 July 2021.

SOPP, Brunhilde, late of Uniting AgeWell, Manor Lakes Nursing Home, 15 Buffalo Crescent, Wyndham Vale, Victoria 3024, deceased, who died on 27 April 2021.

Dated 5 May 2022

EXEMPTION

Application No. H12/2022

The Victorian Civil and Administrative Tribunal has considered an application pursuant to section 89 of the **Equal Opportunity Act 2010** (the Act) by Emma House Domestic Violence Service (the applicant). The applicant has amended its initial application and now seeks an exemption to allow it: to only assist women or persons who identify as women and their children experiencing domestic and family violence, and to only employ women or persons who identify as women (the exempt conduct).

Upon reading the material filed in support of this application, including the affidavits of Cristie Lee Brian, joint acting chief executive officer, and Joanna Doman, quality compliance manager, and the written submissions and documents filed in support of the application, the Tribunal is satisfied that it is appropriate to grant an exemption from sections 16, 44, 107 and 182 of the Act to enable the applicant to engage in the exempt conduct.

In granting this exemption, the Tribunal noted:

- The applicant was established in 1979 as a feminist organisation operated by women with a vision of a society where women and children live lives free from violence. The applicant's purpose is to provide support and assistance to women and their accompanying children who are experiencing or have experienced domestic and/or family violence.
- The applicant is the primary specialist domestic and family violence service in Southwest Victoria. It provides services including case management, crisis accommodation, court support, legal program, personal safety initiative and a children's program. During 2020–2021, the applicant provided assistance to 2,804 female victim survivors.

- The applicant seeks to limit its services to female victim survivors because the significant majority of victim survivors are women and children. Statistics referred to in the reports submitted in support of the application indicate that women are nearly three times more likely than men to experience violence by a current or former partner, and that there is an urgent and immediate need for female victim survivors to access specialist family violence services in an environment that feels safe.¹
- The applicant recognises the disproportionate impact of family violence on women by focusing on providing an environment in which female victim survivors feel comfortable and unintimidated and above all safe. The applicant aims to provide a safe space for female victim survivors to seek support and assistance. To deliver its services effectively, the applicant considers it is necessary that the services and space in which they are provided are restricted to females only. The applicant provides mostly face-to-face services and is concerned that fewer females will access their services if males are present. Feedback from service users supports this approach.
- While some of the applicant's services may be characterised as special services for special needs as set out in section 88 of the Act, and some of the front-line employment positions may come under the exception in section 28, I am not satisfied that all employment positions would come under the exceptions in the Act, and therefore, in the absence of an exemption, the exempt conduct would amount to prohibited discrimination.
- Given the target group for the services offered, and the safe space face-to-face service delivery model used by the applicant, I am satisfied the services offered by the applicant can be most effectively provided by an organisation that employs women only.

¹ Summary and Recommendations from the Royal Commission into Family Violence March 2016, Practice Guidelines: Women and children's family violence counselling and support programs, safety, dignity, empowerment and human rights Victorian Government Project 2008, Women's Legal Service Policy Paper 1 Police Misidentification of the primary aggressor in family violence incidents in Victoria July 2018.

- When making decisions about exemptions, the Tribunal is required to give proper consideration to relevant human rights as set out in the **Charter of Human Rights and Responsibilities Act 2006** (the Charter). This exemption limits the right to equality and in particular the right to equal and effective protection against discrimination of persons who do not identify as women, who wish to be employed by the applicant. I note this exemption will not preclude potential job seeker from seeking employment with other services. I am satisfied that, in the circumstances discussed above, the limit imposed by this exemption is reasonable and justified under the Charter.

The Tribunal hereby grants an exemption from the operation of sections 16, 44, 107 and 182 of the Act to enable the applicant to engage in the exempt conduct.

This exemption is to remain in force from the day on which notice of the exemption is published in the Government Gazette until 12 May 2027.

Dated 12 May 2022

C. THWAITES
Member

Education and Training Reform Act 2006

Pursuant to section 2.6.46 of the **Education and Training Reform Act 2006** (the Act) a Formal Hearing Panel of the Victorian Institute of Teaching (the Institute) may find that a registered teacher has engaged in misconduct or serious misconduct or is not fit to teach, and may make a determination pursuant to subsection 2.6.46(2) to cancel, suspend or impose conditions on the registration of the teacher.

On 1 April 2022, a formal hearing panel determined that Mr Michael James McIntyre (registration number 157087), had engaged in serious misconduct and was not fit to teach. The panel determined to cancel his teaching registration and disqualify him from applying for registration for a period of two years from 1 April 2022 to 1 April 2024. The formal hearing panel made this decision pursuant to sections 2.6.46(2)(j) and 2.6.46(2)(k) of the Act.

Education and Training Reform Act 2006

Pursuant to section 2.6.29(1)(b) of the **Education and Training Reform Act 2006** ('the Act'), all registrations held by a person under Part 2.6 of the Act are cancelled if the person has been given a Working with Children exclusion under the **Worker Screening Act 2020**.

On 9 May 2022, Alexander George Hayes, a teacher registered in Victoria, was given a Working with Children exclusion. On this day, being 9 May 2022, Alexander George Hayes' registration was cancelled in accordance with section 2.6.29(1)(b) of the Act, and he was disqualified from teaching in a school or an early childhood service in accordance with section 2.6.29(3)(b) of the Act for a period of five years after the date on which the Working with Children exclusion was given, unless the Working with Children exclusion is subsequently set aside or he is given a Working with Children clearance.

Education and Training Reform Act 2006**NOTICE OF TRAINING PRODUCT TRANSITION PERIOD END DATE EXTENSIONS**

In accordance with section 4.3.17A of the **Education and Training Reform Act 2006** (Act), the Victorian Registration and Qualifications Authority gives notice of training products from superseded training packages that have been approved for extensions to transition period end dates. The following training products have been provided with new transition period end dates within the meaning of section 4.3.17A of the Act.

Training Product	Transition Period End Date
CPP40516 Certificate IV in Strata Community Management	15/04/2023
FNS42115 Certificate IV in Personal Injury Management	1/08/2022
RHI30919 Certificate III in Civil Construction	24/07/2022
TLI32515 Certificate III in Rail Infrastructure	30/06/2022
TLILIC0002 Licence to operate a vehicle loading crane (capacity 10 metre tonnes and above)	31/05/2022
TLILIC0012 Licence to operate a vehicle loading crane (capacity 10 metre tonnes and above)	31/05/2022
TLILIC0006 Licence to operate a bridge and gantry crane	31/05/2022
TLILIC0007 Licence to operate a derrick crane	31/05/2022
TLILIC0008 Licence to operate a non-slewing mobile crane (greater than 3 tonnes capacity)	31/05/2022
TLILIC0009 Licence to operate a portal boom crane	31/05/2022
TLILIC0010 Licence to operate a slewing mobile crane (up to 20 tonnes)	31/05/2022
TLILIC0013 Licence to operate a slewing mobile crane (up to 60 tonnes)	31/05/2022
TLILIC0014 Licence to operate a slewing mobile crane (up to 100 tonnes)	31/05/2022
TLILIC0015 Licence to operate a slewing mobile crane (over 100 tonnes)	31/05/2022
HLT35015 Certificate III in Dental Assisting	30/04/2023
HLT45015 Certificate IV in Dental Assisting	30/06/2023
PMB30116 Certificate III in Polymer Processing	16/12/2022
PMB40116 Certificate IV in Polymer Technology	16/02/2023

Details of the training products with extended transition periods can be obtained from the Victorian Registration and Qualifications Authority, GPO Box 2317, Melbourne, Victoria 3001; web: www.vrqa.vic.gov.au; email: vrqa.vet@edumail.vic.gov.au; or telephone: 03 9603 7917.

Emergency Services Superannuation Act 1986**ELECTION OF 3 CONTRIBUTOR MEMBERS AND 3 DEPUTY CONTRIBUTOR MEMBERS OF THE EMERGENCY SERVICES SUPERANNUATION BOARD**

Notice is given of an election for three positions of ‘Contributor Members of the Board’ and three positions of ‘Deputy Contributor Members of the Board’ to represent the contributor members of the Emergency Services Superannuation Scheme, in accordance with sections 7 and 9 of the **Emergency Services Superannuation Act 1986** (ESSA).

The elected members will be required to fulfil the duties of ‘Contributor Members of the Board’/‘Deputy Contributor Members of the Board’ and will be appointed to that office from 1 January 2023 for a term not exceeding five years.

Elections will be held for:

1. One Contributor Member of the Board elected by contributors who are employed under the **Victoria Police Act 2013** or by the employee organisations representing those contributors.
2. One Deputy to the Contributor Member of the Board who is nominated and elected in the same manner as the Contributor Member of the Board in paragraph one.
3. One Contributor Member of the Board elected by contributors who are officers or employees of the Fire Rescue Victoria or persons appointed by the Country Fire Authority under section 17 of the **Country Fire Authority Act 1958** or the employees of the unions representing those contributors.
4. One Deputy to a Contributor Member of the Board to be nominated and elected in the same manner as the Contributor Member of the Board in paragraph three.
5. One Contributor Member of the Board elected by contributors who are employees appointed by Ambulance Services Victoria under the **Ambulance Services Act 1986** or by any other ambulance service specified by the Minister under the ESSA and by contributors who are not employees of participating employers referred to in paragraphs one and three above.
6. One Deputy to a Contributor Member of the Board to be nominated and elected in the same manner as the Contributor Member of the Board in paragraph five.

The election will be conducted in accordance with the Emergency Services Superannuation Board Election Procedures.

Nominations are to be on the approved Nomination Form and must be received by the Returning Officer, Mr Roger Millar, Victorian Electoral Commission, Level 11, 530 Collins Street, Melbourne 3000 or emailed to clientliaison@vec.vic.gov.au, no later than 12 noon on Thursday 26 May 2022. Please note that nomination forms can be accepted by mail, email or hand-delivered to the Returning Officer.

Nomination forms and further information regarding the election may be obtained from the Victorian Electoral Commission (VEC) by telephoning 03 8620 1341.

If a ballot is necessary to decide the election, a ‘draw’ to determine the candidates’ positions on the ballot paper will be conducted at the VEC at 2 pm on Friday 27 May 2022.

Ballot material will be posted to members on Wednesday 15 June 2022 and voting will close at 5 pm on Thursday 14 July 2022.

Dated 12 May 2022

DAVID DALEY
Acting Chief Executive Officer
Emergency Services Superannuation Board

Fisheries Act 1995**FURTHER QUOTA ORDER UNDER SECTION 64A FOR THE
EASTERN OCTOPUS ZONE OF THE VICTORIAN OCTOPUS FISHERY**

I, Chris Padovani, Acting Director Fisheries Management, Policy, Science, Licencing and Communications, Victorian Fisheries Authority, as delegate of the Minister for Fishing and Boating and having undertaken consultation in accordance with section 3A of the **Fisheries Act 1995** (the Act), make the following Further Quota Order under section 64A of the Act for the eastern octopus zone of the Victorian octopus fishery.

1. This Further Quota Order applies for the period commencing 1 July 2022 and ending on 30 June 2023, both dates inclusive (the quota period).
2. The total allowable catch in the eastern octopus zone for the Victorian octopus fishery for the quota period is 68.7 tonnes.
3. The quantity of octopus comprising a quota unit in the eastern octopus zone for the quota period is 68.7 kilograms.

This Order commences on 1 July 2022 and remains in force until the end of 30 June 2023.

Notes:

There are 1000 individual quota units for the eastern zone of the Octopus Fishery.

No Octopus Fishery Access Licences authorising fishing in the central octopus zone or the western octopus zone of the Victorian octopus fishery are to be issued until further notice, under a Ministerial Direction pursuant to section 61 of the **Fisheries Act 1995**.

Dated 4 May 2022

CHRIS PADOVANI
Acting Director Fisheries Management
Policy, Science, Licencing and Communications
Victorian Fisheries Authority

FORM 7

Regulation 16

Land Acquisition and Compensation Act 1986**Notice of Acquisition****Compulsory Acquisition of Interest in Land**

The Minister for Energy, Environment and Climate Change declares that by this notice it acquires the following interest in the land described as:

- Lot 1 on Title Plan 959825M contained in Certificate of Title Volume 11692 Folio 615 (situated at 1625A Boundary Road, Mount Cottrell, Victoria 3024);
- Crown Allotment A1, Section 25, Parish of Tarneit contained in Certificate of Title Volume 9581 Folio 975 (situated at 1645 Boundary Road, Mount Cottrell, Victoria 3024);
- Crown Portion 6, Section 3, Parish of Pywheittjorrk contained in Certificate of Title Volume 11032 Folio 295 (situated 1884–1908 Boundary Road, Mount Cottrell, Victoria 3024);
- Lot 1 on Plan of Subdivision 96268 contained in Certificate of Title Volume 8956 Folio 613 (situated at 1884–1908 Boundary Road, Mount Cottrell, Victoria 3024);
- Lot 2 on Plan of Subdivision 96268 contained in Certificate of Title Volume 8956 Folio 614 (situated at 1884–1908 Boundary Road, Mount Cottrell, Victoria 3024);
- Lot 1 on Title Plan 897485C contained in Certificate of Title Volume 8120 Folio 628 (situated at 1884–1908 Boundary Road, Mount Cottrell, Victoria 3024);
- Lot 1 on Title Plan 384637R contained in Certificate of Title Volume 11032 Folio 294 (situated at 1884–1908 Boundary Road, Mount Cottrell, Victoria 3024);

- Lot 1 on Title Plan 412561X contained in Certificate of Title Volume 4829 Folio 635 (situated at 1884–1908 Boundary Road, Mount Cottrell, Victoria 3024); and
- Lot 1 on Title Plan 78347J contained in Certificate of Title Volume 11054 Folio 489 (situated at 643–709 Downing Street, Mount Cottrell, Victoria 3024).

The estate in fee simple of the registered proprietor Mount Cottrell Properties Pty Ltd (A.C.N 609 267 870), and all other interests other than the rights of APA VTS Australia (Operations) Pty Limited as described in creation of easement instruments AF647545G, AF388252P and E485687.

The acquisition is made pursuant to section 5(4) of the **Crown Land (Reserves) Act 1978** for the purpose of the Western Grassland Reserve.

A notice of intention to acquire the interest in the land was served on the registered proprietor on 19 February 2021 (and extended by agreement), and on other interests on 15 November 2021.

Published with the authority of the Minister for Energy, Environment and Climate Change.

For and on behalf of the Minister for Energy, Environment and Climate Change

Signed: JAMES TODD

Name: James Todd

Executive Director, Biodiversity

Department of Environment, Land, Water and Planning

Date 5 May 2022

Marine Safety Act 2010

Section 208(2)

NOTICE OF BOATING ACTIVITY EXCLUSION ZONE

City of Ballarat as the declared waterway manager for Lake Wendouree hereby gives notice under section 208(2) of the **Marine Safety Act 2010** that all persons and vessels not registered to take part in the Rowing Victoria, Australian Rowing Masters 2022 are prohibited from entering and remaining in the following waters.

Waters of Lake Wendouree – Entire Lake.

The exclusion zone will be in effect from 6.00 am Wednesday 18 May 2022 to 6.00 pm Sunday 22 May 2022.

Dated 12 May 2022

BY ORDER OF CITY OF BALLARAT

Marine Safety Act 2010

DECLARATION OF BOATING ACTIVITY EXEMPTION

City of Ballarat as the declared waterway manager for Lake Wendouree, makes the following declaration under section 203(3) of the **Marine Safety Act 2010**.

For the purposes of boating activity conducted by Rowing Victoria, persons and vessels involved in the Australian Rowing Masters 2022 are exempt from the following requirements:

State Rules made under the Marine Act 1988

1. Clause 2(c) – must not exceed 5 knots within 50 metres of another vessel.
2. Clause 3(a) – must not exceed 5 knots within 50 metres of the water's edge.

Waterway Rules made under the Marine Safety Act 2010 / Marine Act 1988

3. Clause 42.1 of Schedule 42 – 5 knot speed restriction for all the waters of Lake Wendouree for vessels equipped with engines used for propulsion.

Subject to the conditions detailed below:

- Masters of rescue vessels are only exempt from items 1 to 3 when undertaking a rescue operation to retrieve persons in distress, provide for their initial medical or other needs and deliver them to a place of safety on shore.
- Masters of competing vessels are only exempt from item 1 for the duration of the events.
- Masters of marshal/umpire vessels are only exempt from items 1 and 3 when following competing vessels in a race or at the conclusion of a race when returning to the start line for the next race and must not exceed the speed of a competing rowing vessel.
- Occupants of powered vessels used in conjunction with the event must wear a personal flotation device at all times.
- The event is operating under the auspices of Rowing Victoria, including the Rowing Victoria Safety Management Plan, which meets the criteria of Clause 3 of the Exemption Notice made under the Marine Regulations 1999 in respect of the exemption for rowing vessels to not carry or wear a personal flotation device.
- The exemptions apply from 6.00 am Wednesday 18 May 2022 to 6.00 pm on Sunday 22 May 2022 within the exclusion zone waters – on the whole of Lake Wendouree.
- The exemptions apply provided the stated safety controls and undertakings detailed in the application form and associated documentation are adhered to.

Dated 12 May 2022

BY ORDER OF CITY OF BALLARAT



Pharmacy Regulation Act 2010

VICTORIAN PHARMACY AUTHORITY STANDARDS

Under section 86(3) of the **Pharmacy Regulation Act 2010** (the Act), on 28 March 2022 the Minister for Health approved standards entitled Victorian Pharmacy Authority Standards prepared by the Victorian Pharmacy Authority (the Authority) under section 86(1) of the Act.

The Authority is authorised to issue standards under section 86(1) of the Act.

The Authority must publish any standard approved by the Minister in the Government Gazette.

The Victorian Pharmacy Authority Standards take effect on 12 May 2022.

AARON BAWDEN

Registrar

Victorian Pharmacy Authority

VICTORIAN PHARMACY AUTHORITY STANDARDS

INTRODUCTION AND INTERPRETATION

About the Victorian Pharmacy Authority

The Victorian Pharmacy Authority ('the Authority') has important functions and powers under the **Pharmacy Regulation Act 2010** ('the Act') which regulates the ownership and operation of pharmacy businesses, pharmacy departments and pharmacy depots.

The Authority's functions and powers under the Act include:

- licensing a person to carry on a pharmacy business or a pharmacy department;
- registering the premises of pharmacy businesses, pharmacy departments and pharmacy depots, herein collectively referred to as registered premises unless specified individually;

- maintaining a public register of all licensees and registered premises;
- issuing standards in relation to the operation of pharmacies, pharmacy businesses, pharmacy departments and pharmacy depots;
- inspecting registered premises to ensure that standards are being met and maintained.

Scope and application of the Standards

These standards, issued by the Authority ('the Standards'), have been approved by the Victorian Minister for Health as required under section 86 of the Act.

The Standards reflect the requirements of the Act, including the Schedule to the Act and are supported by the Victorian Pharmacy Authority Guidelines ('the Guidelines'). They should be read in conjunction with these documents.

In undertaking its functions under the Act, the Authority must have regard to the need to maintain standards, which help to ensure the facilities, equipment, security, management and operation of the registered premises comply with the Act and good pharmacy practice.

In relation to good pharmacy practice, the Authority recognises the standards, codes, guidelines and policies issued by the Pharmacy Board of Australia and has regard to standards, codes and guidelines issued by the Pharmaceutical Society of Australia, The Society of Hospital Pharmacists of Australia, Victorian Department of Health and Therapeutic Goods Administration.

These Standards apply to all registered premises in Victoria, except where specifically excluded. The licensee is responsible for meeting the Standards.

What happens if the Standards are not met?

The Authority may investigate a matter based on a notification of an alleged contravention of an Authority standard or if there is evidence of a contravention (sections 53 and 54 of the Act). The Authority may, among other things, convene a panel hearing in respect of matters that have been the subject of an investigation (section 57 of the Act). The Authority may revoke a licence or a registration if the licensee has contravened a standard on one or more occasions and the Authority believes it is against the public interest for that person to continue carrying on a pharmacy business or pharmacy department, or a breach of the Standards presents a serious risk to public safety (section 55 of the Act).

Structure of the Standards

The Standards are grouped into categories and sub-categories as follows:

1. Licensee responsibilities	2. Premises
1.1 Compliance	2.1 Essential and ongoing requirements
1.2 Management	2.2 Alterations
1.3 Records	2.3 Security
1.4 Policies and procedures	2.4 Design, layout and condition
1.5 Quality improvement and risk management	2.5 Equipment
	2.6 Reference texts

The categories include an overlying principle which describes the desired outcome which will be achieved by compliance with the Standards.

KEY TERMS

Term	Meaning in the document
Complex compounding	<p>refers to compounding, which is the extemporaneous preparation and supply of a single ‘unit of issue’ of a therapeutic product intended for supply for a specific patient in response to an identified need, and which requires or involves special competencies, equipment, processes and/or facilities [or as defined in the current edition of the Australian Pharmaceutical Formulary and Handbook (APF)]. Examples of complex compounded products include:</p> <ul style="list-style-type: none"> • sterile products; • products containing ingredients that pose a work health and safety hazard (e.g., cytotoxics, hormones, gene therapy); • monoclonal antibodies; • single-unit dosage forms containing less than 25 mg (or up to 25% by weight or volume) of active ingredient; • sustained-release or other modified-release products; • capsules that contain more than one ingredient; • tablets; • troches, suppositories or pessaries.
Current reference texts	include any essential reference texts specified by the Pharmacy Board of Australia.
Drugs and Poisons legislation	refers to the Drugs, Poisons and Controlled Substances Act 1981 and any regulations made under this Act.
Pharmacist regularly and usually in charge (PRUIC)	is the pharmacist who is regularly and usually in charge of the registered premises and can be the proprietor or a pharmacist appointed to that position.
Pharmacy services	<p>includes the supply, compounding and dispensing of medicines, the provision of advice and counselling on the effective and safe use of medicines and a wider range of specific pharmacy services to support these functions, including those which may emerge as practice evolves, such as, but not limited to:</p> <ul style="list-style-type: none"> • compounding (including complex compounding); • medication assisted treatment for opioid dependence (MATOD); • dose administration aids; • administration of medicines by injection.
Registered premises	refers to pharmacies, pharmacy departments or pharmacy depots, as defined under the Act, which are registered by the Authority.

THE STANDARDS

1. LICENSEE RESPONSIBILITIES**Principle**

The licensee is responsible for the delivery of pharmacy services that, through appropriate governance and oversight, are consistent with the law and good pharmacy practice. Public safety is paramount and the risk of causing harm must always be considered as part of the delivery of pharmacy services.

The licensee holds responsibility for the carrying on of a pharmacy business, pharmacy department or pharmacy depot in accordance with the Act.

Where there is a partnership, the responsibility is not held just by one single individual, but by each of the partners.

Governance arrangements include having clear definitions of the roles and accountabilities for the people involved in providing and managing pharmacy services. It also includes the arrangements for managing risks, and the way the registered premises is managed and operated.

1.1. Compliance

The licensee is responsible for:

1.1.1.	compliance with the requirements of the Act, the Standards and any conditions imposed by the Authority
1.1.2.	ensuring that the delivery of pharmacy services complies with relevant legislation, and follows good pharmacy practice
1.1.3.	ensuring that all medicines and poisons are managed in accordance with legislation and good pharmacy practice.

1.2. Management

The licensee shall provide for the appropriate management of the pharmacy business, pharmacy department or pharmacy depot by:

1.2.1.	a) acting as the pharmacist regularly and usually in charge, or b) appointing a pharmacist to be regularly and usually in charge, and c) notifying the Authority, in each case
1.2.2.	ensuring that employed pharmacists hold appropriate and current registration
1.2.3.	ensuring that all staff are suitably qualified and trained
1.2.4.	ensuring that there are enough suitably qualified and trained staff to support service demands and the safe and effective provision of pharmacy services
1.2.5.	ensuring that staff comply with professional and legal obligations
1.2.6.	ensuring that staff have access to current reference texts.

1.3. Records

The licensee is responsible for ensuring that:

1.3.1.	records relating to pharmacy services are created, stored and retained in accordance with relevant legislation and good pharmacy practice
1.3.2.	records containing consumers' personal and health information are secure from theft, misuse, interference, loss, unauthorised access, modification or disclosure
1.3.3.	records for Schedule 8 and 9 poisons are in accordance with Drugs and Poisons legislation.

1.4. Policies and procedures

The licensee is responsible for ensuring that:

1.4.1.	there are policies and procedures in place which are relevant to the services provided and activities being undertaken at the registered premises
1.4.2.	policies and procedures are clearly documented, easily accessible, regularly reviewed and updated as part of effective governance arrangements
1.4.3.	policies and procedures are readily available to all staff and are being followed.

1.5. Quality improvement and risk management

The licensee is responsible for ensuring that there are appropriate systems in place to:

1.5.1.	monitor and review the safety and quality of pharmacy services as part of ongoing improvement activities
1.5.2.	identify, investigate and monitor incidents, adverse events and near misses
1.5.3.	identify and manage the risks associated with providing pharmacy services.

2. PREMISES

Note: This category does not apply to pharmacy depots (refer to section 48 of the Act and the Schedule to the Act).

Principle

The design, condition, facilities and security of registered premises provide an appropriate environment for the safe custody of medicines and poisons and provision of pharmacy services.

The licensee holds responsibility for ensuring that registered premises comply with the Standards.

2.1. Essential and ongoing requirements

The Schedule to the Act sets out matters required in relation to registered premises such as layout, hygiene, temperature control and security and access.

2.1.1.	Registered premises shall comply with relevant requirements of the Schedule to the Act on an ongoing basis.
2.1.2.	Registered premises shall be maintained in an organised, uncluttered state.

2.2. Alterations

Registered premises should be suitable for the provision of pharmacy services. By approving significant alterations to registered premises, the Authority can ensure that the premises remain suitable and do not present a risk to public safety. The Authority provides information regarding significant alterations in the Guidelines.

2.2.1.	Authority approval shall be obtained prior to making any significant alteration to registered premises.
--------	---

2.3. Security

Registered premises shall be secure and safeguarded from unauthorised access.

2.3.1.	The doors, windows, skylights, walls and ceilings of registered premises shall be substantially constructed and secured to prevent unauthorised access.
2.3.2.	There shall be adequate perimeter security measures in place to prevent and deter unauthorised access.

2.3.3.	The registered premises shall be fitted with a functional, 24-hour monitored intrusion detector alarm which: a) is monitored by an appropriately graded monitoring centre or an onsite security service approved by the Authority in special circumstances, and b) covers all areas where medicines and poisons are kept.
---------------	---

2.4. Design, layout and condition

2.4.1.	The dispensary shall be a private area, dedicated to tasks associated with the dispensing, supply and compounding of medicines and secure storage of medicines and patient records.
2.4.2.	The dispensary shall be fitted with: a) a sink with integrated drainer, that is supplied with hot and cold running water and connected to an appropriate waste outlet; b) refrigeration which is dedicated to and appropriate for the storage of medicines, with adequate temperature monitoring; c) an appropriate number of suitably equipped dispensing stations; d) sufficient free working space and area/s for equipment storage and use; e) a storage system which provides for the safe custody and accurate selection of medicines; f) a dedicated storage facility for Schedule 8 and 9 poisons which complies with legislation, provides adequate storage for poisons on hand at all times and facilitates their accurate selection.
2.4.3.	The dispensary shall be well lit, adequately ventilated and temperature controlled, to maintain the integrity of medicines and provide for personal comfort.
2.4.4.	There shall be hygiene and infection prevention measures in place which are appropriate for the pharmacy services being provided.

2.5. Equipment

2.5.1.	Equipment shall be safe to use and fit for purpose.
2.5.2.	Equipment shall undergo regular maintenance, including routine calibration or servicing.
2.5.3.	Equipment shall be operated safely, in accordance with standard operating procedures, and within the manufacturer's specified operating range.
2.5.4.	Equipment shall be routinely cleaned.
2.5.5.	Maintenance records shall be kept and standard operating procedures shall be current and readily available.
2.5.6.	Registered premises shall be equipped with the minimum equipment required for simple compounding.
2.5.7.	Appropriate equipment shall be used for the handling and compounding of hazardous materials to ensure that staff and the public are not put at risk and the integrity of the product is maintained.

2.6. Reference texts

2.6.1.	There shall be a range of current reference texts relevant to the pharmacy services provided, at the premises.
---------------	--

Water Act 1989**GREATER WESTERN WATER (PREVIOUSLY CITY WEST WATER AND WESTERN WATER) – DECLARATION OF SERVICED PROPERTIES**

Pursuant to section 144 of the **Water Act 1989**, Greater Western Water (previously City West Water and Western Water) declares the following land to be serviced property for the listed services on or from the Declaration Date/s listed below.

Lot/s	PS Number	Address	Commence Date	Services
1–2	PS832344B	65 Keith Avenue, Sunbury	8/05/2019	Water/Sewer
1–2	PS833443T	56 Melba Avenue, Sunbury	18/09/2020	Water/Sewer
301–385	PS830442M	Heathfield Estate Stage 3, Fraser Rise	1/04/2022	Water/Sewer
1–3	PS838675T	11 Goldies Lane, Woodend	5/04/2022	Water/Sewer
1401–1425	PS838480K	Monument Estate Stage 14, Bonnie Brook	6/04/2022	Water/Sewer
1–2	PS844672Q	8 Regan Drive, Romsey	11/04/2022	Water/Sewer
1–2	PS903702H	42 Metcalfe Drive, Romsey	12/04/2022	Water/Sewer
3301–3340	PS839338H	Bloomdale Estate Stage 33, Diggers Rest	13/04/2022	Water/Sewer
5101–5149	PS842438K	Woodlea Estate Stage 51, Bonnie Brook	19/04/2022	Water/Sewer
801–818	PS838549Y	Orchard Green Estate Stage 8, Melton South	20/04/2022	Water/Sewer
15028–15057	PS829707J	Mt Atkinson Estate Stage 15b, Truganina	20/04/2022	Water/Sewer
701–727	PS844141Y	Willow Estate Stage 7, Gisborne	21/04/2022	Water/Sewer
3101–3133	PS840890B	Rosenthal Estate Stage E1, Sunbury	21/04/2022	Water/Sewer
901–964	PS820467B	Seventh Bend Estate Stage 9, Weir Views	23/04/2022	Water/Sewer
1–2	PS845803W	9 Aspera Drive, Brookfield	28/04/2022	Water/Sewer
21–33	PS817596H/S1	Mccormacks Road, Maddingley	28/04/2022	Water/Sewer
1–2	PS826194D	17 Sexton St, Riddells Creek	29/04/2022	Water/Sewer

Water Act 1989

**CENTRAL GIPPSLAND REGION WATER CORPORATION –
DECLARATION OF SERVICED PROPERTIES**

Pursuant to section 144 of the **Water Act 1989**, Central Gippsland Region Water Corporation declares the following land to be serviced property for the services listed below on or from the Declaration Date/s listed below.

Address	Service	Subdivision No.	Declaration Date
Coolabah Place, Snow Gum Close, Moe	Water and Wastewater	PS839933 S	5/04/2022
Royal Pines Drive, Oakmont Drive and Wedge Lane, Drouin	Water and Wastewater	PS838066 V	21/04/2022

ORDERS IN COUNCIL**Education and Training Reform Act 2006****APPOINTMENT OF 13 MEMBERS INCLUDING A CHAIRPERSON AND DEPUTY CHAIRPERSON TO THE COUNCIL OF THE VICTORIAN INSTITUTE OF TEACHING****Order in Council**

The Governor in Council:

- under section 2.6.6(3)(a) of the **Education and Training Reform Act 2006** (the Act), appoints Michael Butler, Gillian Carr, Paul Desmond, Linda Douglas, Amadeo Ferra, Siobhan Hannan, Lesley Lamb, Mary-Anne Pontikis, Sharon Rogers, Janet Scull, Angela Stringer, Raelene Vine and Graeme Young as members of the Council of the Victorian Institute of Teaching from 1 June 2022 to 31 May 2025 (both dates inclusive).
- under section 2.6.6(5) of the Act, appoints Lesley Lamb as chairperson of the Council of the Victorian Institute of Teaching from 1 June 2022 to 31 May 2025 (both dates inclusive).
- under section 2.6.6C of the Act, appoints Paul Desmond as deputy chairperson of the Council of the Victorian Institute of Teaching from 1 June 2022 to 31 May 2025 (both dates inclusive).

The terms and conditions of the appointments are contained in the attached Schedule.

Dated: 10 May 2022

Responsible Minister:

THE HON JAMES MERLINO, MP
Minister for Education

ALEXANDRA DEBELJAKOVIC
Clerk of the Executive Council

Education and Training Reform Act 2006**APPOINTMENT OF 13 MEMBERS INCLUDING A CHAIRPERSON AND DEPUTY CHAIRPERSON TO THE COUNCIL OF THE VICTORIAN INSTITUTE OF TEACHING****SCHEDULE TO THE ORDER IN COUNCIL****1. Appointment Arrangements**

All members, including the deputy chairperson, are appointed on a part time sessional basis. The appointment of the chairperson is on a part-time annual basis.

2. Period of Appointment

All persons, including the chairperson and deputy chairperson, are appointed to the Council of the Victorian Institute of Teaching (the Council) from 1 June 2022 until 31 May 2025 (both dates inclusive).

3. Duties and Responsibilities of the Position

The Council manages the affairs of the Victorian Institute of Teaching (Institute) and exercises the powers of the Institute.

The Chairperson performs specific duties under Part 2.6 and Schedule 2 to the **Education and Training Reform Act 2006** (the Act).

4. Termination Arrangements

Section 2.6.62(1) of the Act provides that a member of the Council may resign from office by delivering to the chairperson of the Institute a signed letter of resignation.

Under section 2.6.62(2) of the Act, the Governor in Council may at any time remove a member appointed by the Governor in Council from office.

5. Payment Provisions

Eligible members of the Council (see clause 3(1) of Schedule 2 to the Act) will be remunerated at the sessional rate of \$394 per day.

Michael Butler, Gillian Carr, Paul Desmond, Linda Douglas, Siobhan Hannan, Sharon Rogers, Mary-Anne Pontikis, Janet Scull, Angela Stringer, Raelene Vine and Graeme Young are each entitled to remuneration as they do not hold a full-time Government office, or a full-time position in the public service, teaching service or with a statutory authority. Amadeo Ferra holds a full-time position in the government teaching service and is therefore not eligible for remuneration.

The chairperson will be remunerated at the rate of \$41,937 per annum.

To avoid doubt, the chairperson (including an acting chairperson) is not entitled to any additional payment of the sessional rate applicable for ordinary members (including the deputy chairperson) of the Council.

6. Superannuation Obligations

Council members are eligible for superannuation in accordance with the **Superannuation Guarantee (Administration) Act 1992** (Cth).

7. Travel and Personal Expenses Arrangements

Council members are entitled to reimbursement of reasonable travelling and personal expenses incurred consistent with the policies of the Department of Education and Training.

8. Leave Arrangements

Not applicable.

9. Prior Service

Not applicable.

Education and Training Reform Act 2006**APPROVAL OF MEMBERS TO THE VICTORIAN INSTITUTE OF
TEACHING HEARING PANEL POOL****Order in Council**

The Governor in Council, under section 2.6.35F(1) of the **Education and Training Reform Act 2006**, approves Jessica Adams, Rowena Archer, Sean Baker, Diana Beaumont, Owen Bradfield, Susan Buckley, Christopher Chant, Simon Coles, Kaye Frankcom, Ricky Gervasoni, Kerry-Anne Hoad, Gail McHardy, Brendan Murray, Sophia Panagiotidis, Christopher Pollard, Rowland Richardson, Garry Salisbury, Heather Schnagl, Janet Sherry, Margaret Staley and Julia Wake for a pool of persons who may be appointed to a hearing panel of the Victorian Institute of Teaching for a period of 3 years from 28 May 2022.

Dated: 10 May 2022

Responsible Minister:

THE HON JAMES MERLINO, MP

Minister for Education

ALEXANDRA DEBELJAKOVIC
Clerk of the Executive Council

Transport Accident Act 1986**TRANSPORT ACCIDENT CHARGES ORDER (NO.1) 2022**

Order in Council

The Governor-in-Council with the advice of the Executive Council under section 110(8) of the **Transport Accident Act 1986** on the recommendation of the responsible Minister makes the following Order:

This Order will come into effect from 1 July 2022.

1. Title

This Order is called the Transport Accident Charges Order (No.1) 2022.

2. Commencement

This Order comes into operation on 1 July 2022.

3. Definitions

In this Order –

‘**Act**’ means the **Transport Accident Act 1986**;

‘**apprentice’s concession**’ means a 50 per cent discount on the TAC charge payable for a vehicle registered under the **Road Safety Act 1986** and classified under category 1(a), 1(b)(i), 2(a) or 2(b) of this Order, in the name of a person who meets the described requirements of Category 16 of Schedule 2 of the **Road Safety (Vehicles) Regulations 2021**;

‘**bus**’ means any motor vehicle, other than a taxi or private hire car, licensed for or primarily used for carrying passengers for hire, fare or reward;

‘**carrying capacity**’ means a vehicle’s Gross Vehicle Mass minus its tare weight;

‘**exempt general-use motorcycle**’ means a general-use motorcycle which –

- (a) at the time when application is made for registration or renewal of registration, application is made by a person who has another general-use motorcycle registered under the **Road Safety Act 1986** that is classified under 3(a)(iii) or 3(a)(iv) of Schedule 1 to this Order, and
- (b) is fitted with an engine with a capacity greater than 125cc, and
- (c) is the subject of an application for registration or renewal of registration by an individual;

‘**forward-control body-type**’ means a motor vehicle in which the centre of the steering wheel is in the forward quarter of the vehicle’s total length;

‘**general-use motorcycle**’ means a motorcycle that is not classified, or to be classified, under 4(b), 4(c), 4(d), 5(b)(ii) or 5(d) of Schedule 1 to this Order;

‘**high risk zone**’ means the parts of the State in which addresses are allocated a postcode listed in Part A of Schedule 2 to this Order and, except if the Commission otherwise determines under 110(1A) of the Act, any place outside Victoria;

‘**low risk zone**’ means the parts of the State that are not located in the ‘high risk zone’ or the ‘medium risk zone’;

‘**medium risk zone**’ means the parts of the State in which addresses are allocated a postcode listed in Part B of Schedule 2 to this Order;

‘**pensioner motor vehicle**’ means a motor vehicle that –

- (a) is registered or to be registered in the name of an eligible pensioner within the meaning of the **State Concessions Act 2004**; and
- (b) is eligible to be registered under the **Road Safety Act 1986** in accordance with regulation 120(3) or item 8, 9, 10 or 11 of the Table to Schedule 2 to the **Road Safety (Vehicles) Regulations 2021**; and
- (c) is registered or about to be registered under the **Road Safety Act 1986**;

‘prescribed period’ means the period prescribed for the purposes of section 109 of the Act in relation to a motor vehicle of a certain class specified in regulation 5 of the **Transport Accident (Administration of Charges) Regulations 2021**;

‘taxi’ means a commercial passenger vehicle providing booked and unbooked (rank and hail) services that is licensed under relevant Victorian legislation, with a sedan, station wagon or related body-type (including 4WD passenger vehicle), or a mini-bus which is wheelchair accessible.

4. Transport accident charge

1. The amount of the transport accident charge applicable to a motor vehicle is the amount shown in Schedule 1 as applicable in respect of –

- (a) motor vehicles of that class; and
- (b) the high risk zone, medium risk zone or low risk zone, as the case may be, in which the motor vehicle is usually kept.

2. If the prescribed period in relation to a motor vehicle is less than 12 months the transport accident charge applicable to the motor vehicle in respect of that period is the amount, calculated to the nearest whole dollar, determined in accordance with the formula –

$$\frac{(A \times B)}{365} + \$17$$

where –

A is the amount of the transport accident charge applicable under sub-paragraph (1); and

B is the number of days in the prescribed period.

3. Despite sub-paragraph (2), if the prescribed period in relation to a motor vehicle is less than 12 months, and is a whole number of months, the transport accident charge applicable to the motor vehicle in respect of that period is the amount, calculated to the nearest whole dollar, determined in accordance with the formula –

$$\frac{(A \times C)}{12} + \$17$$

where –

A is the amount of the transport accident charge applicable under sub-paragraph (1); and

C is the number of months in the prescribed period.

4. If the prescribed period in relation to a motor vehicle is more than 12 months, the transport accident charge applicable to the motor vehicle in respect of that period is the amount, calculated to the nearest whole dollar, determined in accordance with the formula –

$$\frac{(A \times B)}{365}$$

where –

A is the amount of the transport accident charge applicable under sub-paragraph (1); and

B is the number of days in the prescribed period.

5. Despite sub-paragraph (4), if the prescribed period in relation to a motor vehicle is more than 12 months and is a whole number of months, the transport accident charge applicable to the motor vehicle in respect of that period is the amount, calculated to the nearest whole dollar, determined in accordance with the formula –

(A x C)

12

where –

A is the amount of the transport accident charge applicable under sub-paragraph (1); and

C is the number of months in the prescribed period.

6. If the motor vehicle is a pensioner motor vehicle the transport accident charge applicable to the motor vehicle is one-half of the transport accident charge that would otherwise be payable.
7. If the motor vehicle is subject to the ‘apprentice’s concession’ the transport accident charge applicable to the motor vehicle is one-half of the transport accident charge that would otherwise be payable for motor vehicles classified under classes 1(a), 1(b)(i), 2(a) or 2(b).

Dated: 10 May 2022

Responsible Minister:

BEN CARROLL MP

Minister for Roads and Road Safety

ALEXANDRA DEBELJAKOVIC
Clerk of the Executive Council

Transport Accident Act 1986
TRANSPORT ACCIDENT CHARGES ORDER (NO.1) 2022
SCHEDULE TO THE ORDER IN COUNCIL
SCHEDULE 1

Paragraph 4

TRANSPORT ACCIDENT CHARGES

Item	Class	Annual Amounts of Transport Accident Charge Payable		
		High risk zone \$ (Inc GST)	Medium risk zone \$ (Inc GST)	Low risk zone \$ (Inc GST)
1.	Passenger Vehicles			
	a) Any motor vehicle with sedan, station wagon or related body-type (including 4WD passenger vehicle) not included in any other class; self-propelled caravan; ambulance; hearse or mourning coach.	502	451	391
	b) Any motor vehicle with a bus or forward-control body-type constructed and primarily used for carrying passengers, but not for hire, fare or reward –	502	450	370
	i) Seating up to 9 people (including the driver)			
	ii) Seating 10 or more people (including the driver)	712	450	370
	c) Taxi	502	451	391
	d) Bus –			
	i) seating up to 9 people (including the driver)	1661	1114	385
2.	ii) seating 10 or more people but fewer than 31 people (including the driver), the relevant zone charge for a bus under (i), plus for each additional seat over 9	42	19	5
	iii) seating 31 people or more	2545	1524	503
	Goods Vehicles			
	Any motor vehicle designed, constructed or primarily used for carrying goods –			
	a) up to and including two tonnes carrying capacity including utility	503	381	264
	b) over two tonnes carrying capacity but excluding motor vehicles classified under 2(c) or 2(d)	733	641	551

	c) prime mover type motor vehicle, but excluding motor vehicles classified under 2(d) and motor vehicles having a tare weight of 5 tonnes or less	2034	1625	1225
	d) any motor vehicle owned by a primary producer that would otherwise be classified under 2(b) or 2(c) that is used solely in connection with the primary production operations of the owner	222	186	153
3.	Motorcycles			
	a) Any general-use motorcycle, other than an exempt general-use motorcycle with an engine capacity	84	84	84
	i) less than 61cc			
	ii) greater than 60cc but less than 126cc	332	292	251
	iii) greater than 125cc but less than 501cc	441	395	351
	iv) greater than 500cc	601	535	469
	a) Any exempt general-use motorcycle with engine capacity	370	324	280
	i) greater than 125cc but less than 501cc			
	ii) greater than 500cc	530	464	398
4.	Miscellaneous motor vehicles			
	a) Any motor vehicle not otherwise classified: including road making motor vehicle, mobile crane, tractor (except those classified under 4(b))	380	301	95
	b) Any tractor, self-propelled farm machine or motor cycle owned by a primary producer and used solely in connection with the primary production operations of the owner	84	84	84
	c) Any recreation motor vehicle registered under the Road Safety Act 1986	70	70	70
	d) Any vintage, veteran, classic or historic motor vehicle or motorcycle operating on a 45 day club permit	50	50	50
	e) Any vintage, veteran, classic or historic motor vehicle or motorcycle operating on a 90 day club permit	97	97	97
5.	Special purpose motor vehicles			
	a) Fire brigade –			
	i) Any motor vehicle owned by Fire Rescue Victoria which is used to combat outbreaks of fire	1270	203	203

	ii) Any motor vehicle owned by the Country Fire Authority or any brigade or group of brigades registered with the Country Fire Authority which is used to combat outbreaks of fire	203	203	203
	b) Police			
	i) Any motor vehicle (excluding a motorcycle) registered in the name of the Victoria Police	1780	1780	1780
	ii) Any motorcycle registered in the name of the Victoria Police	503	503	503
	c) Motor trades			
	i) Motor vehicle used by a manufacturer of vehicles, a dealer in vehicles, a fleet owner or a licensed tester of vehicles as defined in the vehicles regulations with general identification mark (trade plate) attached	329	247	162
	ii) Tow truck licensed under the Accident Towing Services Act 2007 or used for trade towing	939	703	470
	d) Hire and drive yourself motor vehicle or motorcycle (including courtesy and loan cars) but excluding a prime mover classified under item 2(c)	797	667	576

Item	Class	Six-monthly Amounts of Transport Accident Charge Payable		
		High risk zone \$ (Inc GST)	Medium risk zone \$ (Inc GST)	Low risk zone \$ (Inc GST)
1.	Passenger Vehicles			
	a) Any motor vehicle with sedan, station wagon or related body-type (including 4WD passenger vehicle) not included in any other class; self-propelled caravan; ambulance; hearse or mourning coach;	251	225.50	195.50
	b) Any motor vehicle with a bus or forward-control body-type constructed and primarily used for carrying passengers, but not for hire, fare or reward –			
	i) Seating up to 9 people (including the driver)	251	225	185
	ii) Seating 10 or more people (including the driver)	356	225	185

	c) Taxi	251	225.50	195.50
	d) Bus –			
	i) seating up to 9 people (including the driver)	830.50	557	192.50
	ii) seating 10 or more people but fewer than 31 people (including the driver), the relevant zone charge for a bus under (i), plus for each additional seat over 9	21	9.50	2.50
	iii) seating 31 people or more	1272.50	762	251.50
2.	Goods Vehicles Any motor vehicle designed, constructed or primarily used for carrying goods –			
	a) up to and including two tonnes carrying capacity including utility	251.50	190.50	132
	b) over two tonnes carrying capacity but excluding motor vehicles classified under 2(c) or 2(d)	366.50	320.50	275.50
	c) prime mover type motor vehicle, but excluding motor vehicles classified under 2(d) and motor vehicles having a tare weight of 5 tonnes or less	1017	812.50	612.50
	d) any motor vehicle owned by a primary producer that would otherwise be classified under 2(b) or 2(c) that is used solely in connection with the primary production operations of the owner	111	93	76.50
3.	Motorcycles			
	a) Any general-use motorcycle, other than an exempt general-use motorcycle with an engine capacity			
	i) less than 61cc	42	42	42
	ii) greater than 60cc but less than 126cc	166	146	125.50
	iii) greater than 125cc but less than 501cc	220.50	197.50	175.50
	iv) greater than 500cc	300.50	267.50	234.50
	b) Any exempt general-use motorcycle with			
	v) greater than 125cc but less than 501cc	185	162	140
	vi) greater than 500cc	265	232	199

4.	Miscellaneous motor vehicles			
	a) Any motor vehicle not otherwise classified: including road making motor vehicle, mobile crane, tractor (except those classified under 4(b))	190	150.50	47.50
	b) Any tractor, self-propelled farm machine or motor cycle owned by a primary producer and used solely in connection with the primary production operations of the owner	42	42	42
	c) Any recreation motor vehicle registered under the Road Safety Act 1986	35	35	35
5.	Special purpose motor vehicles			
	a) Fire brigade			
	i) Any motor vehicle owned by Fire Rescue Victoria which is used to combat outbreaks of fire	635	101.50	101.50
	ii) Any motor vehicle owned by the Country Fire Authority or any brigade or group of brigades registered with the Country Fire Authority which is used to combat outbreaks of fire	101.50	101.50	101.50
	b) Police			
	i) Any motor vehicle (excluding a motorcycle) registered in the name of the Victoria Police	890	890	890
	ii) Any motorcycle registered in the name of the Victoria Police	251.50	251.50	251.50
	c) Motor trades			
	i) Motor vehicle used by a manufacturer of vehicles, a dealer in vehicles, a fleet owner or a licensed tester of vehicles as defined in the vehicles regulations with general identification mark (trade plate) attached	164.50	123.50	81
	ii) Tow truck licensed under the Accident Towing Services Act 2007 or used for trade towing	469.50	351.50	235
	d) Hire and drive yourself motor vehicle or motorcycle (including courtesy and loan cars) but excluding a prime mover classified under item 2(c)	398.50	333.50	288

Item	Class	Three-monthly Amounts of Transport Accident Charge Payable		
		High risk zone \$ (Inc GST)	Medium risk zone \$ (Inc GST)	Low risk zone \$ (Inc GST)
1.	Passenger Vehicles			
	a) Any motor vehicle with sedan, station wagon or related body-type (including 4WD passenger vehicle) not included in any other class; self-propelled caravan; ambulance; hearse or mourning coach;	125.50	112.75	97.75
	b) Any motor vehicle with a bus or forward-control body-type constructed and primarily used for carrying passengers, but not for hire, fare or reward –			
	i) Seating up to 9 people (including the driver)	125.50	112.50	92.50
	ii) Seating 10 or more people (including the driver)	178	112.50	92.50
	c) Taxi	125.50	112.75	97.75
	d) Bus –			
	i) seating up to 9 people (including the driver)	415.25	278.50	96.25
2.	ii) seating 10 or more people but fewer than 31 people (including the driver), the relevant zone charge for a bus under (i), plus for each additional seat over 9	10.50	4.75	1.25
	iii) seating 31 people or more	636.25	381	125.75
	Goods Vehicles			
	Any motor vehicle designed, constructed or primarily used for carrying goods –			
	a) up to and including two tonnes carrying capacity including utility	125.75	95.25	66
	b) over two tonnes carrying capacity but excluding motor vehicles classified under 2(c) or 2(d)	183.25	160.25	137.75
	c) prime mover type motor vehicle, but excluding motor vehicles classified under 2(d) and motor vehicles having a tare weight of 5 tonnes or less	508.50	406.25	306.25
	d) any motor vehicle owned by a primary producer that would otherwise be classified under 2(b) or 2(c) that is used solely in connection with the primary production operations of the owner	55.50	46.50	38.25

3.	Motorcycles a) Any general-use motorcycle, other than an exempt general-use motorcycle with an engine capacity i) less than 61cc ii) greater than 60cc but less than 126cc iii) greater than 125cc but less than 501cc iv) greater than 500cc b) Any exempt general-use motorcycle with i) greater than 125cc but less than 501cc ii) greater than 500cc	21 83 110.25 150.25 92.50 132.50	21 73 98.75 133.75 81 116	21 62.75 87.75 117.25 70 99.50
4.	Miscellaneous motor vehicles a) Any motor vehicle not otherwise classified: including road making motor vehicle, mobile crane, tractor (except those classified under 4(b)) b) Any tractor, self-propelled farm machine or motor cycle owned by a primary producer and used solely in connection with the primary production operations of the owner c) Any recreation motor vehicle registered under the Road Safety Act 1986	95 21 17.50	75.25 21 17.50	23.75 21 17.50
5.	Special purpose motor vehicles a) Fire brigade i) Any motor vehicle owned by Fire Rescue Victoria which is used to combat outbreaks of fire ii) Any motor vehicle owned by the Country Fire Authority or any brigade or group of brigades registered with the Country Fire Authority which is used to combat outbreaks of fire b) Police i) Any motor vehicle (excluding a motorcycle) registered in the name of the Victoria Police ii) Any motorcycle registered in the name of the Victoria Police	317.50 50.75 445 125.75	50.75 50.75 445 125.75	50.75 50.75 445 125.75

c) Motor trades			
i) Motor vehicle used by a manufacturer of vehicles, a dealer in vehicles, a fleet owner or a licensed tester of vehicles as defined in the vehicles regulations with general identification mark (trade plate) attached	82.25	61.75	40.50
ii) Tow truck licensed under the Accident Towing Services Act 2007 or used for trade towing	234.75	175.75	117.50
d) Hire and drive yourself motor vehicle or motorcycle (including courtesy and loan cars) but excluding a prime mover classified under item 2(c)	199.25	166.75	144

Item	Class	Annual Apprentice's Concession Rates		
		High risk zone \$ (Inc GST)	Medium risk zone \$ (Inc GST)	Low risk zone \$ (Inc GST)
1.	Passenger Vehicles			
	a) Any motor vehicle with sedan, station wagon or related body-type (including 4WD passenger vehicle) not included in any other class; self-propelled caravan; ambulance; hearse or mourning coach;	251	225.50	195.50
	b) Any motor vehicle with a bus or forward-control body-type constructed and primarily used for carrying passengers, but not for hire, fare or reward seating up to 9 people (including the driver)	251	225	185
2.	Goods Vehicles			
	Any motor vehicle designed, constructed or primarily used for carrying goods –	251.50	190.50	132
	a) up to and including two tonnes carrying capacity including utility	366.50	320.50	275.50
	b) over two tonnes carrying capacity but excluding motor vehicles classified under 2(c) or 2(d)			
	c) prime mover type motor vehicle, but excluding motor vehicles classified under 2(d) and motor vehicles having a tare weight of 5 tonnes or less	N/A	N/A	N/A
	d) any motor vehicle owned by a primary producer that would otherwise be classified under 2(b) or 2(c) that is used solely in connection with the primary production operations of the owner	N/A	N/A	N/A

Item	Class	Six-Monthly Apprentice's Concession Rates		
		High risk zone \$ (Inc GST)	Medium risk zone \$ (Inc GST)	Low risk zone \$ (Inc GST)
1.	Passenger Vehicles			
	a) Any motor vehicle with sedan, station wagon or related body-type (including 4WD passenger vehicle) not included in any other class; self-propelled caravan; ambulance; hearse or mourning coach;	125.50	112.75	97.75
	b) Any motor vehicle with a bus or forward-control body-type constructed and primarily used for carrying passengers, but not for hire, fare or reward seating up to 9 people (including the driver).	125.50	112.50	92.50
2.	Goods Vehicles			
	Any motor vehicle designed, constructed or primarily used for carrying goods –			
	a) up to and including two tonnes carrying capacity including utility	125.75	95.25	66
	b) over two tonnes carrying capacity but excluding prime mover type motor vehicles and any motor vehicle owned by a primary producer that is used solely in connection with the primary production operations of the owner	183.25	160.25	137.75
	c) prime mover type motor vehicle, but excluding motor vehicles classified under 2(d) and motor vehicles having a tare weight of 5 tonnes or less	N/A	N/A	N/a
	d) any motor vehicle owned by a primary producer that would otherwise be classified under 2(b) or 2(c) that is used solely in connection with the primary production operations of the owner	N/A	N/A	N/A

Item	Class	Three-monthly Apprentice's Concession Rates		
		High risk zone \$ (Inc GST)	Medium risk zone \$ (Inc GST)	Low risk zone \$ (Inc GST)
1.	Passenger Vehicles			
	a) Any motor vehicle with sedan, station wagon or related body-type (including 4WD passenger vehicle) not included in any other class; self-propelled caravan; ambulance; hearse or mourning coach;	62.75	56.37	48.87
	b) Any motor vehicle with a bus or forward-control body-type constructed and primarily used for carrying passengers, but not for hire, fare or reward seating up to 9 people (including the driver).	62.75	56.25	46.25
2.	Goods Vehicles			
	Any motor vehicle designed, constructed or primarily used for carrying goods –	62.87	47.63	33
	a) up to and including two tonnes carrying capacity including utility			
	b) over two tonnes carrying capacity but excluding motor vehicles classified under 2(c) or 2(d)	91.63	80.13	68.87
	c) prime mover type motor vehicle, but excluding motor vehicles classified under 2(d) and motor vehicles having a tare weight of 5 tonnes or less	N/A	N/A	N/A
	d) any motor vehicle owned by a primary producer that would otherwise be classified under 2(b) or 2(c) that is used solely in connection with the primary production operations of the owner	N/A	N/A	N/A

	Class	Annual Pensioner Concession Rates		
		High risk zone \$ (Inc GST)	Medium risk zone \$ (Inc GST)	Low risk zone \$ (Inc GST)
1.	Passenger Vehicles			
	a) Any motor vehicle with sedan, station wagon or related body-type (including 4WD passenger vehicle) not included in any other class; self-propelled caravan; ambulance; hearse or mourning coach;	251	225.50	195.50

	b) Any motor vehicle with a bus or forward-control body-type constructed and primarily used for carrying passengers, but not for hire, fare or reward – <ul style="list-style-type: none"> i) Seating up to 9 people (including the driver) ii) Seating 10 or more people (including the driver) 	251 356	225 225	185 185
2.	Goods Vehicles Any motor vehicle designed, constructed or primarily used for carrying goods – <ul style="list-style-type: none"> a) up to and including two tonnes carrying capacity including utility b) over two tonnes carrying capacity but excluding motor vehicles classified under 2(c) or 2(d) c) prime mover type motor vehicle, but excluding motor vehicles classified under 2(d) and motor vehicles having a tare weight of 5 tonnes or less d) any motor vehicle owned by a primary producer that would otherwise be classified under 2(b) or 2(c) that is used solely in connection with the primary production operations of the owner 	251.50 366.50 1017 N/A	190.50 320.50 812.50 N/A	132 275.50 612.50 N/A
3.	Motorcycles <ul style="list-style-type: none"> a) Any general-use motorcycle, other than an exempt general-use motorcycle with engine capacity <ul style="list-style-type: none"> i) less than 61cc ii) greater than 60cc but less than 126cc iii) greater than 125cc but less than 501cc iv) greater than 500cc b) Any exempt general-use motorcycle with <ul style="list-style-type: none"> i) greater than 125cc but less than 501cc ii) greater than 500cc 	42 166 220.50 300.50 185 265	42 146 197.50 267.50 162 232	42 125.50 175.50 234.50 140 199
4.	Miscellaneous motor vehicle <ul style="list-style-type: none"> a) Any motor vehicle not otherwise classified: including road making motor vehicle, mobile crane, tractor (except those classified under 4(b)) 	190	150.50	47.50

b) Any tractor, self-propelled farm machine or motor cycle owned by a primary producer and used solely in connection with the primary production operations of the owner	42	42	42
c) Any recreation motor vehicle registered under the Road Safety Act 1986	35	35	35

	Class	Six-Monthly Pensioner Concession Rates		
		High risk zone \$ (Inc GST)	Medium risk zone \$ (Inc GST)	Low risk zone \$ (Inc GST)
1.	Passenger Vehicles			
	a) Any motor vehicle with sedan, station wagon or related body-type (including 4WD passenger vehicle) not included in any other class; self-propelled caravan; ambulance; hearse or mourning coach;	125.50	112.75	97.75
	b) Any motor vehicle with a bus or forward-control body-type constructed and primarily used for carrying passengers, but not for hire, fare or reward –			
	i) Seating up to 9 people (including the driver)	125.50	112.50	92.50
	ii) Seating 10 or people (including the driver)	178	112.50	92.50
2.	Goods Vehicles			
	Any motor vehicle designed, constructed or primarily used for carrying goods –			
	a) up to and including two tonnes carrying capacity including utility	125.75	95.25	66
	b) over two tonnes carrying capacity but excluding motor vehicles classified under 2(c) or 2(d)	183.25	160.25	137.75
	c) prime mover type motor vehicle, but excluding motor vehicles classified under 2(d) and motor vehicles having a tare weight of 5 tonnes or less	508.50	406.25	306.25
	d) any motor vehicle owned by a primary producer that would otherwise be classified under 2(b) or 2(c) that is used solely in connection with the primary production operations of the owner	N/A	N/A	N/A

3.	Motorcycles			
	a) Any general-use motorcycle, other than an exempt general-use motorcycle with engine capacity			
	i) less than 61cc	21	21	21
	ii) greater than 60cc but less than 126cc	83	73	62.75
	iii) greater than 125cc but less than 501cc	110.25	98.75	87.75
	iv) greater than 500cc	150.25	133.75	117.25
	b) Any exempt general-use motorcycle with engine capacity			
4.	i) greater than 125cc but less than 501cc	92.50	81	70
	ii) greater than 500cc	132.50	116	99.50
	Miscellaneous motor vehicles			
	a) Any motor vehicle not otherwise classified: including road making motor vehicle, mobile crane, tractor (except those classified under 4(b))	95	75.25	23.75
	b) Any tractor, self-propelled farm machine or motor cycle owned by a primary producer and used solely in connection with the primary production operations of the owner	21	21	21
	c) Any recreation motor vehicle registered under the Road Safety Act 1986	17.50	17.50	17.50

	Class	Three-monthly Pensioner Concession Rates		
		High risk zone \$ (Inc GST)	Medium risk zone \$ (Inc GST)	Low risk zone \$ (Inc GST)
1.	Passenger Vehicles			
	a) Any motor vehicle with sedan, station wagon or related body-type (including 4WD passenger vehicle) not included in any other class; self-propelled caravan; ambulance; hearse or mourning coach;	62.75	56.37	48.87
	b) Any motor vehicle with a bus or forward-control body-type constructed and primarily used for carrying passengers, but not for hire, fare or reward –			
	i) Seating up to 9 people (including the driver)	62.75	56.25	46.25
	ii) Seating 10 or more people (including the driver)	89	56.25	46.25

2.	Goods Vehicles Any motor vehicle designed, constructed or primarily used for carrying goods – <ul style="list-style-type: none"> a) up to and including two tonnes carrying capacity including utility b) over two tonnes carrying capacity but excluding motor vehicles classified under 2(c) or 2(d) c) prime mover type motor vehicle, but excluding motor vehicles classified under 2(d) and motor vehicles having a tare weight of 5 tonnes or less d) any motor vehicle owned by a primary producer that would otherwise be classified under 2(b) or 2(c) that is used solely in connection with the primary production operations of the owner 	62.87 91.63 254.25 N/A	47.63 80.13 203.13 N/A	33 68.87 153.13 N/A
3.	Motorcycles <ul style="list-style-type: none"> a) Any general-use motorcycle, other than an exempt general-use motorcycle with an engine capacity <ul style="list-style-type: none"> i) less than 61cc ii) greater than 60cc but less than 126cc iii) greater than 125cc but less than 501cc iv) greater than 500cc b) Any exempt general-use motorcycle with engine capacity <ul style="list-style-type: none"> i) greater than 125cc but less than 501cc ii) greater than 500cc 	10.50 41.50 55.13 75.13 46.25 66.25	10.50 36.50 49.37 66.87 40.50 58	10.50 31.37 43.87 58.63 35 49.75
4.	Miscellaneous motor vehicles <ul style="list-style-type: none"> a) Any motor vehicle not otherwise classified: including road making motor vehicle, mobile crane, tractor (except those classified under 4(b)) b) Any tractor, self-propelled farm machine or motor cycle owned by a primary producer and used solely in connection with the primary production operations of the owner c) Any recreation motor vehicle registered under the Road Safety Act 1986 	47.50 10.50 8.75	37.63 10.50 8.75	11.87 10.50 8.75

SCHEDULE 2**PART A****POSTCODES IN THE HIGH RISK ZONE**

3000	3026	3050	3073	3106	3136	3163	3184	3206
3001	3027	3051	3074	3107	3137	3164	3185	3207
3002	3028	3052	3075	3108	3138	3165	3186	3428
3003	3031	3053	3076	3109	3141	3166	3187	3800
3004	3032	3054	3078	3110	3142	3167	3188	3802
3005	3033	3055	3079	3111	3143	3168	3189	3803
3006	3034	3056	3081	3121	3144	3169	3190	3975
3008	3036	3057	3082	3122	3145	3170	3191	3976
3010	3037	3058	3083	3123	3146	3171	3192	
3011	3038	3059	3084	3124	3147	3172	3193	
3012	3039	3060	3085	3125	3148	3173	3194	
3013	3040	3061	3086	3126	3149	3174	3195	
3015	3041	3062	3087	3127	3150	3175	3196	
3016	3042	3064	3088	3128	3151	3176	3197	
3018	3043	3065	3093	3129	3152	3177	3198	
3019	3044	3066	3094	3130	3153	3178	3199	
3020	3045	3067	3101	3131	3154	3179	3200	
3021	3046	3068	3102	3132	3155	3180	3201	
3022	3047	3070	3103	3133	3156	3181	3202	
3023	3048	3071	3104	3134	3161	3182	3204	
3025	3049	3072	3105	3135	3162	3183	3205	

PART B**POSTCODES IN THE MEDIUM RISK ZONE**

3024	3114	3215	3750	3766	3788	3808	3920	3938
3029	3115	3216	3751	3767	3789	3809	3926	3939
3030	3116	3217	3752	3770	3791	3810	3927	3940
3089	3139	3218	3754	3775	3792	3910	3928	3941
3090	3140	3219	3755	3777	3793	3911	3929	3942
3091	3158	3220	3757	3781	3795	3912	3930	3943
3095	3159	3335	3759	3782	3796	3913	3931	3944
3096	3160	3337	3760	3783	3804	3915	3933	3977
3097	3211	3338	3761	3785	3805	3916	3934	3978
3099	3212	3427	3763	3786	3806	3918	3936	3980
3113	3214	3429	3765	3787	3807	3919	3937	

This page was left blank intentionally

This page was left blank intentionally

This page was left blank intentionally

SUBORDINATE LEGISLATION ACT 1994 NOTICE THAT STATUTORY RULES ARE OBTAINABLE

Notice is hereby given under section 17(3) of the **Subordinate Legislation Act 1994** that the following Statutory Rules were first obtainable from TIMG Bookshop, Level 10, 575 Bourke Street, Melbourne 3000, on the date specified:

- | | |
|-------------------------------|---|
| 25. <i>Statutory Rule:</i> | Child Wellbeing
and Safety
Amendment (Child
Safe Standards
Sector Regulators
and Infringements)
Regulations 2022 |
| <i>Authorising Act:</i> | Child Wellbeing
and Safety
Act 2005 |
| <i>Date first obtainable:</i> | 10 May 2022 |
| <i>Code A</i> | |
| 26. <i>Statutory Rule:</i> | Long Service
Benefits Portability
Amendment
(Schedules)
Regulations 2022 |
| <i>Authorising Act:</i> | Long Service
Benefits Portability
Act 2018 |
| <i>Date first obtainable:</i> | 10 May 2022 |
| <i>Code A</i> | |
| 27. <i>Statutory Rule:</i> | Service Victoria
(Transfer of
Miscellaneous
Licensing and
Registration
Identity Verification
Functions)
Regulations 2022 |
| <i>Authorising Act:</i> | Service Victoria
Act 2018 |
| <i>Date first obtainable:</i> | 10 May 2022 |
| <i>Code A</i> | |
| 28. <i>Statutory Rule:</i> | Summary Offences
Regulations 2022 |
| <i>Authorising Act:</i> | Summary Offences
Act 1966 |
| <i>Date first obtainable:</i> | 10 May 2022 |
| <i>Code A</i> | |

PRICING FOR SPECIAL GAZETTE, PERIODICAL GAZETTE AND VICTORIAN LEGISLATION

Retail price varies according to the number of pages in each Victoria Government Special Gazette, Victoria Government Periodical Gazette and Victorian legislation. The table below sets out the prices that apply.

<i>Price Code</i>	<i>No. of Pages (Including cover and blank pages)</i>	<i>Price*</i>
A	1–16	\$4.22
B	17–32	\$6.33
C	33–48	\$8.65
D	49–96	\$13.61
E	97–144	\$17.51
F	145–192	\$20.78
G	193–240	\$23.95
H	241–288	\$25.43
I	289–352	\$28.70
J	353–416	\$33.44
K	417–480	\$38.19
L	481–544	\$44.52
M	545–608	\$50.90
N	609–672	\$56.28
O	673–736	\$63.62
P	737–800	\$70.10
#Q	821–886	\$76.22
#R	887–950	\$81.29
#S	951–1016	\$86.83
#T	1017–1080	\$92.21
#U	1081–1146	\$97.75
#V	1147–1210	\$103.50
#W	1211–1276	\$108.88
#X	1277–1340	\$114.78
#Y	1341–1406	\$119.95

<i>Price Code</i>	<i>No. of Pages (Including cover and blank pages)</i>	<i>Price*</i>
#Z	1407–1470	\$125.60
#ZA	1471–1536	\$131.56
#ZB	1537–1610	\$136.57
#ZC	1611–1666	\$142.32
#ZD	1667–1730	\$147.70
#ZE	1731–1796	\$153.66
#ZF	1797–1860	\$159.20
#ZG	1861–1926	\$164.42
#ZH	1927–1990	\$170.38
#ZI	1991–2056	\$175.76

* All prices include GST

Printed as two volumes



The *Victoria Government Gazette* is published by IVE Group Limited with the authority of the Government Printer for the State of Victoria

© State of Victoria 2022

This publication is copyright. No part may be reproduced by any process except in accordance with the provisions of the Copyright Act.

Address all enquiries to the Government Printer for the State of Victoria
Level 2, 1 Macarthur Street
Melbourne 3002
Victoria Australia

How To Order



**Retail &
Mail Sales**

Victoria Government Gazette
Ground Floor, Building 8,
658 Church Street,
Richmond 3121



**Telephone
email**

DX 106 Melbourne
(03) 8523 4601
gazette@ivegroup.com.au

Recommended Retail Price \$2.55 (includes GST)