



Victoria Government Gazette

No. S 51 Tuesday 14 February 2023
By Authority of Victorian Government Printer

Road Management Act 2004

ROAD DECLARATIONS

The Head, Transport for Victoria, pursuant to sections 11 and 14 of the **Road Management Act 2004**, upon publication of this notice declares and renames the roads described in the Schedule and on the plans attached.

The effects of these Road Declarations on road names are described in Table 1.

SCHEDULE

ARTERIAL ROAD

- a) Those parts of Geelong – Portarlington Road identified by hatching on the plans numbered GP23574, GP23575, GP23576, GP23577, GP23580, GP23581, GP23582, GP23583 and GP23584 are declared or renamed as described in the legend in the said plans.
- b) Those parts of Drysdale – Ocean Grove Road identified by hatching or heavy solid line on the plans numbered GP23574, GP23575A, GP23584 and GP24567 are declared or renamed as described in the legend in the said plans.
- c) Those parts of Drysdale – St Leonards Road identified by hatching on the plans numbered GP23581 and GP23582 are declared as described in the legend in the said plans.

MUNICIPAL ROAD

- d) Those parts of Hackwill Place and Jetty Road identified by hatching on the plan numbered GP23574A are declared as described in the legend in the said plan.
- e) Those parts of McKiernan Street and Peninsula Drive identified by hatching on the plans numbered GP23575B and GP23576A are declared as described in the legend in the said plans.
- f) Those parts of Andersons Road and Princess Street identified by hatching on the plan numbered GP23577B are declared as described in the legend in the said plan.
- g) Those parts of Huntingdon Street and Waterson Place identified by hatching on the plan numbered GP23580A are declared as described in the legend in the said plan.
- h) That part of Kilby Court identified by hatching on the plan numbered GP23581B is declared as described in the legend in the said plan.
- i) That part of Clarendon Road identified by hatching on the plan numbered GP23581C is declared as described in the legend in the said plan.
- j) Those parts of Drakes Road and Redgum Place identified by hatching on the plan numbered GP23583A are declared as described in the legend in the said plan.
- k) Those parts of Whitcombes Road identified by hatching on the plan numbered GP23584A are declared as described in the legend in the said plan.

SPECIAL

TABLE 1

EFFECTS ON ROAD NAMES

1. Names in Column 2 are existing Vicmap Address names, which are unaffected by this notice.
2. **Names in Column 1 are for Department of Transport and Planning administrative purposes only and are independent of names in Column 2.**
3. Names in Column 2 may not apply to the whole length of the road and are for general information only.

ARTERIAL ROAD

GP Number	Department of Transport and Planning Administrative Road Name Column 1	Vicmap Address Road Name (for property addressing purposes) Column 2
GP23574 GP23575 GP23576 GP23577 GP23580 GP23581 GP23582 GP23583 GP23584	Geelong – Portarlington Road Note: Former administrative names (Drysdale – Ocean Grove Road and Drysdale – St Leonards Road) cease where renamed	Not detailed – Property addresses not affected
GP23574 GP23575A GP23584 GP24567	Drysdale – Ocean Grove Road Note: Former administrative name (Geelong – Portarlington Road) ceases where renamed	Not detailed – Property addresses not affected
GP23581 GP23582	Drysdale – St Leonards Road	Not detailed – Road boundary adjustments only

MUNICIPAL ROAD

GP Number	Department of Transport and Planning Administrative Road Name Column 1	Vicmap Address Road Name (for property addressing purposes) Column 2
GP23574A GP23575B GP23576A GP23577B GP23580A GP23581B GP23581C GP23583A GP23584A	Not applicable	Not detailed – Road boundary adjustments only

HEAD, TRANSPORT FOR VICTORIA
 ARTERIAL ROAD
 GEELONG - PORTARLINGTON ROAD
 DRYSDALE - OCEAN GROVE ROAD
 CITY OF GREATER GEELONG

NOTE:
 SEE TABLE 1 REGARDING ROAD NAMES.

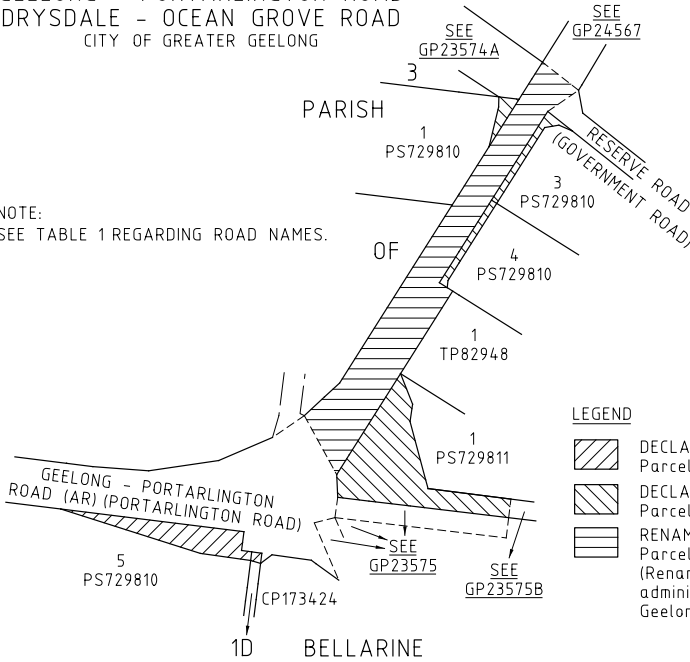

GP23574
 Compiled from
 SP23574C,
 SP23575C &
 VicMap Property
 (November 2021)

LEGEND

- DECLARE GEELONG - PORTARLINGTON ROAD
 Parcels 30 & 35 on SP23575C
- DECLARE DRYSDALE - OCEAN GROVE ROAD
 Parcels 1, 2, 14 & 15 on SP23574C
- RENAME DRYSDALE - OCEAN GROVE ROAD
 Parcel 6 on SP23574C
 (Renamed for Head, Transport for Victoria
 administrative purposes only) (Formerly
 Geelong - Portarlington Road)

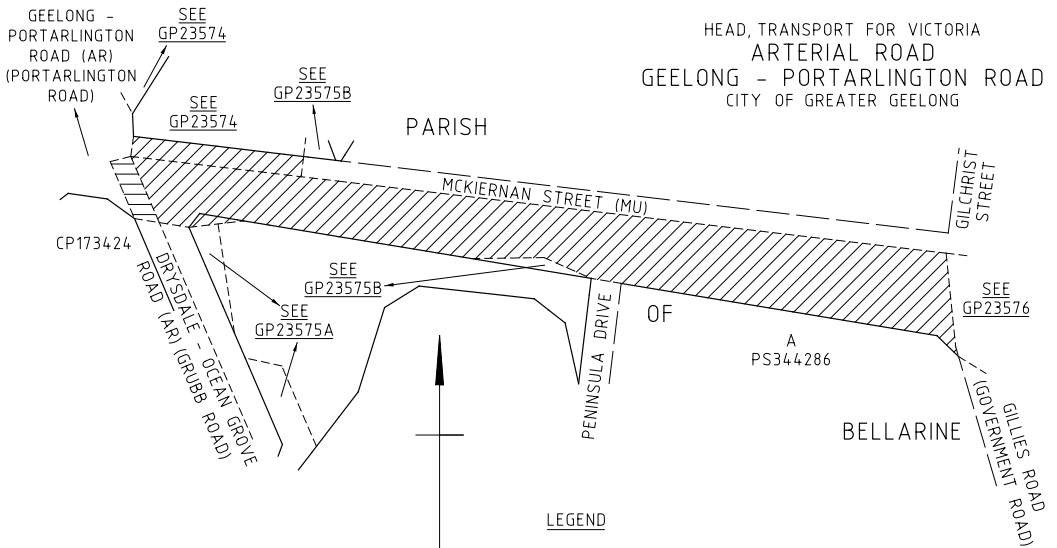

NOTE:
 SEE TABLE 1 REGARDING
 ROAD NAMES.

GP23575
 Compiled from
 SP23574C, SP23575C
 & Vicmap Property
 (November 2021)

LEGEND

- DECLARE GEELONG - PORTARLINGTON ROAD
 Parcels 31 & 40 on SP23575C
 Parcel 7 on SP23574C
- RENAME GEELONG - PORTARLINGTON ROAD
 Parcel 39 on SP23575C
 (Renamed for Head, Transport for Victoria
 administrative purposes only) (Formerly
 Drysdale - Ocean Grove Road)

HEAD, TRANSPORT FOR VICTORIA
 ARTERIAL ROAD
 GEELONG - PORTARLINGTON ROAD
 CITY OF GREATER GEELONG

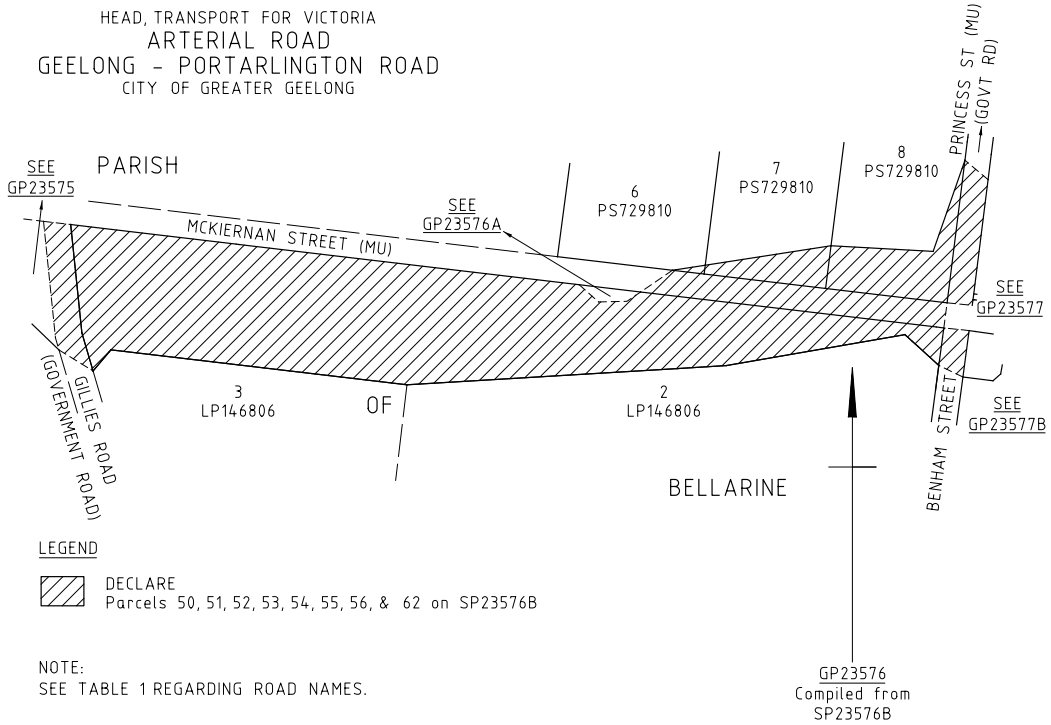

HEAD, TRANSPORT FOR VICTORIA
 ARTERIAL ROAD
 GEELONG - PORTARLINGTON ROAD
 CITY OF GREATER GEELONG

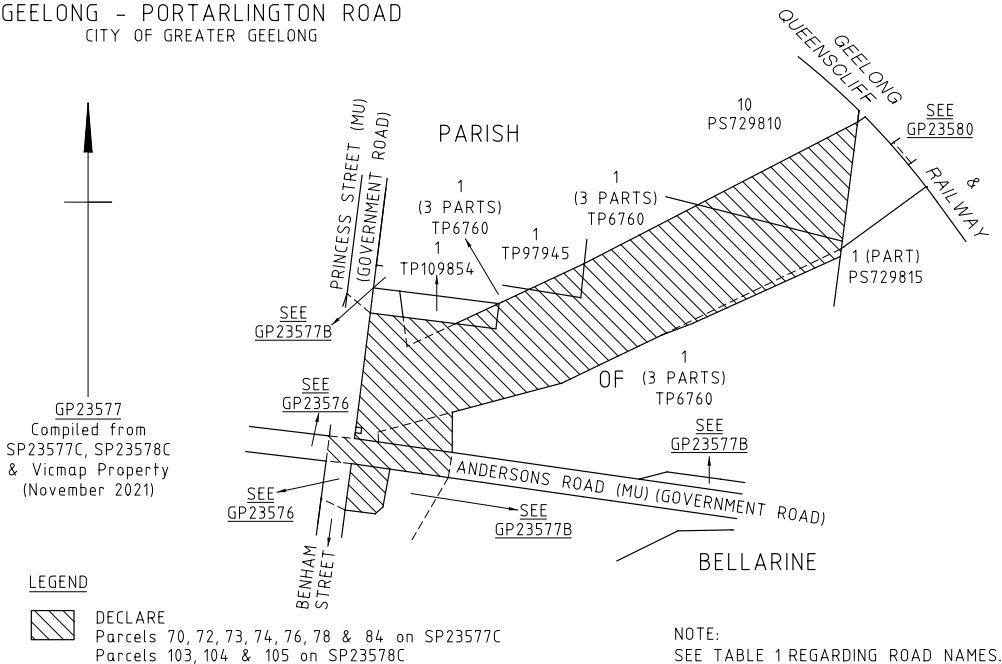

HEAD, TRANSPORT FOR VICTORIA
ARTERIAL ROAD
GEELONG - PORTARLINGTON ROAD
DRYSDALE - ST LEONARDS ROAD
CITY OF GREATER GEELONG

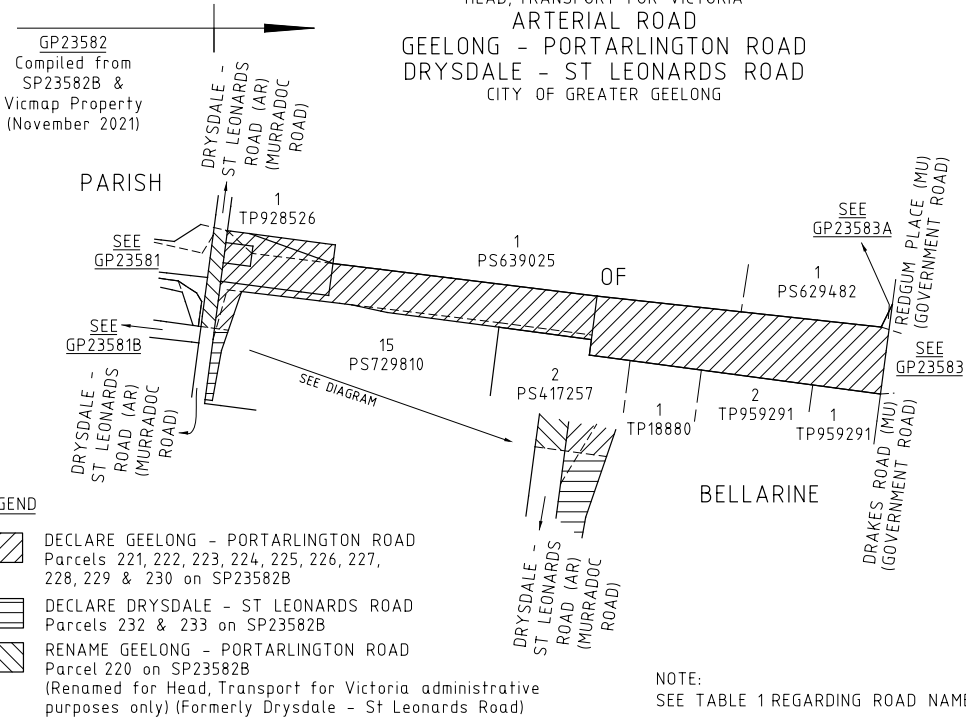

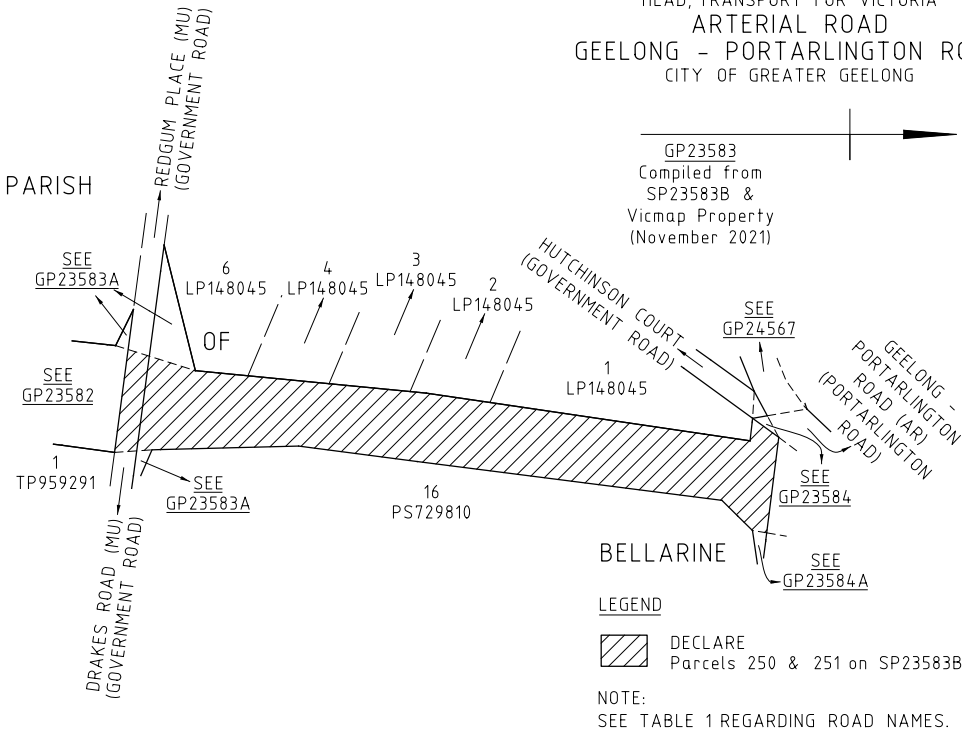

HEAD, TRANSPORT FOR VICTORIA
ARTERIAL ROAD
GEELONG - PORTARLINGTON ROAD
CITY OF GREATER GEELONG



HEAD, TRANSPORT FOR VICTORIA
 ARTERIAL ROAD
 GEELONG - PORTARLINGTON ROAD
 DRYSDALE - OCEAN GROVE ROAD
 CITY OF GREATER GEELONG

LEGEND

-  DECLARE GEELONG - PORTARLINGTON ROAD
 Parcels 272, 273, 276 & 277 on SP23584C
-  DECLARE DRYSDALE - OCEAN GROVE ROAD
 Parcel 285 on SP23584C

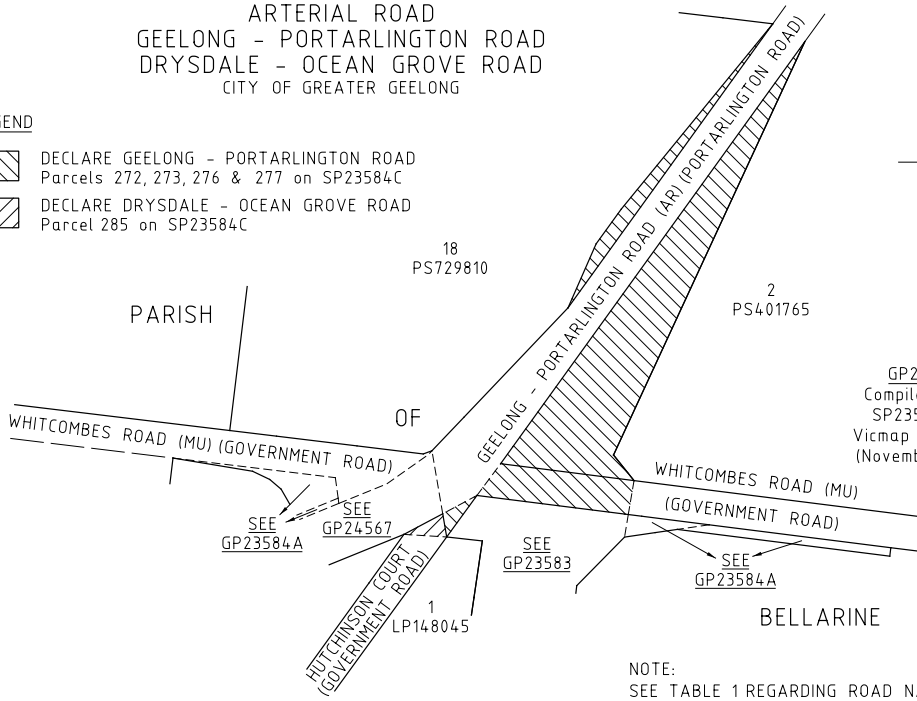

GP23584
 Compiled from
 SP23584C &
 Vicmap Property
 (November 2021)

NOTE:
 SEE TABLE 1 REGARDING ROAD NAMES.

HEAD, TRANSPORT FOR VICTORIA
 ARTERIAL ROAD
 DRYSDALE - OCEAN GROVE ROAD
 CITY OF GREATER GEELONG

LEGEND

-  DECLARE
 Parcels 33, 41 & 42 on SP23575C

NOTE:
 SEE TABLE 1 REGARDING ROAD NAMES.

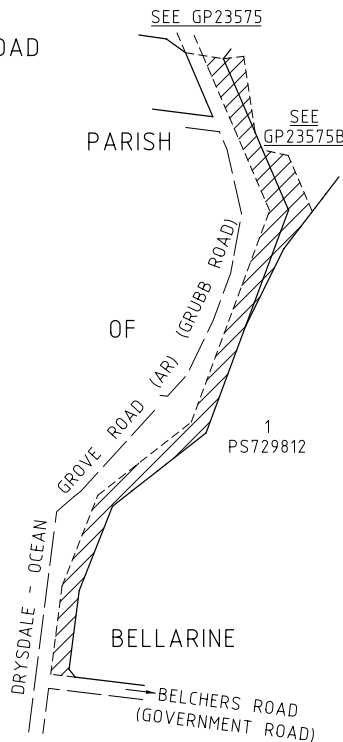

GP23575A
 Compiled from
 SP23575C &
 Vicmap Property
 (November 2021)

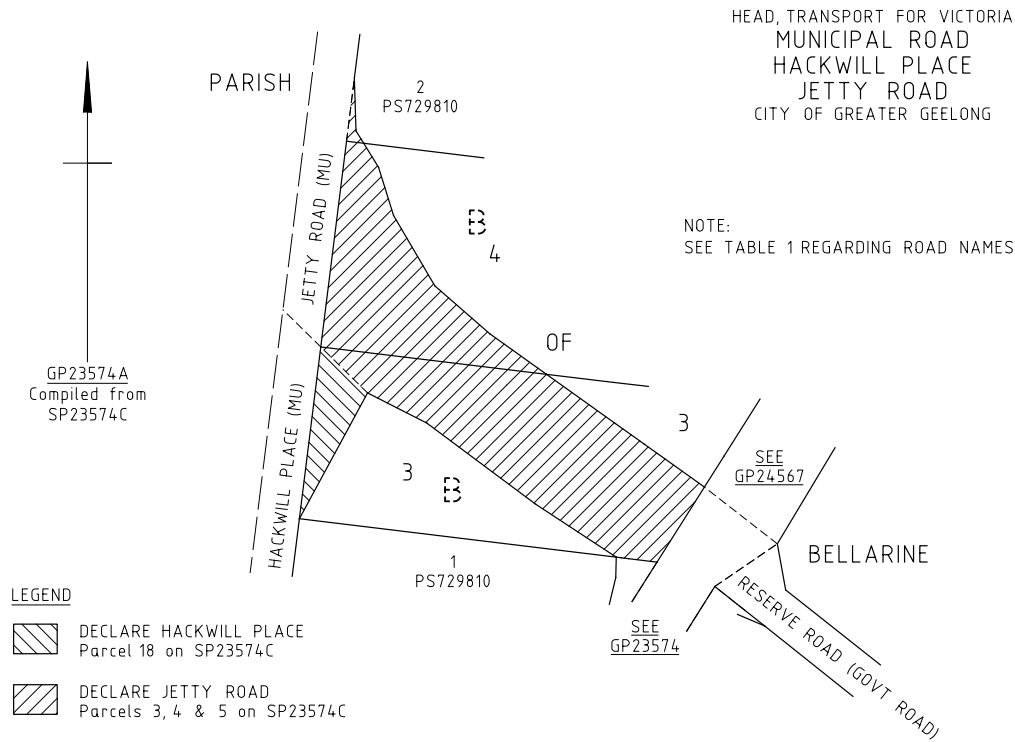
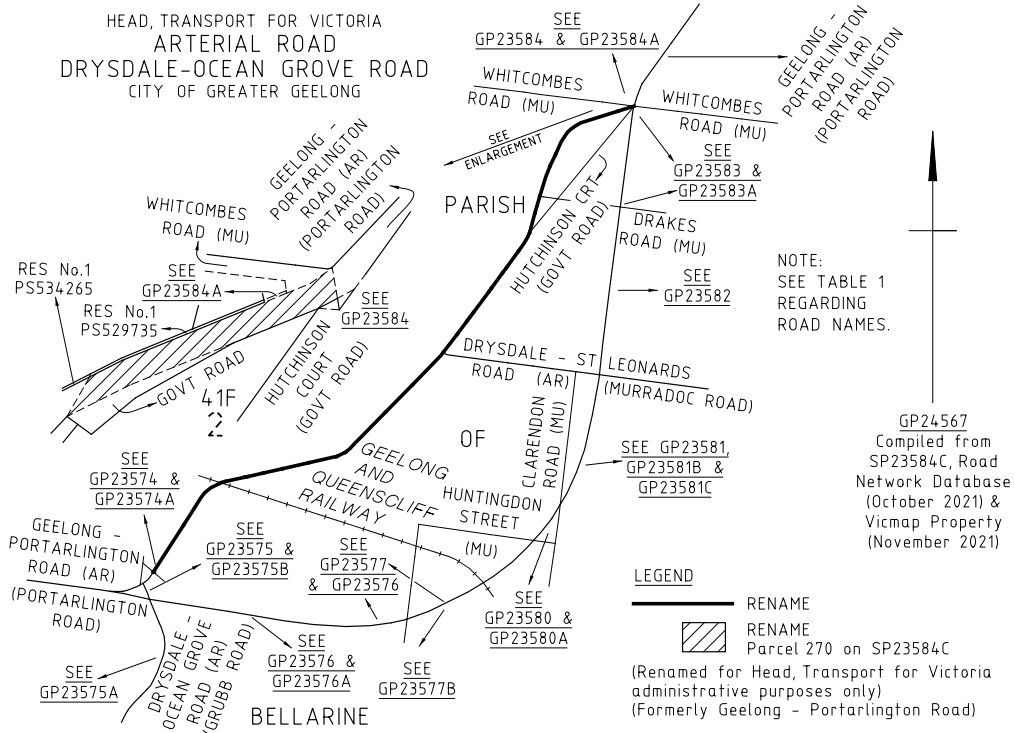

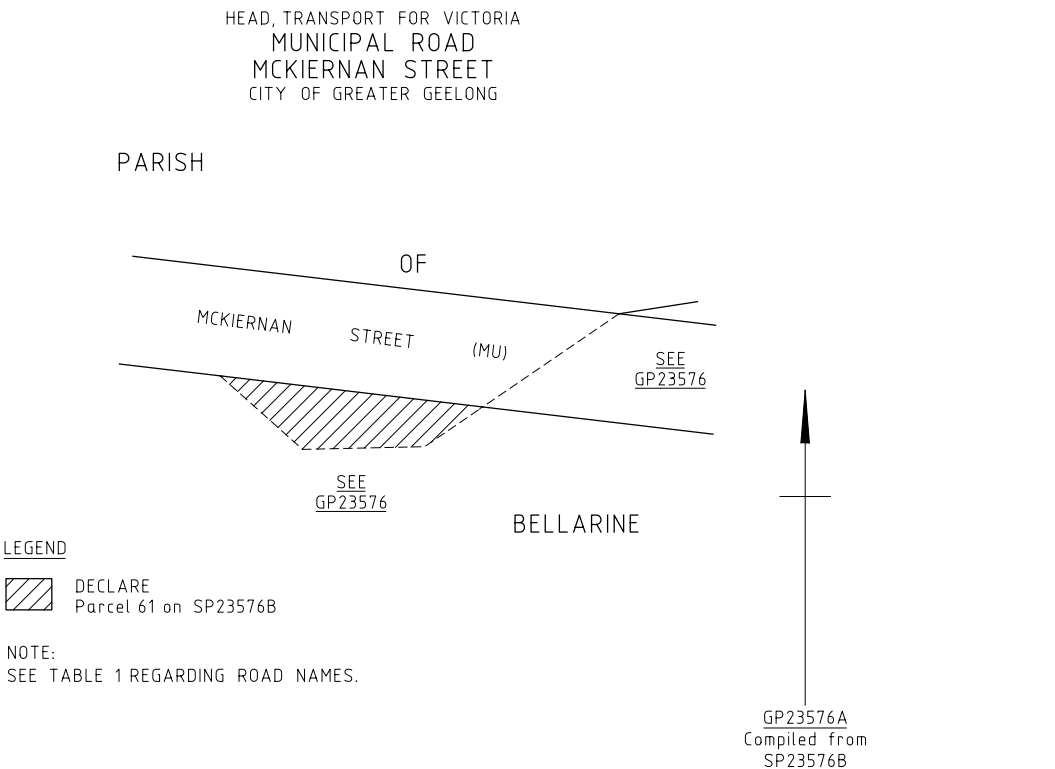
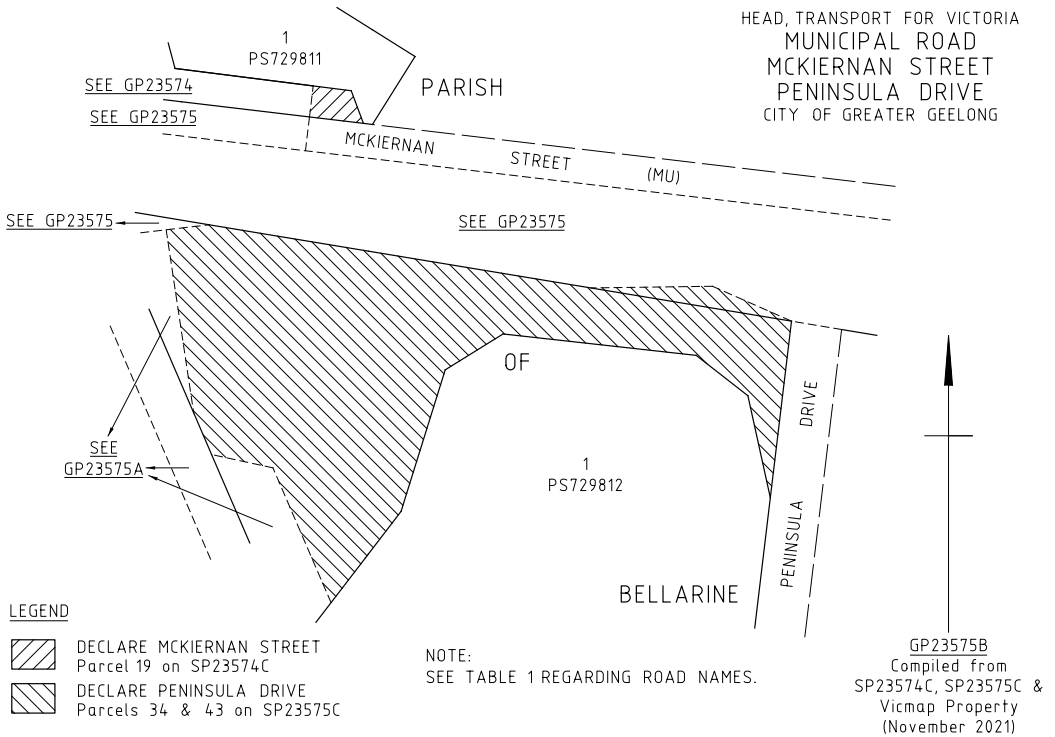

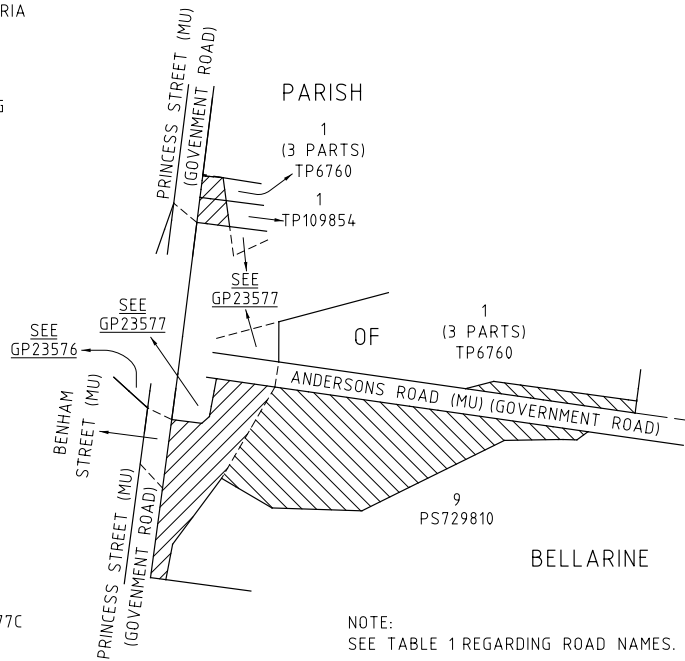

HEAD, TRANSPORT FOR VICTORIA
MUNICIPAL ROAD
ANDERSONS ROAD
PRINCESS STREET
CITY OF GREATER GEELONG

GP23577B
Compiled from
SP23577C &
SP23578C





LEGEND

-  DECLARE ANDERSONS ROAD
Parcels 75 & 77 on SP23577C
-  DECLARE PRINCESS STREET
Parcel 85 on SP23577C
Parcels 100 & 101 on SP23578C

NOTE:
SEE TABLE 1 REGARDING ROAD NAMES.

HEAD, TRANSPORT FOR VICTORIA
MUNICIPAL ROAD
HUNTINGDON STREET
WATERSON PLACE
CITY OF GREATER GEELONG

LEGEND

-  DECLARE HUNTINGDON STREET
Parcel 161 & 161A on SP23580C
-  DECLARE WATERSON PLACE
Parcel 170 on SP23580C

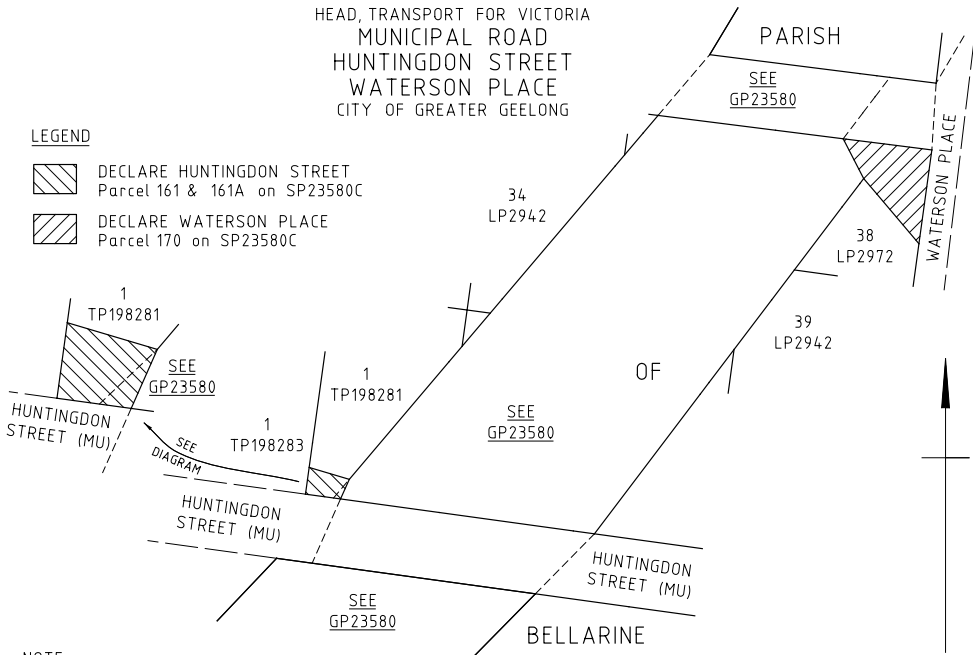

NOTE:
SEE TABLE 1 REGARDING ROAD NAMES.

GP23580A
Compiled from
SP23580C

HEAD, TRANSPORT FOR VICTORIA
MUNICIPAL ROAD
KILBY COURT
CITY OF GREATER GEELONG

GP23581B
Compiled from
SP23581C

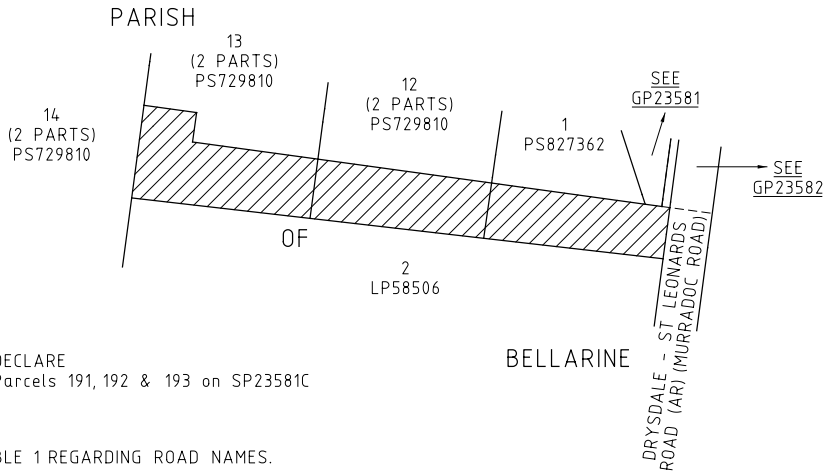

HEAD, TRANSPORT FOR VICTORIA
MUNICIPAL ROAD
CLARENDON ROAD
CITY OF GREATER GEELONG

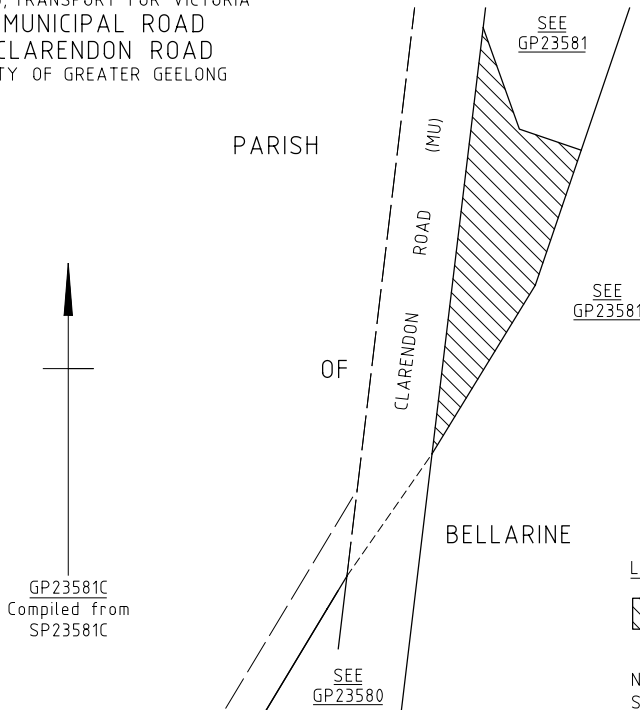

HEAD, TRANSPORT FOR VICTORIA
MUNICIPAL ROAD
DRAKES ROAD
REDDUM PLACE
CITY OF GREATER GEELONG

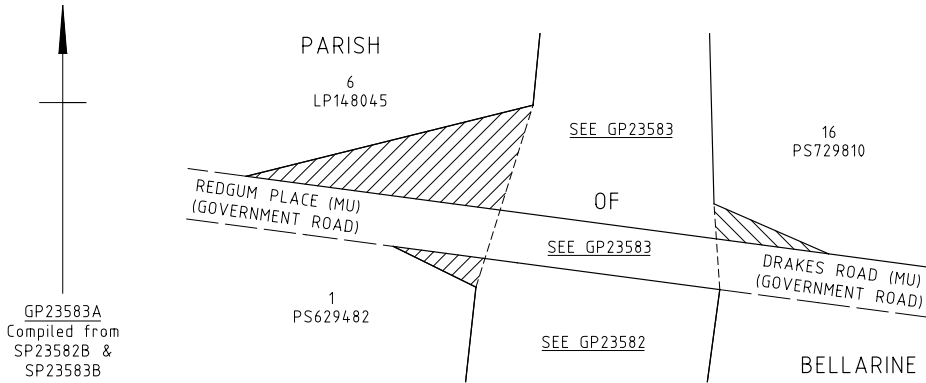

LEGEND

- DECLARE DRAKES ROAD
Parcel 257 on SP23583B
- DECLARE REDGUM PLACE
Parcel 256 on SP23583B
Parcel 234 on SP23582B

NOTE:
SEE TABLE 1 REGARDING ROAD NAMES.

HEAD, TRANSPORT FOR VICTORIA
MUNICIPAL ROAD
WHITCOMBES ROAD
CITY OF GREATER GEELONG

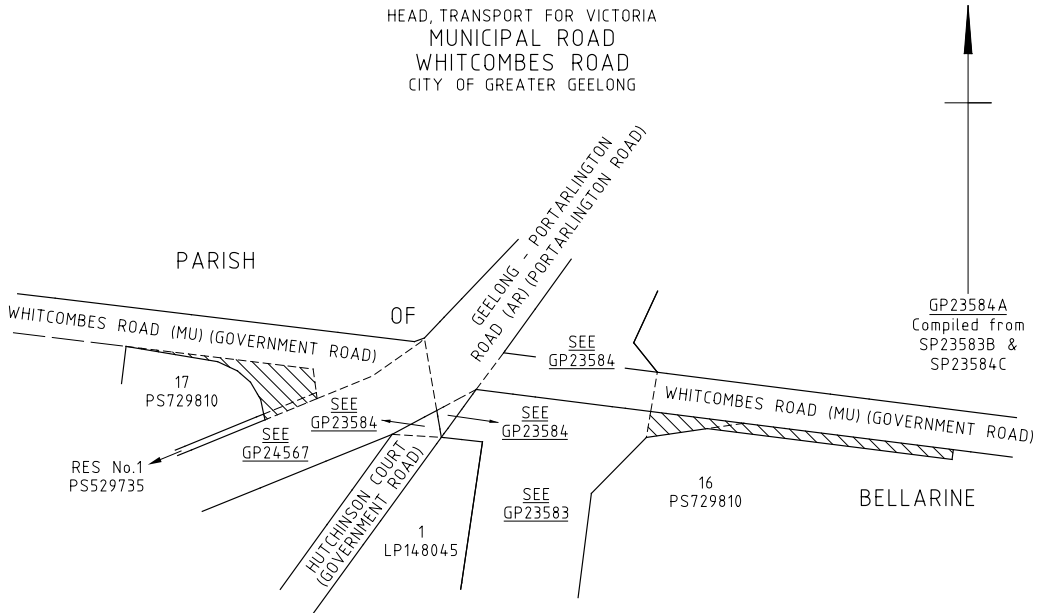

LEGEND

- DECLARE
Parcels 254 & 258 on SP23583B
Parcels 274 & 275 on SP23584C

NOTE:
SEE TABLE 1 REGARDING ROAD NAMES.

Dated 6 February 2023

EVA WINTERSBERGER
Acting Executive Director – Transport Assets
Department of Transport and Planning

This page was left blank intentionally

This page was left blank intentionally

This page was left blank intentionally

ive

The *Victoria Government Gazette* is published by IVE Group Limited with the authority of the Government Printer for the State of Victoria

© State of Victoria 2023

This publication is copyright. No part may be reproduced by any process except in accordance with the provisions of the Copyright Act.

Address all enquiries to the Government Printer for the State of Victoria
Level 2, 1 Macarthur Street
Melbourne 3002
Victoria Australia

How To Order



**Retail &
Mail Sales**

Victoria Government Gazette
Ground Floor, Building 8,
658 Church Street,
Richmond 3121



Telephone

(03) 8523 4601

email

gazette@ivegroup.com.au

Price Code A